

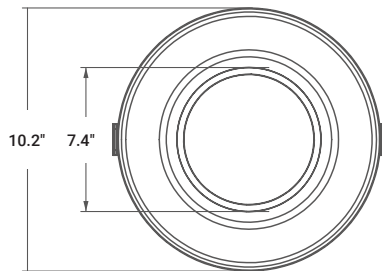

**MULTILUMEN
SELECTOR**

**EASY 5 COLORS
SELECCTOR**
2700K • 3000K • 3500K • 4000K • 5000K

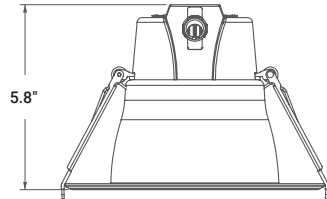

NOMINAL LUMENS	DELIVERED LUMENS	WATTAGE
2500	2500	24W
1500	1500	15W
1000	1000	10W

Based on 4000K, 90+ CRI. Actual wattage may vary +/- 5%

NOMINAL LUMENS	DELIVERED LUMENS	WATTAGE
5000	5000	52W
4000	4000	42W
3500	3500	32W

Based on 4000K, 90+ CRI. Actual wattage may vary +/- 5%

INSTALLATION

Cut hole in ceiling. Insert luminaire into opening by squeezing spring clips on both sides of luminaire.

You **MUST** seal all gaps between the ceiling and fixture with weatherproof silicone sealant. This deters moisture and water from damaging fixtures and other mechanical ceiling elements.

FEATURES

8" round baffle multi-CCT LED "Canless Downlight" engineered for new construction, remodel, or retrofit to accommodate insulated or dropped ceilings. Easily access field-adjustable 3 lumen output and 5-Color SeleCCTor switch by lowering the luminaire from the opening. Recessed housing not required, especially with limited plenum applications. Remote driver allows easy installation and maintenance. Small aperture and shallow depth are ideal for unlimited applications.

LUMENS	1000/1500/2500L 3500/4000/5000L
CCT	27K/30K/35K/40K/50K
CRI	90+
COLOR QUALITY	3-Step MacAdam Ellipse
CONSTRUCTION	Aluminum die-cast body and trim
TRIM OPTION	Round Baffle
TRIM COLORS	WH (White)
DIMMING	DIM10 (0-10V)
EMERGENCY	16W high voltage inverter (remote)
LIFETIME	L70 at 50,000 Hours
PHOTOMETRIC TEST	In Accordance with IES LM79-08, LM80 and TM-30, TM-21

- IC-rated and Air-Tight ready and may be in direct contact with insulation.
- Can be installed in shallow plenum spaces.
- May be installed in drywall or suspended ceilings.
- Flicker-free 120V forward-phase dimming down to 5%.
- Even illumination achieved with patent-pending optics and edge-lit LED technology.
- Ideal where ceiling or top access is unavailable.



TRIM

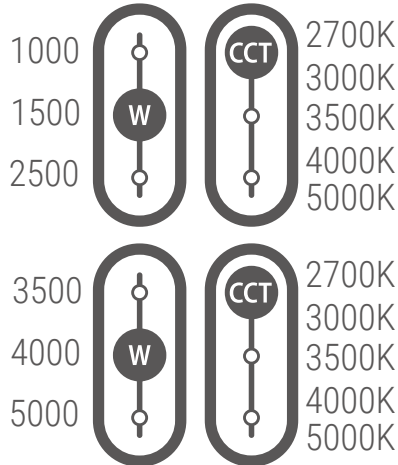

EXAMPLE:
RL843-1000/1500/2500L-DIM10-MVOLT-27K/30K/35K/40K/50K-90-WH

TYPE	LUMEN	CCT	CRI	FINISH
RL843	<input type="checkbox"/> 1000/1500/2500L-DIM10-MVOLT	<input type="checkbox"/> 27K/30K/35K/40K/50K	<input type="checkbox"/> 90+	<input type="checkbox"/> WH - White
	<input type="checkbox"/> 3500/4000/5000L-DIM10-MVOLT			

ACCESSORIES

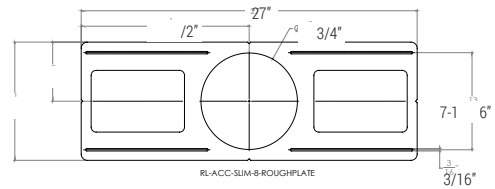

RL-ACC-SLIM-8-ROUGHPLATE
Rough-in plate for use with 8" downlights

RL-ACC-SLIM-1-10F

OPTIONS
<input type="checkbox"/> RL-ACC-SLIM-8-ROUGHPLATE - 8" Mounting Plate