

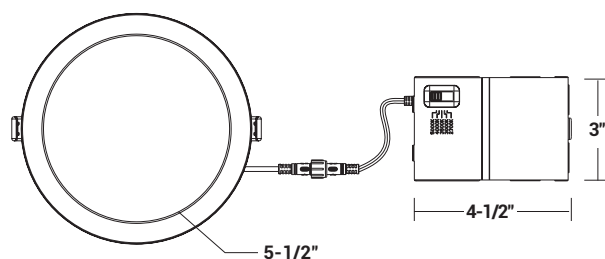

EASY 5 COLORS
SELECTOR
2700K • 3000K • 3500K • 4000K • 5000K

DIMENSIONS

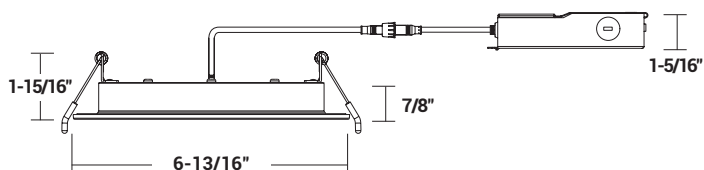

Recommended Hole Cut-out Size: 6-1/8"

NOMINAL LUMENS	DELIVERED LUMENS	WATTAGE
1200L	1265L	13W

Based on 4000K, 90+ CRI. Actual wattage may vary +/- 5%

INSTALLATION

Cut hole in ceiling. Insert luminaire into opening by squeezing spring clips on both sides of luminaire. The width in ceiling needed for the driver to fit is 3".

For wet location application, you **MUST** seal all gaps between the ceiling and fixture with weatherproof silicone sealant. This deters moisture and water from damaging fixtures and other mechanical ceiling elements. Installation hole size: 6-1/8"

FEATURES

PROMOTING CALM AND AMBIANCE IN THE MODERN HOME

These innovative canless downlights combine the convenience of a sleek, modern downlight with the utility of an integrated night light that provides a rich, warm glow to promote rest and relaxation. TRIAC dimmable and selectable CCT allow for variety in ambiance in chosen spaces. Ideal for bedrooms, bathrooms, hallways and similar applications in residential spaces. Shallow plenum space friendly. No housing required.

LUMENS	1200L, Night Light Mode: 35L
CCT	27K/30K/35K/40K/50K
CRI	90+ Standard
COLOR QUALITY	4-Step MacAdam Ellipse
MOUNTING	Recessed
DIMMING	DIMTR - 5% TRIAC dimming at 120V
TRIM COLORS	White (WH) Standard only
WORKING TEMP.	-20°C (-4°F) to 40°C (104°F)
DISTRIBUTION	Very Wide (110°, VWD)
VOLTAGE	120V
LIFETIME	L70 at 50,000 Hours
PHOTOMETRIC	In accordance with IES LM79-08, LM80 and TM-30, TM-21

- Small aperture and shallow depth allow for unlimited applications.
- Wet location suitable.
- Airtight and IC rated for direct contact with insulation.
- Remote driver; no housing or jbox necessary.



OPTICS

Features a frosted polycarbonate lens for optimal beam diffusion and glare-free illumination.

Built with ultra efficient, ultra bright SMD LEDs for optimal energy and cost efficiency.

Integrated ON/OFF night light function allows for a gentle, warm and comforting illumination suitable for after hours and non-disruptive of circadian rhythms.

Light mode can be easily switched between regular and night light by toggling a flip switch from OFF/ON within 3 seconds.

Up to 1200L output in downlight mode, at 13W. Night light mode operates at 2000K at 4W.

CONSTRUCTION

Body made from durable steel. Pre-installed spring clips allow for quick, easy recessed installation.

CCT switch located on driver.

MAINTENANCE

Fixture can be wiped down with a dry or damp cloth for optimal performance.

MOUNTING & INSTALLATION

Suitable for recessed mounting without any additional housing unit. Cut out hole size is 6 1/8".

OPTIONS & ACCESSORIES

Available to order separately:

Extension cable options:

- RL-ACC-SLIM-1-10F (10-ft)
- RL-ACC-SLIM-1-20F (20-ft)

Rough Plate options:

- RL-UNV-4/5/6 for use with 4", 5", and 6" downlights.
- RL-UNV-1/2/3/4/5/6/8/10 - Universal Mounting Plate for 1", 2", 3", 4", 5", 6", 8" and 10" downlights
- AL-ACC-SLIM-6-F-ROUGHPLATE for use with 6" downlights
- RL-ACC-SLIM-6-ROUGHPLATE for use with 6" downlights

See order chart for details.

DRIVER & ELECTRICAL INFORMATION

Powered by high-quality constant-current LED drivers which are rated for 50 to 60Hz at 120V input, produce less than 20% THD, and have a power factor of .90 to 1.00.

DIMMING

DIMTR - 5% TRIAC dimming at 120V.

WARRANTY

5-year warranty for parts and components (labor not included).

LISTINGS

ETL listed.
Energy Star certified.
Wet location suitable.
IC rated, air-tight, and ready to be in contact with insulation.
JA8 and Title 24 Compliant.

MULTI-CCT SWITCH

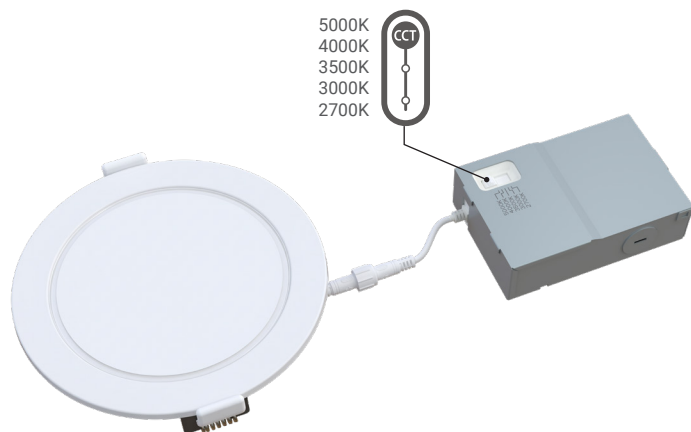

LIGHT MODE

DOWNLIGHT



5 CCT

NIGHT LIGHT



2000K

ACCESSORIES

RL-ACC-SLIM-1-10F

10-ft long extension

RL-ACC-SLIM-1-20F

20-ft long extension



RL-ACC-SLIM-6-ROUGHPLATE

For 6" downlights

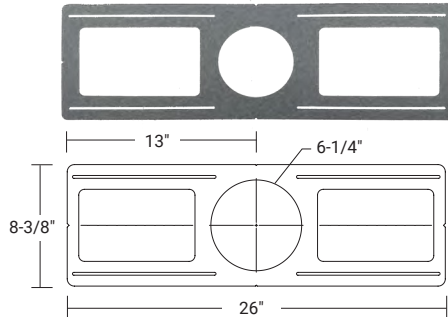

RL-UNV-1/2/3/4/5/6/8/10

For use with 1", 2", 3", 4", 5", 6", 8", and 10" downlights

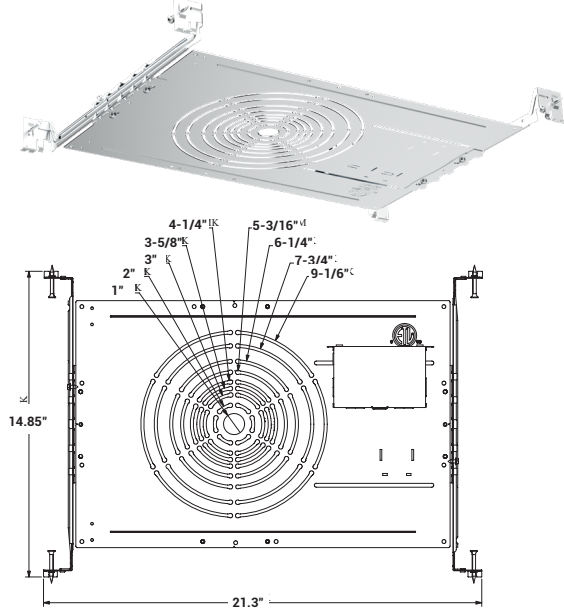

RL-UNV-4/5/6

For use with 4", 5", and 6" downlights

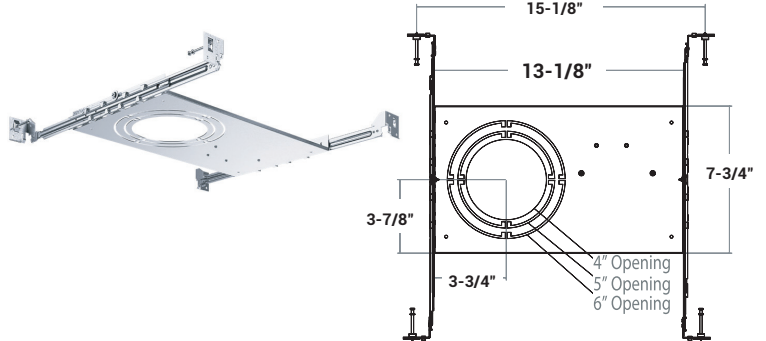

AL-ACC-SLIM-6-F-ROUGHPLATE

For 6" downlights

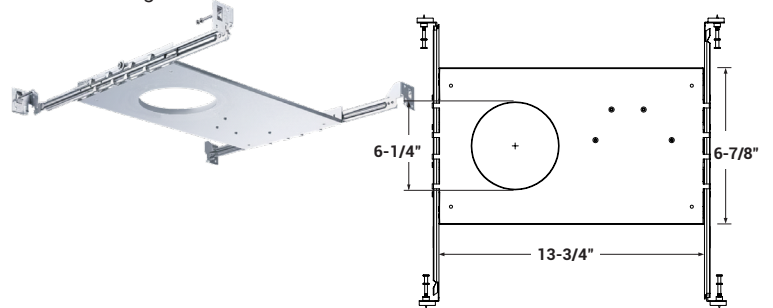

Example: **RL688-INL-1200L-DIMTR-120-27K/30K/35K/40K/50K-90-WH**

SERIES	LUMENS	DIMMING	CCT	CRI	FINISH	OPTION/ACCESSORIES
RL688-INL	1200L	DIMTR/120 - Triac	27K/30K/35K/40K/50K	90	WH - White	RL-ACC-SLIM-1-10F - 10-ft long extension RL-ACC-SLIM-1-20F - 20-ft long extension RL-UNV-4/5/6 - Universal Mounting Plate for 4", 5" and 6" RL-UNV-1/2/3/4/5/6/8/10 - Universal Mounting Plate for 1", 2", 3", 4", 5", 6", 8" and 10" AL-ACC-SLIM-6-F-ROUGHPLATE - 6" Flanged Roughplate RL-ACC-SLIM-6-ROUGHPLATE - 6" Mounting Plate

RL688-INL-1200L-DIMTR-120-27K-30K-35K-40K-50K-90-WH

TEST NO.: **EL08192434**

INPUT WATTS: **12.7**

LUMENS: **1265**

EFFICACY: **100**

BEAM ANGLE: **106**

SPACING CRITERIA: **1.19**

CANDELA DISTRIBUTION

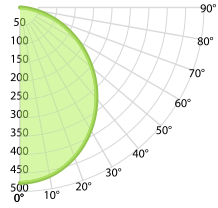

CANDELA TABLE

	0°	90°
0°	477	477
10°	465	467
20°	433	439
30°	384	392
40°	323	333
50°	255	266
60°	182	193
70°	108	118
80°	41	49
90°	0	0

LUMINANCE (cd/sq.m)

	0.00°	90.00°
0.00°	26122	26122
45.00°	22456	23302
55.00°	20895	21969
65.00°	18757	20216
75.00°	15462	17353
85.00°	8749	12473

LUMENS PER ZONE

ZONE	LUMENS
0° - 10°	48
10° - 20°	127
20° - 30°	189
30° - 40°	223
40° - 50°	226
50° - 60°	199
60° - 70°	148
70° - 80°	83
80° - 90°	22

ZONAL LUMEN SUMMARY

ZONE	LUMENS	% LUMINAIRE
0° - 20°	175	14%
0° - 30°	364	29%
0° - 40°	587	46%
0° - 60°	1012	80%
0° - 80°	1243	98%
0° - 90°	1264	100%

CONE OF LIGHT

MOUNTING HEIGHT	FC AT BEAM CENTER	BEAM DIA. 0° -180°	BEAM DIA. 90° -270°
6.0 ft	13.2 fc	15.9 ft	15.9 ft
8.0 ft	7.4 fc	21.2 ft	21.2 ft
10.0 ft	4.8 fc	26.5 ft	26.5 ft
12.0 ft	3.3 fc	31.8 ft	31.8 ft
14.0 ft	2.4 fc	37.1 ft	37.0 ft
16.0 ft	1.9 fc	42.4 ft	42.3 ft
18.0 ft	1.5 fc	47.7 ft	47.6 ft
20.0 ft	1.2 fc	53.0 ft	52.9 ft

INDOOR COEFFICIENTS OF UTILIZATION

pf	20%																10%				0%			
	pc	70%	50%	30%	10%	70%	50%	30%	10%	50%	30%	10%	50%	30%	10%	30%	10%	50%	30%	10%	0%	0%	0%	0%
0	119	119	119	119	116	116	116	116	111	111	111	106	106	106	102	102	102	102	102	102	100	0%	0%	0%
1	109	104	100	96	106	102	98	95	98	95	92	94	91	89	90	88	86	86	86	84	84	84	84	84
2	99	91	84	79	97	89	83	78	86	80	76	82	78	74	79	76	73	73	73	70	70	70	70	70
3	91	80	72	66	88	79	71	65	76	69	64	73	67	63	70	66	62	62	60	60	60	60	60	60
4	83	71	62	56	81	70	62	55	67	60	55	65	59	54	63	58	53	53	51	51	51	51	51	51
5	76	64	55	48	74	63	54	48	60	53	47	58	52	47	57	51	46	46	44	44	44	44	44	44
6	71	57	49	42	69	56	48	42	55	47	42	53	46	41	51	46	41	39	39	39	39	39	39	39
7	66	52	43	37	64	51	43	37	50	42	37	48	42	37	47	41	36	34	34	34	34	34	34	34
8	61	48	39	33	60	47	39	33	46	38	33	44	38	33	43	37	33	31	31	31	31	31	31	31
9	57	44	36	30	56	43	35	30	42	35	30	41	34	30	40	34	30	28	28	28	28	28	28	28
10	54	40	33	27	52	40	32	27	39	32	27	38	32	27	37	31	27	25	25	25	25	25	25	25