

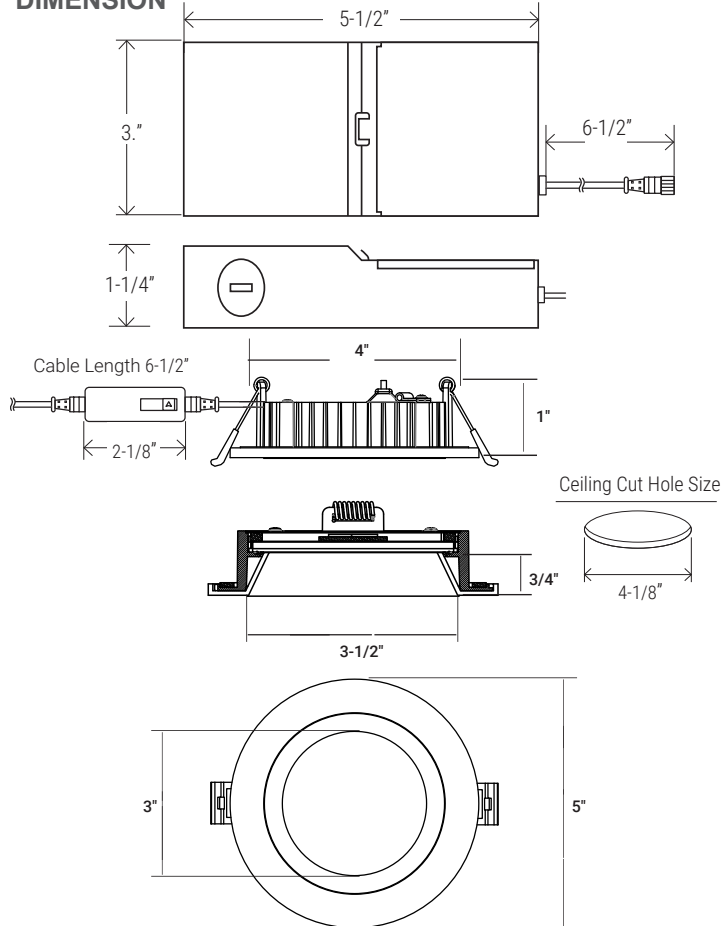

EASY 5 COLORS
SELECTOR
2700K • 3000K • 3500K • 4000K • 5000K



DIMENSION



NOMINAL LUMENS	DELIVERED LUMENS	WATTAGE
800	726	11W

Based on 4000K, 90+ CRI. Actual wattage may vary +/- 5%

INSTALLATION

Cut hole in ceiling Insert luminaire into opening by squeezing spring clips on both sides of luminaire. The width ceiling needed for the driver to fit the 3"

You MUST seal all gaps between the ceiling and fixture with weatherproof silicone sealant. This deters moisture and water from damaging fixtures and other mechanical ceiling elements.

FEATURES

4" Anti-Glare Downlight with Interchangeable Trims and 5 CCT Selector. Experience unmatched comfort with anti-glare technology, while effortlessly customizing its appearance with interchangeable trims. The 5 CCT Selector lets you create the perfect ambiance with adjustable color temperatures. Crafted with premium materials for durability, this energy-efficient downlight suits various spaces, from residential to commercial.

LUMENS	800
CCT	27K/30K/35K/40K/50K
CRI	90+
COLOR QUALITY	3-Step MacAdam Ellipse
CONSTRUCTION	Aluminum die-cast body and trim
TRIM OPTION	Round Baffle
TRIM COLORS	Trim Color: WH-white, BK-black, SN-Satin nickel
DIMMING	DIMTR- Triac Dimming
EMERGENCY	16W high voltage inverter (remote)
LIFETIME	L70 at 50,000 Hours
PHOTOMETRIC TEST	In Accordance with IES LM79-08, LM80 and TM-30, TM-21

- LED 4" durable airtight aluminum body.
- Wet location rated
- UV stable paint and white F1-rated diffuser lens suitable for outdoor.
- Includes different interchangeable twist-and-lock trims for low-glare.
- New construction, remodel, or retrofit to accommodate insulated ceiling.
- Recessed housing not required, especially with limited plenum applications.
- Easily access field-adjustable 5-Color Select CCT.
- Remote driver allows easy installation and maintenance.
- Junction box with commercial grade driver included
- Plenum rated cable and off-board LED isolated driver which compliance with Class 2.
- Triac dimmable down to 10% using standard LED Dimmers.
- Energy Star rated, JA8, ETL, FCC Part15B compliance and wet location, Type-IC rated. Airtight.
- Lifetime rated for over 50000hrs
- Operation temperature: -20°C to +45°C



TRIM

TRIM COLORS

ACCESSORIES



RL480-RT-BK
BLACK



RL480-RT-SN
SATIN NICKEL



RL-ACC-SLIM-1-10F
10-ft long extension



RL-ACC-SLIM-1-20F
20-ft long extension

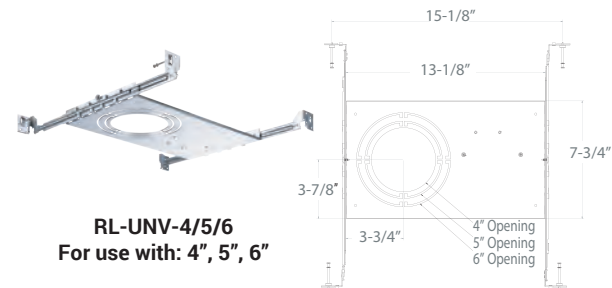

RL-UNV-4/5/6
For use with: 4", 5", 6"

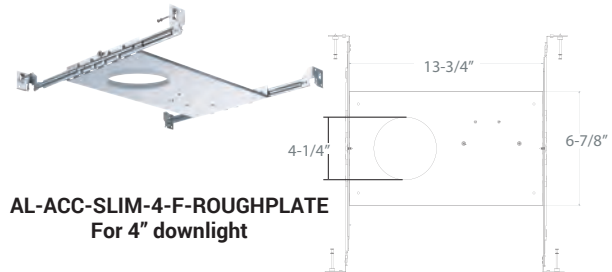

AL-ACC-SLIM-4-F-ROUGHPLATE
For 4" downlight

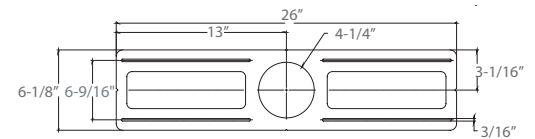

RL-ACC-SLIM-4-ROUGHPLATE
Rough-in plate for use with 4" downlights

EXAMPLE:
RL480-800L-DIMTR-120-27K/30K/35K/40K/50K-90-W-WH

TYPE	LUMEN	CCT	CRI	FINISH
RL480	800L-DIMTR-120	27K/30K/35K/40K/50K	90+	W-WH - White

EXAMPLE:
RL480-RT-BK

ACCESSORIES
<input type="checkbox"/> RL480-RT-BK-Black <input type="checkbox"/> RL480-RT-SN-Satin Nickel

RL-ACC-SLIM-1-10F

OPTIONS
<input type="checkbox"/> RL-ACC-SLIM-1-10F - 10ft Long Extension <input type="checkbox"/> RL-ACC-SLIM-1-20F - 20ft Long Extension <input type="checkbox"/> RL-UNV-4/5/6 - Universal Mounting Plate for 4", 5" and 6" <input type="checkbox"/> RL-ACC-SLIM-4-ROUGHPLATE - 4" Mounting Plate <input type="checkbox"/> AL-ACC-SLIM-4-F-ROUGHPLATE - 4" Flanged Roughplate

RL480-800L-DIMTR-120-27K-30K-35K-40K-50K-90-W-WH

TEST NO.: **EL08232343**

INPUT WATTS: **10.9**

LUMENS: **726**

EFFICACY: **67**

BEAM ANGLE: **102**

SPACING CRITERIA: **1.20**

CANDELA DISTRIBUTION

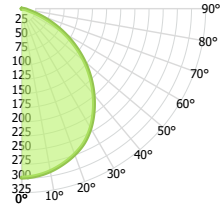

CANDELA TABLE

	0°	90°
0°	299	301
10°	291	298
20°	274	284
30°	243	260
40°	197	217
50°	145	163
60°	87	103
70°	32	45
80°	7	10
90°	0	0

LUMINANCE (cd/sq.m)

	0.00°	90.00°
0.00°	25571	25762
45.00°	20800	23211
55.00°	17305	19893
65.00°	11725	14826
75.00°	4326	7102
85.00°	757	2565

LUMENS PER ZONE

ZONE	LUMENS
0° - 10°	30
10° - 20°	81
20° - 30°	123
30° - 40°	144
40° - 50°	140
50° - 60°	113
60° - 70°	68
70° - 80°	23
80° - 90°	4

ZONAL LUMEN SUMMARY

ZONE	UMENS	% LUMINAIRE
0° - 20°	111	15%
0° - 30°	234	32%
0° - 40°	378	52%
0° - 60°	631	87%
0° - 80°	722	99%
0° - 90°	726	100%

CONE OF LIGHT

MOUNTING HEIGHT	FC AT BEAM CENTER	BEAM DIA. 0°-180°	BEAM DIA. 90°-270°
6.0 ft	8.3 fc	14.8 ft	14.9 ft
8.0 ft	4.7 fc	19.8 ft	19.8 ft
10.0 ft	3.0 fc	24.7 ft	24.8 ft
12.0 ft	2.1 fc	29.7 ft	29.7 ft
14.0 ft	1.5 fc	34.6 ft	34.7 ft
16.0 ft	1.2 fc	39.6 ft	39.7 ft
18.0 ft	0.9 fc	44.5 ft	44.6 ft
20.0 ft	0.7 fc	49.4 ft	49.6 ft

INDOOR COEFFICIENTS OF UTILIZATION

pf	20%																0%	
	pc	80%				70%				50%				30%				0%
pw	70%	50%	30%	10%	70%	50%	30%	10%	50%	30%	10%	50%	30%	10%	50%	30%	10%	0%
0	119	119	119	119	116	116	116	116	111	111	111	106	106	106	102	102	102	100
1	110	106	102	99	108	104	101	98	100	97	94	96	94	92	92	91	89	87
2	101	94	88	83	99	92	87	82	89	84	80	85	82	78	82	79	76	74
3	93	83	76	70	91	82	75	69	79	73	68	76	71	67	74	70	66	64
4	86	74	66	60	83	73	66	60	71	64	59	68	63	58	66	61	57	55
5	79	67	59	52	77	66	58	52	64	57	51	62	56	51	60	55	50	48
6	73	61	52	46	71	60	52	46	58	51	45	56	50	45	55	49	45	43
7	68	55	47	41	66	54	46	41	53	46	40	51	45	40	50	44	40	38
8	63	50	42	37	62	50	42	37	48	41	36	47	41	36	46	40	36	34
9	59	46	38	33	58	46	38	33	45	38	33	44	37	33	43	37	33	31
10	56	43	35	30	54	42	35	30	41	35	30	40	34	30	40	34	30	28