

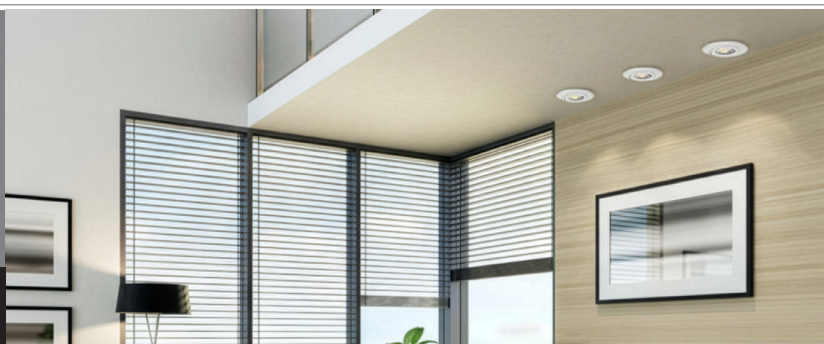

EASY 5 COLORS
SELECCTOR
2700K • 3000K • 3500K • 4000K • 5000K

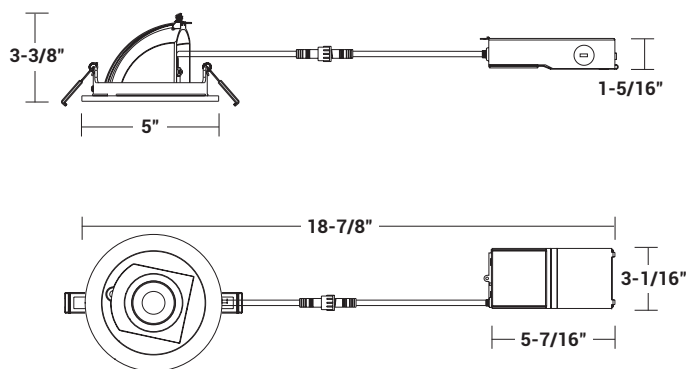

DIMENSIONS



Recommended Hole Cut-out Size: 4-1/4"

NOMINAL LUMENS	DELIVERED LUMENS	WATTAGE
750L	950L	9W

Based on 4000K, 90+ CRI. Actual wattage may vary +/- 5%

INSTALLATION

Cut hole in ceiling. Insert luminaire into opening by squeezing spring clips on both sides of luminaire. The width in ceiling needed for the driver to fit is 3".

For wet location application, you **MUST** seal all gaps between the ceiling and fixture with weatherproof silicone sealant. This deters moisture and water from damaging fixtures and other mechanical ceiling elements. Installation hole size: 4-1/4"

FEATURES

VERSATILE, DIRECTIONAL ILLUMINATION

This 4" adjustable elbow features a slim profile and a pull down 70° tilt and 360° rotation for versatile, directional illumination. Easily accessible multi-CCT options allow for different warm to cool atmospheres, while a remote driver allows for easy maintenance and installation. Engineered for new construction, remodel, or retrofit applications, it can accommodate insulated or dropped ceilings. Ideal for remodel and new construction applications in commercial, retail, residential, and hospitality spaces that benefit from adjustable, directional, or accent lighting.

Damp location rated. IC rated, airtight, and ready for contact with insulation. No recessed housing required, especially with limited plenum applications.

LUMENS	750L
CCT	27K/30K/35K/40K/50K
CRI	90+ Standard
COLOR QUALITY	3-Step MacAdam Ellipse
MOUNTING	Recessed
DIMMING	DIMTR - 5% Triac Dimming
BEAM ANGLE	MD (Medium, 38°)
FINISH	White (WH)
WORKING TEMP.	-20°C (-4°F) to 40°C (104°F)
UGR	UGR<19
EMERGENCY	15W Jbox Emergency
LIFETIME	L70 at 50,000 Hours
PHOTOMETRIC	In accordance with IES LM79-08, LM80 and TM-30, TM-21

OPTICS

A clear polycarbonate TIR lens with an internal reflector allows an evenly, concentrated beam with minimal glare. A pull down 70° tilt and 360° rotation allow for versatile, directional illumination.

Available in 750L and 5 selectable color temperatures of 2700K/3000K/35000K/40000K/50000K enable different warm to cool moods and atmospheres.

CCT factory set to 50K.

CONSTRUCTION

Features a lightweight, airtight aluminum body and trim for durability and easy handling. Elbow light's 70° tilt can be utilized via pull down mechanism. Can be rotated 360° on luminaire base.

Pre-installed spring clips and friction clip included for quick, easy installation.

Remote driver with 18" cable included. Multi-CCT switch located on cable.

MAINTENANCE

Fixture can be regularly and safely wiped down to ensure optimal fixture performance.

MOUNTING

Suitable for recessed mounting in new construction and retrofit applications. No recessed housing required. Recommended hole cut-out size is 4 1/4".

May be installed in drywall or suspended ceilings.

OPTIONS & ACCESSORIES

Available to order separately:

- 15W emergency battery back-up option
- Optional square trim: **RL454-ACC-SQ-WH**

Extension cable options:

- **RL-ACC-SLIM-1-10F** (10-ft)
- **RL-ACC-SLIM-1-20F** (20-ft)

Rough Plate options:

- **RL-UNV-4/5/6** for use with 4", 5", and 6" downlights.
- **RL-UNV-1/2/3/4/5/6/8/10** - Universal Mounting Plate for 1", 2", 3", 4", 5", 6", 8" and 10" downlights
- **AL-ACC-SLIM-4-F-ROUGHPLATE** for use with 4" downlights
- **RL-ACC-SLIM-4-F-ROUGHPLATE** for use with 4" downlights

See order chart for details.

DRIVER & ELECTRICAL INFORMATION

Powered by high-quality constant-current power LED drivers which are rated for 50 to 60Hz at 120V input, produce less than 20% THD, and have a power factor of .90 to 1.00.

DIMMING

DIMTR - 5% Flicker-free triac dimming at 120V.

WARRANTY

5-year warranty for parts and components (labor not included).

LISTINGS

Energy Star compliant.
ETL listed.
JA8 and Title 24 compliant.
Damp location rated.
IC rated, airtight, and ready for direct contact with insulation.

MULTI-CCT SWITCH



TRIM OPTION



RL454-ACC-SQ-WH
4" Square Trim, White

OPTION & ACCESSORIES



RL-ACC-SLIM-1-10F
10-ft long extension

RL-ACC-SLIM-1-20F
20-ft long extension

RL-ACC-SLIM-4-ROUGHPLATE
For 4" downlights

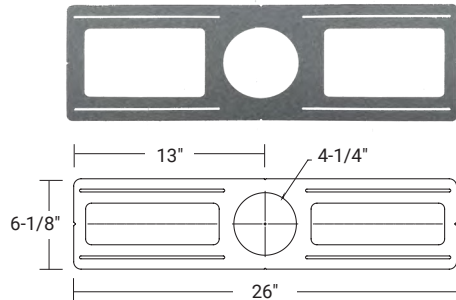

RL-UNV-1/2/3/4/5/6/8/10
For use with 1", 2", 3", 4", 5", 6", 8", and 10" downlights

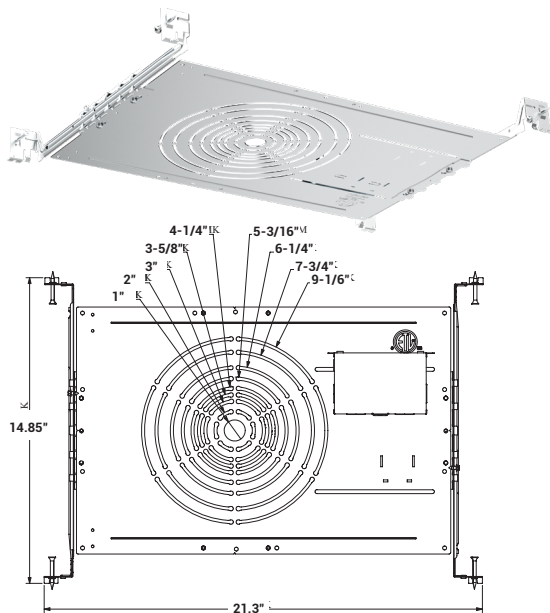

RL-UNV-4/5/6
For use with 4", 5", and 6" downlights

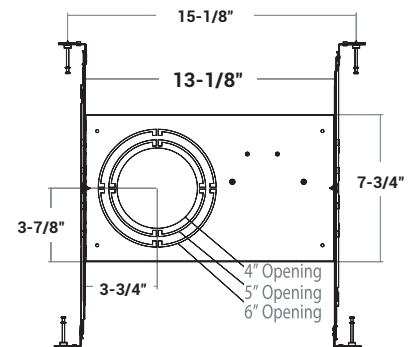

AL-ACC-SLIM-4-ROUGHPLATE
For 4" downlights

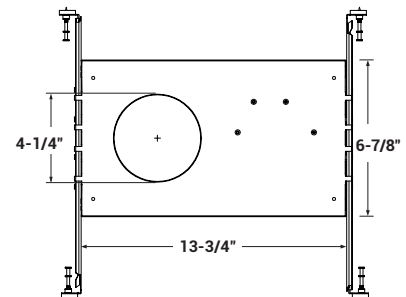

Example: **RL454-750L-DIMTR-120-27K/30K/35K/40K/50K-90-MD-WH**

RL454							
SERIES	LUMENS	DIMMING	CCT	CRI	TIR OPTICS	FINISH	OPTION
RL454	750L	DIMTR/120 - Triac	27K/30K/35K/40K/50K	90	MD (38°) - Included Standard	WH - White	RL454-ACC-SQ-WH - Square Trim, White RL-ACC-SLIM-1-10F - 10-ft long extension RL-ACC-SLIM-1-20F - 20-ft long extension RL-UNV-4/5/6 - Universal Mounting Plate for 4", 5" and 6" RL-UNV-1/2/3/4/5/6/8/10 - Universal Mounting Plate for 1", 2", 3", 4", 5", 6", 8" and 10" AL-ACC-SLIM-4-F-ROUGHPLATE - 4" Flanged Roughplate RL-ACC-SLIM-4-ROUGHPLATE - 4" Mounting Plate O-EMG-LED-JBOX-15W-HV - 15W Emergency Back up

RL454-750L-DIMTR-120-27K-30K-35K-40K-50K-90-MD-WH

TEST NO.: **EL01202531**

INPUT WATTS: **9.4** LUMENS: **950** EFFICACY: **101** BEAM ANGLE: **39** SPACING CRITERIA: **0.60**

CANDELA DISTRIBUTION

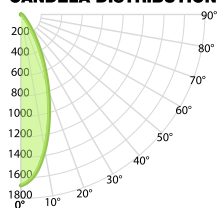

CANDELA TABLE

	0°	90°
0°	1672	1672
10°	1343	1367
20°	777	796
30°	328	342
40°	101	103
50°	41	40
60°	21	23
70°	11	12
80°	4	4
90°	0	0

LUMINANCE (cd/sq.m)

	0.00°	90.00°
0.00°	143240	143240
45.00°	7038	6900
55.00°	4379	4462
65.00°	3215	3504
75.00°	2313	2621
85.00°	177	324

LUMENS PER ZONE

ZONE	LUMENS
0° - 10°	152
10° - 20°	298
20° - 30°	256
30° - 40°	133
40° - 50°	54
50° - 60°	29
60° - 70°	17
70° - 80°	9
80° - 90°	1

ZONAL LUMEN SUMMARY

ZONE	LUMENS	% LUMINAIRE
0° - 20°	450	47%
0° - 30°	706	74%
0° - 40°	839	88%
0° - 60°	922	97%
0° - 80°	948	100%
0° - 90°	949	100%

CONE OF LIGHT

MOUNTING HEIGHT	FC AT BEAM CENTER	BEAM DIA. 0° -180°	BEAM DIA. 90° -270°
6.0 ft	46.5 fc	4.3 ft	4.4 ft
8.0 ft	26.1 fc	5.7 ft	5.8 ft
10.0 ft	16.7 fc	7.1 ft	7.3 ft
12.0 ft	11.6 fc	8.5 ft	8.7 ft
14.0 ft	8.5 fc	9.9 ft	10.2 ft
16.0 ft	6.5 fc	11.3 ft	11.6 ft
18.0 ft	5.2 fc	12.8 ft	13.1 ft
20.0 ft	4.2 fc	14.2 ft	14.5 ft

INDOOR COEFFICIENTS OF UTILIZATION

pf	20%																		0%												
	80%						70%						50%						30%						10%						0%
	pc	70%	50%	30%	10%	70%	50%	30%	10%	50%	30%	10%	50%	30%	10%	50%	30%	10%	50%	30%	10%	0%									
pw	70%	50%	30%	10%	70%	50%	30%	10%	50%	30%	10%	50%	30%	10%	50%	30%	10%	50%	30%	10%	0%										
0	119	119	119	119	117	117	117	117	111	111	111	107	107	107	102	102	102	102	100	100	0%										
1	114	111	108	106	111	109	106	104	105	103	101	101	99	98	97	96	95	95	93	93	0%										
2	108	103	99	96	106	101	98	95	98	95	93	95	93	91	92	90	89	89	87	87	0%										
3	103	96	91	87	101	95	90	87	92	88	85	90	87	84	88	85	83	81	81	81	0%										
4	98	90	85	81	96	89	84	80	87	83	79	85	81	78	83	80	77	76	76	76	0%										
5	93	85	79	75	92	84	79	75	82	78	74	81	77	73	79	76	73	71	71	71	0%										
6	89	80	74	70	87	79	74	70	78	73	69	77	72	69	75	71	69	67	67	67	0%										
7	85	76	70	66	84	75	70	66	74	69	65	73	68	65	72	68	65	63	63	63	0%										
8	81	72	66	62	80	71	66	62	70	65	62	69	65	62	68	64	61	60	60	60	0%										
9	78	69	63	59	77	68	63	59	67	62	59	66	62	59	65	61	58	57	57	57	0%										
10	75	65	60	56	74	65	60	56	64	59	56	63	59	56	63	59	56	54	54	54	0%										