

NOMINAL LUMENS	DELIVERED LUMENS	WATTAGE
550	604	8W

Based on 3000K, 90+ CRI. Actual wattage may vary +/- 5%

#### INSTALLATION

Cut hole in ceiling. Insert luminaire into opening by squeezing spring clips on both sides of luminaire. The width in ceiling needed for the driver to fit is 3".

You MUST seal all gaps between the ceiling and fixture with weatherproof silicone sealant. This deters moisture and water from damaging fixtures and other mechanical ceiling elements.

#### FEATURES

3" LED round slim luminaire engineered for new construction, remodel, or retrofit to accommodate insulated or dropped ceilings. Flat lens delivers even illumination. Remote driver allows easy installation and maintenance. Small aperture and shallow depth are ideal for unlimited applications.

LUMENS	550
CCT	27K, 30K, 35K, 40K
CRI	90+
COLOR QUALITY	3-Step MacAdam Ellipse
CONSTRUCTION	Aluminum die-cast body and trim
TRIM OPTION	Round Flat Lens
COLORS	WH ( White-standard) BZ (Bronze), BK (Black), CP ( Copper), SN( Satin Nickel )
DIMMING	DIMTR (Triac)
EMERGENCY	16W high voltage inverter ( remote)
LIFETIME	L70 at 50,000 Hours
PHOTOMETRIC TESTS	In Accordance with IES LM79-08, LM80 and TM-30, TM-21

- IC-Rated and Air-Tight ready and may be in direct contact with insulation.
- Can be installed in applications with limited plenum clearance.
- May be installed in drywall or suspended ceilings.
- Flicker-free 120V forward-phase Triac dimming down to 5%.
- Even illumination of luminaire is achieved by utilizing patent-pending optics along with edgelit LED technology.
- Aluminum die-cast body and trim.

## SLIM TRIM



## TRIM RINGS



**RL375-RT-BK**  
(Black)



**RL375-RT-BZ**  
(Bronze)



**RL375-RT-CP**  
(Copper)



**RL375-RT-SN**  
(Satin Nickel)

## ACCESSORIES



**RL-ACC-SLIM-1-10F**  
10-ft long extension



**RL-ACC-SLIM-1-20F**  
20-ft long extension

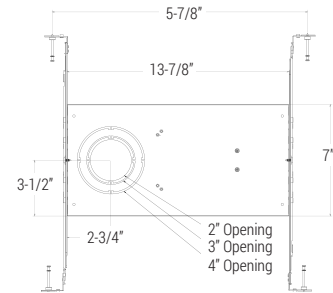

**RL-UNV-2/3/4**  
For use with: 2", 3", 4"  
Universal mounting plate

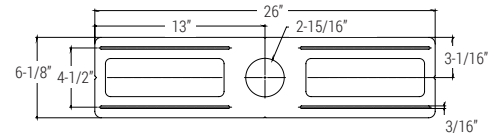

**RL-ACC-SLIM-3-ROUGHPLATE**  
Rough-in plate for use with 3" downlights

EXAMPLE: **RL375-550L-DIMTR-120-30K-90-WH**

TYPE	LUMEN	CCT	CRI	FINISH
RL375	<input type="checkbox"/> 550L-DIMTR-120 <input type="checkbox"/> 550L-277-347* *(non-dimmable)	<input type="checkbox"/> 27K <input type="checkbox"/> 30K <input type="checkbox"/> 35K <input type="checkbox"/> 40K	<input type="checkbox"/> 90+	<input type="checkbox"/> WH - White

**RL375-RT-BZ**

INSERTS
<input type="checkbox"/> RL375-RT-BZ-Bronze <input type="checkbox"/> RL375-RT-CP-Copper <input type="checkbox"/> RL375-RT-BK-Black <input type="checkbox"/> RL375-RT-SN-Satin Nickel

**RL-ACC-SLIM-1-10F**

OPTIONS
<input type="checkbox"/> RL-ACC-SLIM-1-10F - 10ft Long Extension <input type="checkbox"/> RL-ACC-SLIM-1-20F - 20ft Long Extension <input type="checkbox"/> RL-UNV-2/3/4 - Universal Mounting Plate for 2", 3" and 4" <input type="checkbox"/> RL-ACC-SLIM-3-ROUGHPLATE - 3" Mounting Plate

**RL375-550L-DIMTR-120-30K-90-WH**

TEST NO.: **EL011856**

INPUT WATTS: **8.4**

LUMENS: **604**

CRI: **90**

EFFICACY: **72**

CCT: **3000K**

SPACING CRITERIA: **1.38**

**Candle Power Distribution (Candelas)**

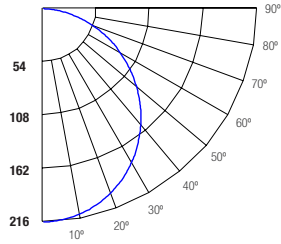

**Zonal Lumens Summary**

Zone	Lumens	%Lamp	%Fixt
0-20	78.27	13.00	13.00
0-30	165.97	27.50	27.50
0-40	271.50	45.00	45.00
0-60	479.14	79.40	79.40
0-80	598.64	99.20	99.20
0-90	603.74	100.00	100.00

**Luminance (Average candela/M<sup>2</sup>)**

Angle in Degrees	Average 0°	Average 45°	Average 90°
45	43105	42080	42733
55	40987	39932	40269
65	38686	37054	37515
75	33629	32359	32800
85	22447	0	0

**Lumens Per Zone**

Zone	Lumens
0-10	20.26
10-20	58.01
20-30	87.71
30-40	105.53
40-50	109.12
50-60	98.52
60-70	76.13
70-80	43.38
80-90	5.10

**Candela Tabulation**

Q	
0	215.61
5	214.37
15	205.68
25	189.86
35	167.15
45	139.13
55	107.31
65	74.63
75	39.73
85	8.93
90	0.34

**Coefficients of Utilization - Zonal Cavity Method**  
Effective Floor Cavity Reflectance 0.20

Cone of Light			
2	53.9	5.9	5.9
4	13.5	11.8	11.8
6	5.99	17.7	17.7
8	3.37	23.6	23.6
10	2.16	29.4	29.5
12	1.5	35.3	35.4
(FT) Distance to Plane	(FC) Initial Footcandle at Nadir	(FT) Beam Vert. Spread	(FT) Beam Horiz. Spread

BEAM DIA. MEASURED AT 50% OF NADIR F.C.

	RC	80%				70%				50%				30%				10%				0%
	RW	70%	50%	30%	10%	70%	50%	30%	10%	50%	30%	10%	50%	30%	10%	50%	30%	10%	0%			
ROOM CAVITY RATIO	0	119	119	119	119	116	116	116	116	111	111	111	106	106	106	102	102	102	100			
	1	109	104	100	96	106	102	98	95	98	95	92	94	91	89	90	88	86	84			
	2	99	91	84	78	96	89	83	77	85	80	76	82	78	74	79	76	72	70			
	3	90	80	72	65	88	78	71	64	75	69	63	72	67	62	70	65	61	59			
	4	83	71	62	55	80	69	61	55	67	60	54	64	58	53	62	57	52	50			
	5	76	63	54	47	74	62	53	47	60	52	47	58	51	46	56	50	46	43			
	6	70	57	48	41	68	56	47	41	54	46	41	52	46	40	51	45	40	38			
	7	65	51	43	36	63	51	42	36	49	41	36	48	41	36	46	40	35	33			
	8	60	47	38	32	59	46	38	32	45	37	32	44	37	32	42	36	32	30			
	9	56	43	35	29	55	42	35	29	41	34	29	40	34	29	39	33	29	27			
10	53	40	32	26	52	39	32	26	38	31	26	37	31	26	36	30	26	24				

RC - Ceiling Cavity Reflectance

RW - Wall Reflectance