

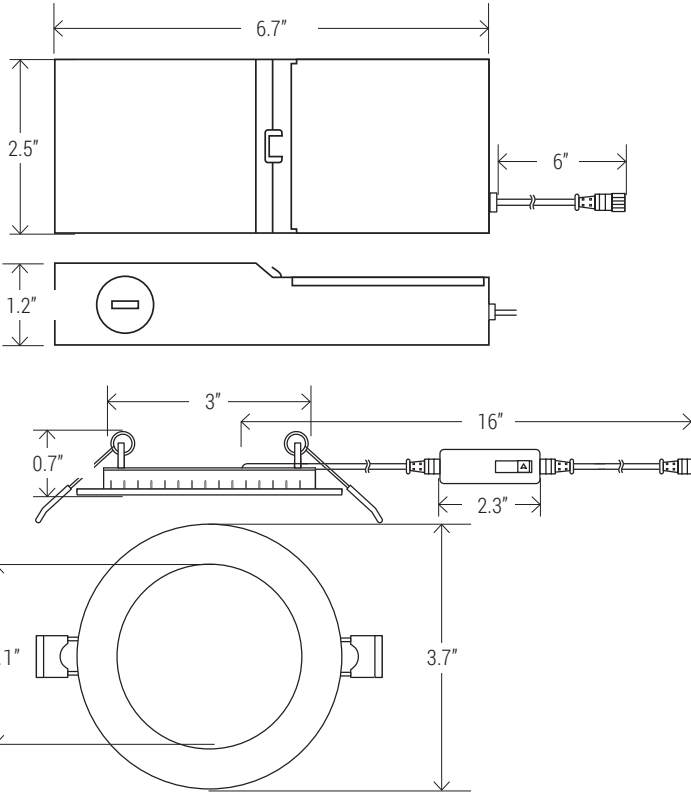

EASY 5 COLORS
SELECCTOR
2700K • 3000K • 3500K • 4000K • 5000K



NOMINAL LUMENS	DELIVERED LUMENS	WATTAGE
500	574	8W

Based on 4000K, 90+ CRI. Actual wattage may vary +/- 5%

INSTALLATION

Cut hole in ceiling. Insert luminaire into opening by squeezing spring clips on both sides of luminaire. The width in ceiling needed for the driver to fit is 3".

You MUST seal all gaps between the ceiling and fixture with weatherproof silicone sealant. This deters moisture and water from damaging fixtures and other mechanical ceiling elements.

FEATURES

3" slim multi-CCT LED downlight engineered for new construction, remodel or retrofit to accommodate insulated or dropped ceilings. Easily access field-adjustable 5-Color SeleCCTor switch by lowering the luminaire from the opening. Flat lens delivers even illumination. Remote driver allows easy installation and maintenance. Small aperture and shallow depth are ideal for unlimited applications.

LUMENS	500
CCT	27K/30K/35K/40K/50K
CRI	90+
COLOR QUALITY	3-Step MacAdam Ellipse
CONSTRUCTION	Aluminum die-cast body and trim
TRIM OPTION	Round Flat Lens
COLORS	WH (White-standard) BZ (Bronze), BK (Black), CP (Copper), SN (Satin Nickel)
DIMMING	DIMTR (Triac), DIM10(0-10V)
EMERGENCY	16W high voltage inverter (remote)
LIFETIME	L70 at 50,000 Hours
PHOTOMETRIC TESTS	In Accordance with IES LM79-08, LM80 and TM-30, TM-21

- The CCT selector switch is easily accessible by unsnapping the luminaire from the ceiling.
- IC-Rated and Air-Tight ready and may be in direct contact with insulation.
- Can be installed in applications with limited plenum clearance.
- May be installed in drywall or suspended ceilings.
- Flicker-free 120V forward-phase Triac dimming down to 5%.
- Even illumination of luminaire is achieved by utilizing patent-pending optics along with edgelit LED technology.
- Aluminum die-cast body and trim.



SLIM TRIM



TRIM RINGS



RL375-RT-BK
(Black)



RL375-RT-BZ
(Bronze)



RL375-RT-CP
(Copper)



RL375-RT-SN
(Satin Nickel)

ACCESSORIES



RL-ACC-SLIM-1-10F
10-ft long extension



RL-ACC-SLIM-1-20F
20-ft long extension

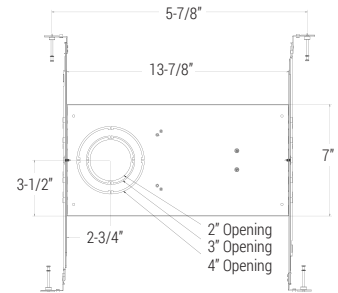

RL-UNV-2/3/4
For use with: 2", 3", 4"
Universal mounting plate

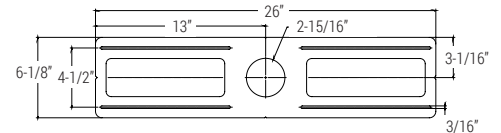

RL-ACC-SLIM-3-ROUGHPLATE
Rough-in plate for use with 3" downlights

EXAMPLE:

RL375-500L-DIMTR-120-27K/30K/35K/40K/50K-90

RL375-RT-BZ

RL-ACC-SLIM-1-10F

TYPE	LUMEN	CCT	CRI	FINISH
RL375	<input type="checkbox"/> 500L-DIMTR-120 <input type="checkbox"/> 500L-DIM10-347	<input type="checkbox"/> 27K/30K/35K/40K/50K	<input type="checkbox"/> 90+	<input type="checkbox"/> WH - White

INSERTS
<input type="checkbox"/> RL375-RT-BZ-Bronze <input type="checkbox"/> RL375-RT-CP-Copper <input type="checkbox"/> RL375-RT-BK-Black <input type="checkbox"/> RL375-RT-SN-Satin Nickel

OPTIONS
<input type="checkbox"/> RL-ACC-SLIM-1-10F - 10ft Long Extension <input type="checkbox"/> RL-ACC-SLIM-1-20F - 20ft Long Extension <input type="checkbox"/> RL-UNV-2/3/4 - Universal Mounting Plate for 2", 3" and 4" <input type="checkbox"/> RL-ACC-SLIM-3-ROUGHPLATE - 3" Mounting Plate

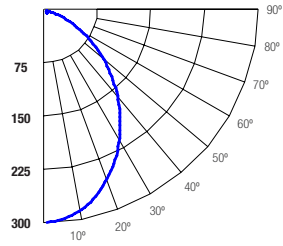
RL375-500L-DIMTR-120-27K-30K-40K-50K-90-WH
TEST NO.: EL082319129
INPUT WATTS: 7.7
LUMENS: 574
CRI: 90
EFFICACY: 74
CCT: 4000K
SPACING CRITERIA: 1.20
Candle Power Distribution (Candelas)

Zonal Lumens Summary

Zone	Lumens	%Lamp	%Fixt
0-20	105.67	18.40	18.40
0-30	215.29	37.50	37.50
0-40	334.47	58.30	58.30
0-60	520.18	90.70	90.70
0-80	572.51	99.80	99.80
0-90	572.56	99.80	99.80

Luminance (Average candela/M²)

Angle in Degrees	Average 0°	Average 45°	Average 90°
45	40704	41860	43183
55	30896	31660	33825
65	19045	20139	22523
75	4986	6086	8354
85	50	276	50

Lumens Per Zone

Zone	Lumens
0-10	28.08
10-20	77.59
20-30	109.62
30-40	119.18
40-50	107.14
50-60	78.57
60-70	42.17
70-80	10.16
80-90	0.05

Candela Tabulation

0	
0	299.10
5	295.00
15	271.11
25	231.71
35	183.16
45	131.38
55	80.89
65	36.74
75	5.89
85	0.02
90	0.02

Coefficients of Utilization - Zonal Cavity Method

Effective Floor Cavity Reflectance 0.20

Cone of Light			
2	74.8	3.7	3.7
4	18.7	7.4	7.4
6	8.31	11.2	11.2
8	4.67	14.9	14.9
10	2.99	18.6	18.6
12	2.08	22.3	22.3
(F.T.) Distance to Plane	(F.C.) Initial Footcandle at Nadir	(F.T.) Beam Vert. Spread	(F.T.) Beam Horiz. Spread

BEAM DIA. MEASURED AT 50% OF NADIR F.C.

ROOM CAVITY RATIO	RC	80%				70%				50%				30%				10%				0%
	RW	70%	50%	30%	10%	70%	50%	30%	10%	50%	30%	10%	50%	30%	10%	50%	30%	10%	50%	30%	10%	0%
0	119	119	119	119	119	116	116	116	116	111	111	111	106	106	106	102	102	102	100	100	100	88
1	111	107	104	101	108	105	102	99	101	98	96	93	97	95	93	93	92	90	88	88	88	77
2	103	96	90	86	100	94	89	85	91	86	83	81	87	84	81	84	82	79	77	77	77	67
3	95	86	79	73	93	84	78	73	81	76	72	72	79	74	70	76	72	69	67	67	67	59
4	88	77	70	64	86	76	69	63	74	67	63	63	71	66	62	69	65	61	59	59	59	52
5	81	70	62	56	79	69	61	56	67	60	55	55	65	59	55	63	58	54	52	52	52	46
6	76	64	56	50	74	63	55	50	61	54	49	49	59	53	49	58	53	48	46	46	46	42
7	70	58	50	45	69	57	50	44	56	49	44	44	54	48	44	53	48	44	42	42	42	38
8	66	53	46	40	64	53	45	40	51	45	40	40	50	44	40	49	44	39	38	38	38	34
9	62	49	42	37	60	49	42	37	48	41	36	36	47	41	36	46	40	36	34	34	34	31
10	58	46	38	34	57	45	38	33	44	38	33	33	43	37	33	43	37	33	31	31	31	28

RC - Ceiling Cavity Reflectance

RW - Wall Reflectance