

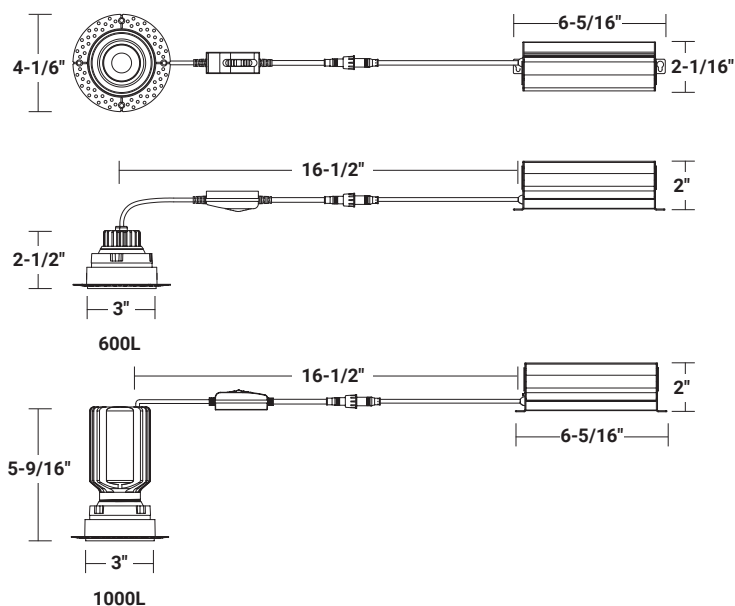

DIMENSIONS



NOMINAL LUMENS	DELIVERED LUMENS	WATTAGE
600L	734L	8W
1000L	1246L	10W

Based on 4000K, 90+ CRI. Actual wattage may vary +/- 5%

INSTALLATION

Cut hole in ceiling. Insert luminaire into opening by squeezing spring clips on both sides of luminaire. The width in ceiling needed for the driver to fit is 3".

For wet location application, you **MUST** seal all gaps between the ceiling and fixture with weatherproof silicone sealant. This deters moisture and water from damaging fixtures and other mechanical ceiling elements. Installation hole size: 3"

FEATURES

SEAMLESS INTEGRATION, DYNAMIC ILLUMINATION

This 3" LED gimbal features a trimless design, 30° tilt, and 360° rotation for dynamic illumination. A regressed lens and smooth reflector make for radiant, glare-free light, while 5 selectable CCT allows for versatile atmospheres. Engineered for new construction, remodel, or retrofit applications and accommodates insulated and dropped ceilings. Ideal for use in lobbies, showrooms, offices, hallways and more in corporate, residential, commercial, retail, healthcare and hospitality spaces. No housing or driver necessary. Wet location and IC rated.

LUMENS	600L, 1000L
CCT	27K/30K/35K/40K/50K
CRI	90+ Standard
COLOR QUALITY	3-Step MacAdam Ellipse
MOUNTING	Recessed Trimless
DIMMING	DIMTR - 10% Triac Dimming
BEAM ANGLE	MD (Medium, 38°), ND (Narrow, 24°) and WD (Wide, 60°)
FINISH	White (W-WH)
WORKING TEMP.	-20°C (-4°F) to 40°C (104°F)
UGR	UGR<19
EMERGENCY	16W High Voltage Inverter (Remote)
LIFETIME	L70 at 50,000 Hours
PHOTOMETRIC	In accordance with IES LM79-08, LM80 and TM-30, TM-21

OPTICS

Cut hole in ceiling. Insert luminaire into opening by squeezing spring clips on both sides of luminaire. The width ceiling needed for the driver to fit is 3". Installation hole size: 3".

OPTICS

Features a slightly regressed polycarbonate lens and smooth reflector for uniform, low-glare illumination. A 30° tilt, and 360° rotation allow for directional, dynamic illumination.

Available in lumen packages of 600L or 1000L and 5 selectable color temperatures of 2700K/3000K/3500K/4000K/5000K enable different warm to cool moods and atmospheres. CCT factory set to 5000K.

A CRI value of 90 guarantees vibrant, natural color display, while a 38° beam angle makes for a Medium (MD) distribution.

Additional 24° and 60° TIR optics available to order separately.

CONSTRUCTION

A durable, die-cast aluminum body allows for lightweight installation and thermal regulation. A twist and lock module design allows for easy mounting. A small aperture and shallow depth allow for unlimited applications.

Perforated mesh cover designed for a seamless drywall or plaster mud-in.

Remote steel driver/junction box included. Multi-CCT switch located on cord for remote driver.

Airtight, wet location and IC rated. Available in a white finish.

MAINTENANCE

Fixture can be regularly and safely wiped down to ensure optimal fixture performance.

MOUNTING

Suitable for recessed mounting. Recommended hole cut-out size is 3".

OPTIONS & ACCESSORIES

Available to order separately:

- 16W emergency battery back-up option
- Optional TIR optics: Narrow (ND) at 24° and Wide (WD) distribution at 60°

Extension cable options:

- **RL-ACC-SLIM-1-10F** (10-ft)
- **RL-ACC-SLIM-1-20F** (20-ft)

Rough Plate options:

- **RL-UNV-2/3/4** for use with 2", 3", and 4" downlights.
- **RL-UNV-1/2/3/4/5/6/8/10** - Universal Mounting Plate for 1", 2", 3", 4", 5", 6", 8" and 10" downlights
- **RL-ACC-SLIM-3-ROUGHPLATE** Rough-in plate for 3" downlights
- **AL-ACC-SLIM-3-F-ROUGHPLATE** for use with 3" downlights

See order chart for details.

DRIVER & ELECTRICAL INFORMATION

Powered by high-quality constant-current power LED drivers which are rated for 50 to 60Hz at 120V-277V input, produce less than 20% THD, and have a power factor of .90 to 1.00.

DIMMING

DIMTR - 10% Triac dimming at 120V.

WARRANTY

5-year warranty for parts and components (labor not included).

LISTINGS

ETL listed.
Energy Star listed.
JA8 and Title 24 compliant.
Wet location suitable.
IC rated, air-tight, and ready for contact with insulation.

MULTI-CCT SWITCH

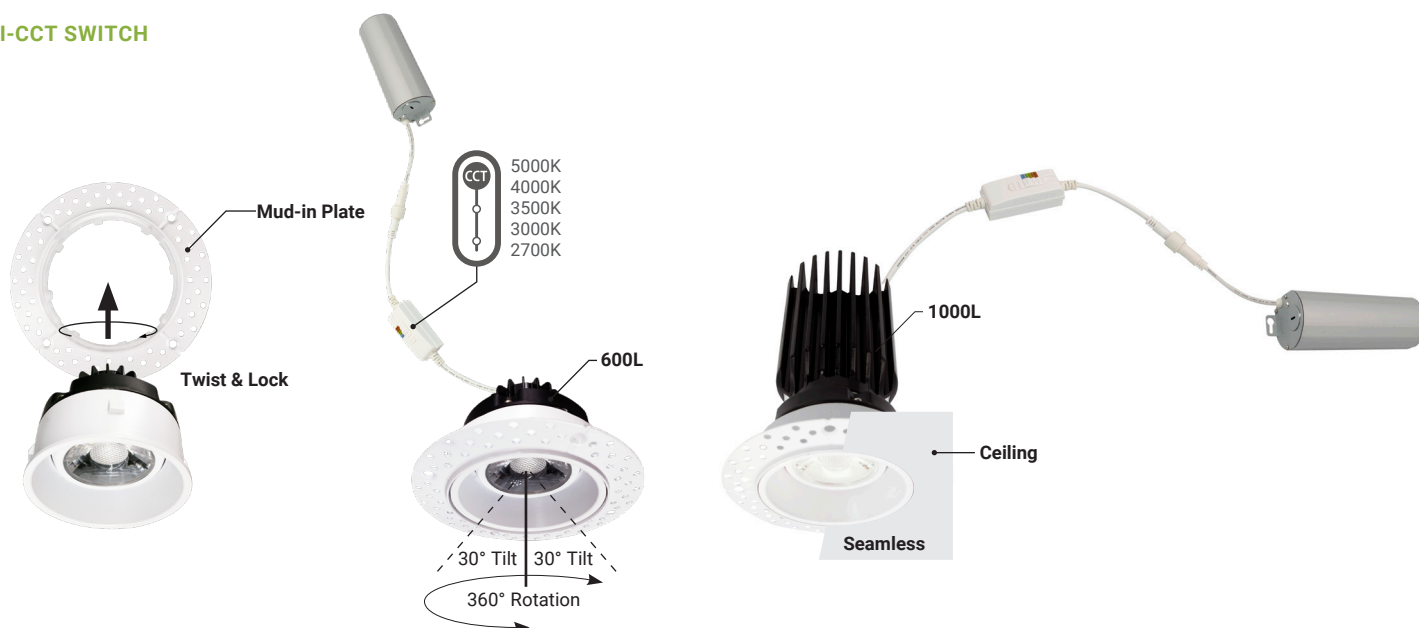

OPTION & ACCESSORIES



RL-ACC-SLIM-1-10F
10-ft long extension

RL-ACC-SLIM-1-20F
20-ft long extension

RL-ACC-SLIM-3-ROUGHPLATE
For use with 3" downlights

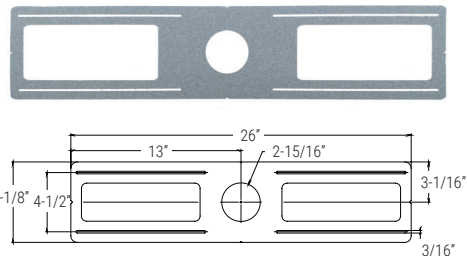

RL-UNV-2/3/4
For use with 2", 3", and 4" downlights

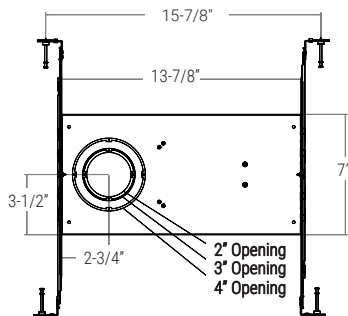

RL-UNV-1/2/3/4/5/6/8/10
For use with 1", 2", 3", 4", 5", 6", 8", and 10" downlights



AL-ACC-SLIM-3-F-ROUGHPLATE
For 3" downlights

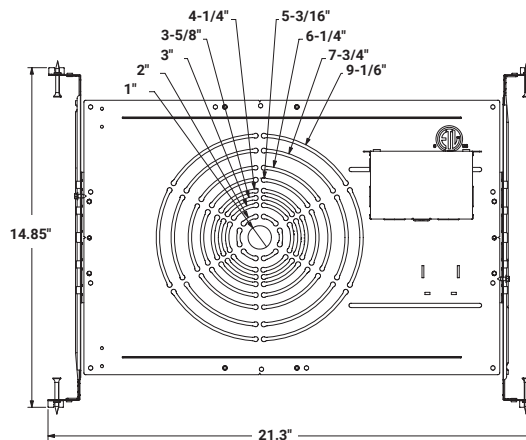
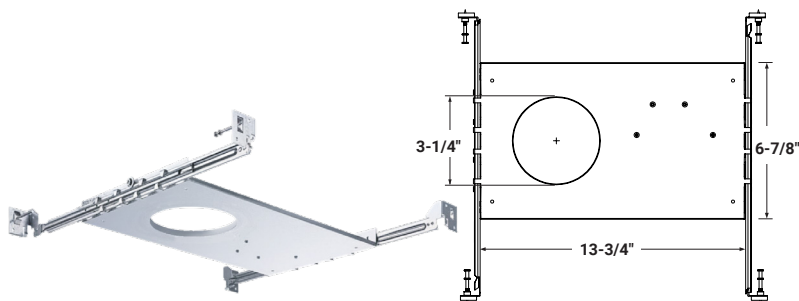

Example: **RL372-TL-1000L-DIMTR-120-27K/30K/35K/40K/50K-90-W-WH**

SERIES	LUMENS	DIMMING	CCT	CRI	FINISH	TIR OPTICS	OPTION
RL372-TL	600L 1000L	DIMTR/120 - Triac	27K/30K/35K/40K/50K	90	W-WH - White	ND (24°) MD (38°) - Included Standard WD (60°)	RL-ACC-SLIM-1-10F - 10-ft long extension RL-ACC-SLIM-1-20F - 20-ft long extension AL-ACC-SLIM-3-F-ROUGHPLATE - 3" Flanged Roughplate RL-ACC-SLIM-3-ROUGHPLATE - 3" Mounting Plate RL-UNV-2/3/4 - Universal Mounting Plate for 2", 3" and 4" RL-UNV-1/2/3/4/5/6/8/10 - Universal Mounting Plate for 1", 2", 3", 4", 5", 6", 8" and 10" O-EMG-LED-16W-FLEX - 16W Emergency Back up (Remote)

RL372-TL-600L-DIMTR-120-27K-30K-35K-40K-50K-90-W-WH

TEST NO.: **EL11192536**

INPUT WATTS: **7.4** LUMENS: **734** EFFICACY: **99** BEAM ANGLE: **40** SPACING CRITERIA: **0.56**

CANDELA DISTRIBUTION

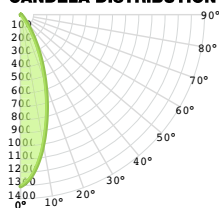

CANDELA TABLE

	0°	90°
0°	1306	1306
10°	1001	1053
20°	557	613
30°	220	263
40°	62	75
50°	23	27
60°	12	13
70°	6	6
80°	2	2
90°	0	0

LUMINANCE (cd/sq.m)

	0.00°	90.00°
0.00°	393665	393665
45.00°	15471	17775
55.00°	8517	9463
65.00°	6061	6491
75.00°	3027	3208
85.00°	3054	1089

LUMENS PER ZONE

ZONE	LUMENS
0° - 10°	114
10° - 20°	240
20° - 30°	205
30° - 40°	105
40° - 50°	37
50° - 60°	16
60° - 70°	9
70° - 80°	3
80° - 90°	1

ZONAL LUMEN SUMMARY

ZONE	LUMENS	% LUMINAIRE
0° - 20°	354	48%
0° - 30°	559	76%
0° - 40°	663	90%
0° - 60°	716	98%
0° - 80°	728	99%
0° - 90°	729	99%

CONE OF LIGHT

MOUNTING HEIGHT	FC AT BEAM CENTER	BEAM DIA. 0° -180°	BEAM DIA. 90° -270°
6.0 m	36.3 lx	4.3 m	4.3 m
8.0 m	20.4 lx	5.8 m	5.7 m
10.0 m	13.1 lx	7.2 m	7.1 m
12.0 m	9.1 lx	8.7 m	8.5 m
14.0 m	6.7 lx	10.1 m	10.0 m
16.0 m	5.1 lx	11.5 m	11.4 m
18.0 m	4.0 lx	13.0 m	12.8 m
20.0 m	3.3 lx	14.4 m	14.2 m

INDOOR COEFFICIENTS OF UTILIZATION

ρf pc pw	80%			70%			20%			50%			30%			10%			0%
	70%	50%	30%	10%	70%	50%	30%	10%	50%	30%	10%	50%	30%	10%	50%	30%	10%	50%	0%
0	119	119	119	119	116	116	116	116	111	111	111	106	106	106	101	101	101	99	0%
1	113	111	108	106	111	108	106	104	104	103	101	100	99	98	97	96	95	93	0%
2	108	103	99	96	106	101	98	95	98	95	93	95	93	91	92	90	89	87	0%
3	103	97	92	88	101	95	91	87	93	89	86	90	87	84	88	85	83	81	0%
4	98	91	85	81	96	90	85	81	87	83	80	85	82	79	83	80	78	76	0%
5	93	86	80	76	92	85	79	75	83	78	75	81	77	74	79	76	73	72	0%
6	89	81	75	71	88	80	75	71	78	74	70	77	73	70	76	72	69	68	0%
7	85	76	71	67	84	76	70	67	75	70	66	73	69	66	72	68	65	64	0%
8	82	73	67	63	80	72	67	63	71	66	63	70	66	62	69	65	62	61	0%
9	78	69	64	60	77	69	63	60	68	63	59	67	62	59	66	62	59	58	0%
10	75	66	60	57	74	65	60	57	65	60	57	64	59	56	63	59	56	55	0%

RL372-TL-1000L-DIMTR-120-27K-30K-35K-40K-50K-90-W-WH

TEST NO.: **EL11192536**

INPUT WATTS: **10.8** LUMENS: **1246** EFFICACY: **115** BEAM ANGLE: **39** SPACING CRITERIA: **0.65**

CANDELA DISTRIBUTION

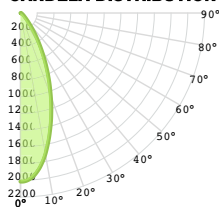

CANDELA TABLE

	0°	90°
0°	2015	2015
10°	1713	1387
20°	1059	727
30°	489	276
40°	160	85
50°	56	42
60°	27	22
70°	11	8
80°	3	3
90°	0	0

LUMINANCE (cd/sq.m)

	0.00°	90.00°
0.00°	607328	607328
45.00°	38197	25277
55.00°	19655	16258
65.00°	12609	10543
75.00°	5534	5554
85.00°	5153	2138

LUMENS PER ZONE

ZONE	LUMENS
0° - 10°	178
10° - 20°	383
20° - 30°	345
30° - 40°	193
40° - 50°	78
50° - 60°	34
60° - 70°	18
70° - 80°	7
80° - 90°	2

ZONAL LUMEN SUMMARY

ZONE	LUMENS	% LUMINAIRE
0° - 20°	561	45%
0° - 30°	906	73%
0° - 40°	1098	88%
0° - 60°	1211	97%
0° - 80°	1235	99%
0° - 90°	1237	99%

CONE OF LIGHT

MOUNTING HEIGHT	FC AT BEAM CENTER	BEAM DIA. 0° -180°	BEAM DIA. 90° -270°
6.0 m	56.0 lx	4.2 m	4.4 m
8.0 m	31.5 lx	5.7 m	5.9 m
10.0 m	20.2 lx	7.1 m	7.4 m
12.0 m	14.0 lx	8.5 m	8.9 m
14.0 m	10.3 lx	9.9 m	10.4 m
16.0 m	7.9 lx	11.3 m	11.8 m
18.0 m	6.2 lx	12.7 m	13.3 m
20.0 m	5.0 lx	14.2 m	14.8 m

INDOOR COEFFICIENTS OF UTILIZATION

ρf pc pw	80%			70%			20%			50%			30%			10%			0%
	70%	50%	30%	10%	70%	50%	30%	10%	50%	30%	10%	50%	30%	10%	50%	30%	10%	50%	0%
0	119	119	119	119	116	116	116	116	111	111	111	106	106	106	101	101	101	99	0%
1	113	110	108	106	111	108	106	104	104	102	101	100	99	97	97	96	94	93	0%
2	108	103	99	95	105	101	97	94	98	95	92	94	92	90	92	90	88	86	0%
3	102	96	91	87	100	94	90	86	92	88	85	89	86	83	87	84	82	80	0%
4	97	90	84	80	95	89	83	79	86	82	78	84	80	77	82	79	77	75	0%
5	92	84	78	74	91	83	78	74	81	77	73	80	76	72	78	75	72	70	0%
6	88	79	73	69	87	79	73	69	77	72	68	75	71	68	74	70	67	66	0%
7	84	75	69	65	83	74	69	65	73	68	64	72	67	64	70	67	64	62	0%
8	80	71	65	61	79	70	65	61	69	64	61	68	64	60	67	63	60	59	0%
9	77	67	62	58	76	67	61	58	66	61	57	65	60	57	64	60	57	56	0%
10	73	64	58	55	72	64	58	55	63	58	54	62	57	54	61	57	54	53	0%