

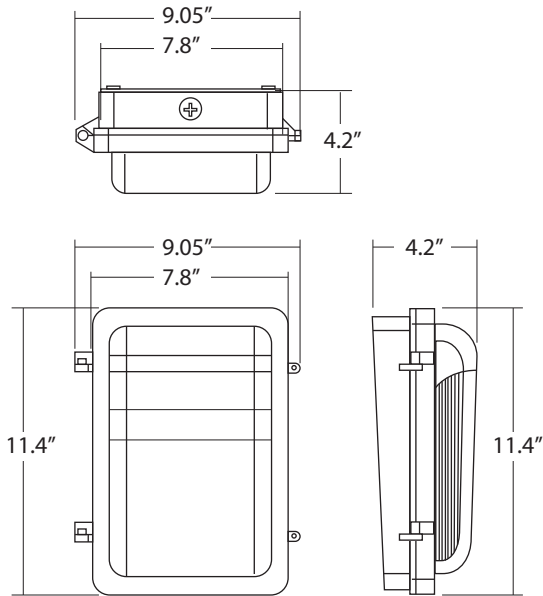

**MULTI LUMEN  
SELECTOR**

**EASY 3 COLORS  
SELECTOR**  
3000K • 3500K • 4000K

**DIMENSIONS**



NOMINAL LUMENS	DELIVERED LUMENS	WATTAGE
3000	2880	21W
4000	4185	31W
5000	5401	40W

Based on 4000K, 80+ CRI. Actual wattage may vary +/- 5%

CCT	MULTIPLIER
3000	0.93
4000	1.00
5000	0.94

**FEATURES**

The OWP-SC-105-LED semi-cutoff outdoor wall pack is a rugged, energy-efficient luminaire suitable for security, pathway, building perimeter and entryway lighting. It features 3 selectable lumen outputs and 3 selectable color temperatures making it a versatile and reliable option for numerous applications.

LUMENS	3000L/4000L/5000L
CCT	30K/40K/50K
CRI	80+
MOUNTING	Wall mount
DIMMING	DIM10 (0-10V dimming)
FINISH	Bronze, Black, White
WORKING TEMPERATURE	-40°C to 45°C (-40°F to 113°F)
LUMEN MAINTENANCE	L70 ≥ 50,000 hours per IES TM-21-21
PHOTOMETRIC	In accordance with IES LM-79-19

**BUG RATING**

B	U	G
2	2	2

**ACCESSORIES**



**OWP-SC-105-REF** - Reflector

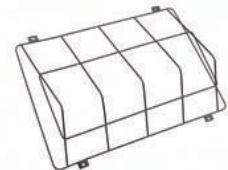

**OWP-SC-105-WG** - Wireguard



**CONSTRUCTION**

Sealed die-cast housing for outdoor applications.  
Meets ANSI C136.31 3G vibration requirement  
Optional wire guard to protect against vandalism.

**LEDS & OPTICS**

Three selectable CCTs: 3000K, 4000K or 5000K  
Three selectable light outputs: 3000, 4000 or 5000 lumens  
UV resistant lens provides outstanding performance, uniformity and glare control.  
Optional visor to reduce uplight and glare.

**ELECTRICAL**

- Universal 120-347 VAC input voltage.
- 0-10V Dimming.
- Power factor > 0.90, THD <20%.
- Operating Temperature Range: -40°C to 45°C (-40°F to 113°F)
- 2.5kV surge protection

**WARRANTY**

Five year warranty for parts and components (labor not included).

**LISTING**

cULus Listed  
Wet Location Listed (IP65)

**INSTRUCTIONS FOR ADJUSTING WATTAGE AND CCT**

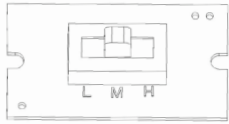

Slide the switch to the desired wattage level from 50% to 75% to 100%.

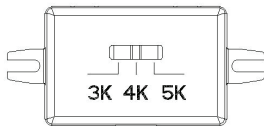

Slide the switch to the desired CCT setting from 3000K to 4000K to 5000K.

Note: The default factory settings will be 100% and 4000K.  
Important: Turn off power before making any adjustments to wattage and/or CCT.

Example: **OWP-SC-105-LED-3000L/4000L/5000L-DIM10-120-347V-30K/40K/50K-BZ**

<b>OWP-SC-105-LED</b>						
<b>SERIES</b>	<b>LUMENS</b>	<b>DIMMING</b>	<b>VOLTAGE</b>	<b>CCT</b>	<b>FINISH</b>	<b>ACCESSORIES</b>
OWP-SC-105-LED Slim Wall Pack	3000L/4000L/5000L	DIM10 - 0-10V Dimming	120-347V	30K/40K/50K	WH - White BK - Black BZ - Bronze	OWP-SC-105-REF - Reflector OWP-SC-105-WG - Wireguard

**OWP-SC-105-LED-3000L-4000L-5000L-DIM10-120-347V-30K-40K-50K-BZ(3000L)**

TEST NO.: **EL01122440**

INPUT WATTS: **20.6** LUMENS: **2880** EFFICACY: **140** BEAM ANGLE: **60** SPACING CRITERIA: **2.68**

**CANDELA DISTRIBUTION**

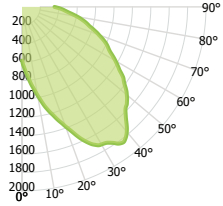

**CANDELA TABLE**

	0°	90°
0°	584	584
10°	977	563
20°	1383	537
30°	1727	527
40°	1772	513
50°	1487	463
60°	1173	353
70°	889	225
80°	609	98
90°	353	21

**LUMINANCE (cd/sq.m)**

	0.00°	90.00°
0.00°	0	0
10°	45.00°	0
20°	55.00°	0
30°	65.00°	0
40°	75.00°	0
50°	85.00°	0

**LUMENS PER ZONE**

ZONE	LUMENS
0° - 10°	55
10° - 20°	170
20° - 30°	299
30° - 40°	424
40° - 50°	481
50° - 60°	465
60° - 70°	391
70° - 80°	286
80° - 90°	169

**ZONAL LUMEN SUMMARY**

ZONE	LUMENS	% LUMINAIRE
0° - 20°	225	8%
0° - 30°	525	18%
0° - 40°	949	33%
0° - 60°	1894	66%
0° - 80°	2571	89%
0° - 90°	2739	95%

**CONE OF LIGHT**

MOUNTING HEIGHT	FC AT BEAM CENTER	BEAM DIA. 0°-180°	BEAM DIA. 90°-270°
6.0 ft	16.2 fc	15.7 ft	0.0 ft
8.0 ft	9.1 fc	20.9 ft	0.0 ft
10.0 ft	5.8 fc	26.1 ft	0.0 ft
12.0 ft	4.1 fc	31.4 ft	0.0 ft
14.0 ft	3.0 fc	36.6 ft	0.0 ft
16.0 ft	2.3 fc	41.8 ft	0.0 ft
18.0 ft	1.8 fc	47.0 ft	0.0 ft
20.0 ft	1.5 fc	52.3 ft	0.0 ft

**INDOOR COEFFICIENTS OF UTILIZATION**

pf	pc	80%			70%			20%			50%			30%			10%			0%
		70%	50%	30%	10%	70%	50%	30%	10%	50%	30%	10%	50%	30%	10%	50%	30%	10%	0%	
0	118	118	118	118	115	115	115	115	108	108	108	103	103	103	98	98	98	95	0%	
1	105	99	94	89	102	97	92	87	91	87	84	86	83	80	82	79	77	74	0%	
2	94	85	77	70	91	82	75	69	78	72	67	74	69	64	70	66	62	60	0%	
3	85	73	64	57	82	71	63	56	68	60	54	64	58	53	61	56	51	49	0%	
4	77	64	54	47	75	62	53	46	59	51	45	56	50	44	53	48	43	40	0%	
5	71	57	47	40	68	55	46	39	53	44	38	50	43	37	48	41	37	34	0%	
6	65	51	41	34	63	49	40	34	47	39	33	45	38	32	43	36	32	29	0%	
7	60	46	36	30	58	44	36	29	42	34	29	40	33	28	39	32	28	25	0%	
8	56	41	32	26	54	40	32	26	39	31	25	37	30	25	35	29	24	22	0%	
9	52	38	29	23	50	37	28	23	35	28	22	34	27	22	32	26	22	20	0%	
10	48	34	26	21	47	34	26	20	32	25	20	31	24	20	30	24	19	18	0%	

**OWP-SC-105-LED-3000L-4000L-5000L-DIM10-120-347V-30K-40K-50K-BZ(4000L)**

TEST NO.: **EL01122440**

INPUT WATTS: **30.6** LUMENS: **4185** EFFICACY: **137** BEAM ANGLE: **60** SPACING CRITERIA: **2.70**

**CANDELA DISTRIBUTION**

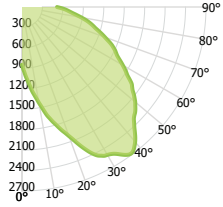

**CANDELA TABLE**

	0°	90°
0°	848	848
10°	1426	819
20°	2016	779
30°	2506	764
40°	2583	744
50°	2168	671
60°	1707	516
70°	1294	328
80°	885	141
90°	514	31

**LUMINANCE (cd/sq.m)**

	0.00°	90.00°
0.00°	0	0
10°	45.00°	0
20°	55.00°	0
30°	65.00°	0
40°	75.00°	0
50°	85.00°	0

**LUMENS PER ZONE**

ZONE	LUMENS
0° - 10°	81
10° - 20°	248
20° - 30°	435
30° - 40°	616
40° - 50°	698
50° - 60°	675
60° - 70°	568
70° - 80°	415
80° - 90°	245

**ZONAL LUMEN SUMMARY**

ZONE	LUMENS	% LUMINAIRE
0° - 20°	328	8%
0° - 30°	764	18%
0° - 40°	1380	33%
0° - 60°	2753	66%
0° - 80°	3735	89%
0° - 90°	3980	95%

**CONE OF LIGHT**

MOUNTING HEIGHT	FC AT BEAM CENTER	BEAM DIA. 0°-180°	BEAM DIA. 90°-270°
6.0 ft	23.5 fc	15.6 ft	0.0 ft
8.0 ft	13.2 fc	20.8 ft	0.0 ft
10.0 ft	8.5 fc	26.0 ft	0.0 ft
12.0 ft	5.9 fc	31.2 ft	0.0 ft
14.0 ft	4.3 fc	36.4 ft	0.0 ft
16.0 ft	3.3 fc	41.6 ft	0.0 ft
18.0 ft	2.6 fc	46.8 ft	0.0 ft
20.0 ft	2.1 fc	52.0 ft	0.0 ft

**INDOOR COEFFICIENTS OF UTILIZATION**

pf	pc	80%			70%			20%			50%			30%			10%			0%
		70%	50%	30%	10%	70%	50%	30%	10%	50%	30%	10%	50%	30%	10%	50%	30%	10%	0%	
0	118	118	118	118	115	115	115	115	109	109	109	103	103	103	98	98	98	95	0%	
1	105	100	94	90	102	97	92	88	91	88	84	87	83	80	82	80	77	75	0%	
2	95	85	77	71	91	83	75	69	78	72	67	74	69	65	70	66	62	60	0%	
3	85	74	64	57	82	72	63	56	68	60	54	64	58	53	61	56	51	49	0%	
4	78	64	55	47	75	63	54	47	59	52	45	56	50	44	54	48	43	40	0%	
5	71	57	47	40	68	55	46	39	53	45	38	50	43	38	48	42	37	34	0%	
6	65	51	41	34	63	49	40	34	47	39	33	45	38	32	43	37	32	29	0%	
7	60	46	36	30	58	45	36	29	42	35	29	41	33	28	39	32	28	25	0%	
8	56	41	32	26	54	40	32	26	39	31	25	37	30	25	35	29	24	22	0%	
9	52	38	29	23	50	37	29	23	35	28	22	34	27	22	32	26	22	20	0%	
10	48	35	26	21	47	34	26	20	32	25	20	31	25	20	30	24	19	18	0%	

**OWP-SC-105-LED-3000L-4000L-5000L-DIM10-120-347V-30K-40K-50K-BZ(5000L)**

TEST NO.: **EL01122440**

INPUT WATTS: **40.2**

LUMENS: **5401**

EFFICACY: **134**

BEAM ANGLE: **62**

SPACING CRITERIA: **2.65**

**CANDELA DISTRIBUTION**

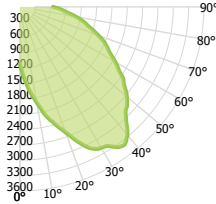

**CANDELA TABLE**

	0°	90°
0°	1109	1109
10°	1902	1068
20°	2613	1016
30°	3183	999
40°	3269	974
50°	2731	880
60°	2154	674
70°	1634	430
80°	1119	186
90°	648	40

**LUMINANCE (cd/sq.m)**

	0.00°	90.00°
0.00°	0	0
45.00°	0	0
55.00°	0	0
65.00°	0	0
75.00°	0	0
85.00°	0	0

**LUMENS PER ZONE**

ZONE	LUMENS
0° - 10°	105
10° - 20°	324
20° - 30°	565
30° - 40°	797
40° - 50°	901
50° - 60°	868
60° - 70°	730
70° - 80°	533
80° - 90°	314

**ZONAL LUMEN SUMMARY**

ZONE	LUMENS	% LUMINAIRE
0° - 20°	430	8%
0° - 30°	995	18%
0° - 40°	1792	33%
0° - 60°	3561	66%
0° - 80°	4824	89%
0° - 90°	5138	95%

**CONE OF LIGHT**

MOUNTING HEIGHT	FC AT BEAM CENTER	BEAM DIA. 0°-180°	BEAM DIA. 90°-270°
6.0 ft	30.8 fc	15.6 ft	0.0 ft
8.0 ft	17.3 fc	20.8 ft	0.0 ft
10.0 ft	11.1 fc	26.1 ft	0.0 ft
12.0 ft	7.7 fc	31.3 ft	0.0 ft
14.0 ft	5.7 fc	36.5 ft	0.0 ft
16.0 ft	4.3 fc	41.7 ft	0.0 ft
18.0 ft	3.4 fc	46.9 ft	0.0 ft
20.0 ft	2.8 fc	52.1 ft	0.0 ft

**INDOOR COEFFICIENTS OF UTILIZATION**

pf	20%																0%		
	80%				70%				50%				30%					10%	
pc																	0%		
pw	70%	50%	30%	10%	70%	50%	30%	10%	50%	30%	10%	50%	30%	10%	50%	30%	10%	10%	0%
0	118	118	118	118	115	115	115	115	108	108	108	103	103	103	98	98	98	95	0%
1	105	99	94	89	102	97	92	87	91	87	84	86	83	80	82	79	77	74	0%
2	94	85	77	70	91	83	75	69	78	72	67	74	69	64	70	66	62	60	0%
3	85	73	64	57	82	71	63	56	68	60	54	64	58	53	61	56	51	49	0%
4	77	64	55	47	75	63	54	47	59	52	45	56	50	44	54	48	43	41	0%
5	71	57	47	40	68	55	46	39	53	45	38	50	43	38	48	42	37	34	0%
6	65	51	41	34	63	49	40	34	47	39	33	45	38	32	43	37	32	29	0%
7	60	46	36	30	58	45	36	29	42	35	29	41	34	28	39	32	28	25	0%
8	56	41	32	26	54	40	32	26	39	31	25	37	30	25	35	29	24	22	0%
9	52	38	29	23	50	37	29	23	35	28	23	34	27	22	32	26	22	20	0%
10	48	35	26	21	47	34	26	21	32	25	20	31	25	20	30	24	20	18	0%