

OWP-FC-116-LED

LED Slimline Full Cut-Off Wall Pack Series

Catalog Number:

Project Name:

Note:

Type:

up to 30 Wattage / up to 4000 Lumens

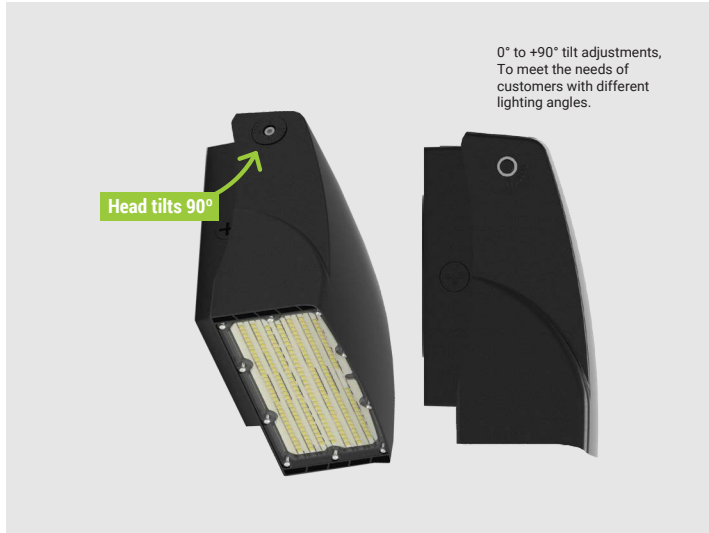

APPLICATIONS:

Slim wall pack is available for a variety of applications including building perimeter, entrances, stairways and security lighting. OWP series of luminaires provides a low profile architectural style with power of bright, energy efficient LEDs, Its has a rugged aluminum construction with multi-mount capabilities. 0° to +90° tilt adjustments. For a building that has a modern or futuristic look.

FEATURES:

Construction

Sealed die-casting profile for outdoor applications.
Suitable for applications requiring 3G testing prescribed by ANSI C136.31.

Optics

CCT Selectable 3000K/4000K/5000K.
Lumen Packages from 1500/2800/4000 Selectable Lumen output.
No UV or IR in the beam
Instant start, NO flickering, NO humming.

Electrical

Voltage (120-347V 50/60Hz)
Greater than 0.9 powerfactor, less than 20% harmonic distortion, and is suitable for operation in -40°C to 50°C ambient environments.

Lifespan

Estimated 50,000-hour LED lifespan based on IES LM-80 results and TM-21 calculations.

Warranty

Five-year warranty.

Applications

Security, pathway and perimeter lighting, Building entryways and walkways.



EASY 3 COLORS
SELECTOR
3000K • 4000K • 5000K

DIMENSION:

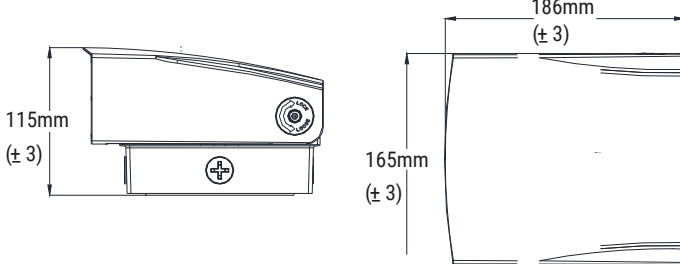

SPECIFICATIONS:

LUMENS	1500/2800/4000 lumens
WATTAGE	10W / 20W /30W
CCT	30K/40K/50K
CRI	70
DIMMING	0-10V Dimming
LIGHT EFFICIENCY	up to 135 lm/W
VOLTAGE	120-347 VAC
POWER FREQUENCY	50/60 Hz
FINISH	Bronze, Black
APPLICABLE ENVIRONMENT	Dry/Damp/Wet location
WORKING TEMPERATURE	-40°C to 50°C



Ordering Guide > Example: OWP-FC-116-LED-1500/2800/4000L-DIM10-120-347V-30K/40K/50K-BZ

OWP-FC-116-LED						
SERIES	PERFORMANCE	DIMMING	VOLTAGE	CCT	FINISH	ACCESSORIES
OWP-FC-116-LED	1500/2800/4000L	DIM10 - 0-10V dimming	120-347V	30K/40K/50K	BZ - Bronze BK - Black	PHC - Photocell MS - Motion Sensor



Submittal form is available @ www.iuseelite.com
Tel: 323-888-1973 • Fax: 323-888-1977

Specifications and Dimensions
subject to change without notice.

Issued-Rev.03-13-23