

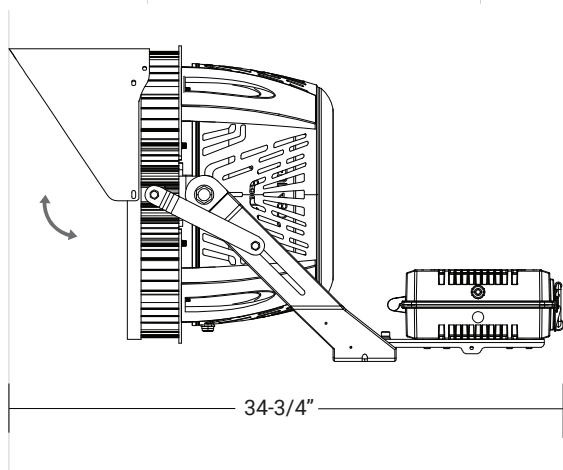

Rotate 355° Tilt 240°

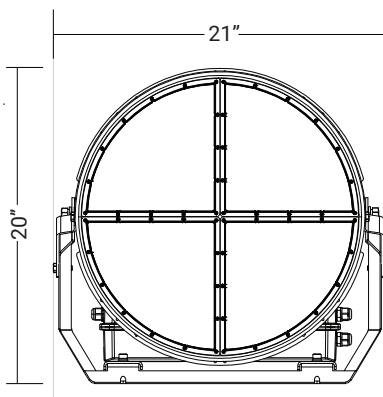

SERIES	DELIVERED LUMENS	WATTAGE
OSP-106-1200W	165000	1200W

Based on 5000K, >70 CRI. Actual wattage may vary +/- 5%



Introducing our versatile LED Sports Lighter, specifically engineered for large spaces including sports arenas, harbors, streets, and other expansive outdoor areas. With a focus on maximum illumination efficiency and unrivaled precision, this luminaire guarantees exceptional lighting performance. Its advanced heat-dissipating exterior ensures efficient thermal management, effectively extending the lifespan of the product. Illuminate your surroundings with unparalleled brilliance and reliability, making every space shine with confidence.

FEATURES

1. IP66 waterproof rating for exceptional performance in harsh weather conditions.
2. 5-year warranty provides long-term peace of mind and customer support.
3. Easy assembly and disassembly for convenient maintenance.
4. High-strength structure with corrosion-resistant polyester powder coating for enhanced durability.
5. Multiple beam angle options for customizable illumination.
6. Optional color temperature to suit specific needs and preferences.
7. Certified product meeting CE, RoHS, DLC, FCC, and UL standards.
8. Versatile application in stadiums, sports fields, high mast lighting, light towers, ports, and more.
9. Lighting Simulation service available for tailored lighting design.
10. Dimming control options include 0-10V, DMX, Dali, and Synapse.
11. Ambient operating temperature ranges from -40 - 122°F.

SERIES	LED Sports Lighter - 1200W
WATTAGE	1200W
EFFICIENCY	150lm/W
LUMINOUS FLUX	165,000Lm
CCT	3000K, 4000K, 5000K (Standard), 5700K, 6500K
BEAM ANGLE	Narrow Spot 15°, Spot 20°, Narrow Flood 25°, Flood 40°, Wide Flood 60°, Very Wide Flood 80°
NEMA TYPE	3 (20°), 4 (40°), 5 (60°)
CRI	70 (Standard), 80, 90
CONTROL	0-10V, DMX, Dali, Synapse.
VPR	10KV SPD (Standard), 20KV SPD

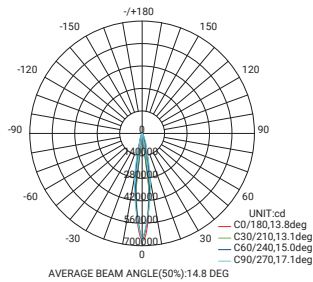
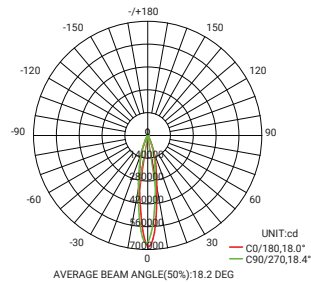
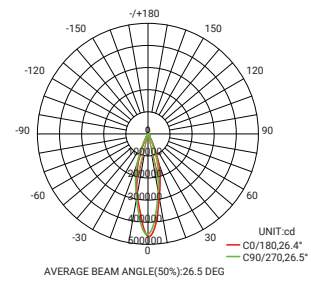
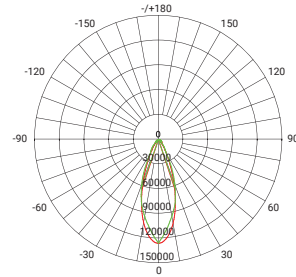
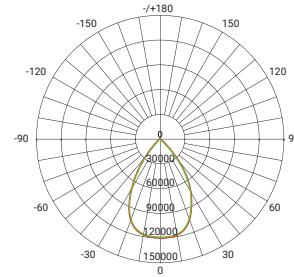
Narrow Spot (15°)

Spot (20°)

Narrow Flood (25°)

Flood (40°)

Wide Flood (60°)

Reference IES files for additional distribution curve information.

ELECTRICAL DATA:

PowerSupply	Input Voltage	Power Frequency	Output Voltage	Power Efficiency	Power Factor	Total Harmonic Distortion
INVENTRONICS	100-277 277-480	50/60Hz	DC24-48V	93%	0.95	<15%

OTHERS:

IP Rating	Lifetime (L70 Standard)	Heat Radiator	Lens Material	Carton Dimensions	Gross Weight	Net Weight
IP66	50,000 hours	Forging aluminum	PC	24.4"x22.4"x16.3"	60.6 lbs	50.7 lbs

EXAMPLE:

SERIES	VOLTGE	WATTAGE	BEAM ANGLE	CCT	CRI	CONTROL	VPR	ACCESSORY
OSP-106	<input type="checkbox"/> 100-277V <input type="checkbox"/> 277-480V	<input type="checkbox"/> 1200W	<input type="checkbox"/> NS=15° <input type="checkbox"/> SP=20° <input type="checkbox"/> NFL=25° <input type="checkbox"/> FL=40° <input type="checkbox"/> WFL=60° <input type="checkbox"/> VWFL=80°	<input type="checkbox"/> 30K <input type="checkbox"/> 40K <input type="checkbox"/> 50K <input type="checkbox"/> 57K <input type="checkbox"/> 65K	<input type="checkbox"/> 70 <input type="checkbox"/> 80 <input type="checkbox"/> 90	<input type="checkbox"/> 0-10V <input type="checkbox"/> DMX <input type="checkbox"/> Dali <input type="checkbox"/> Synapse	<input type="checkbox"/> 10KV <input type="checkbox"/> 20KV	<input type="checkbox"/> OSP-106-ACC-1-750-1250 <input type="checkbox"/> OSP-106-ACC-2-LAD

RADIATOR

The OSP series sports lighting utilizes fin heat sinks for improved heat dissipation, leading to a longer lifespan. The back cover acts as a cooling mechanism, efficiently dissipating heat generated by the power source. This design ensures optimal performance and durability.

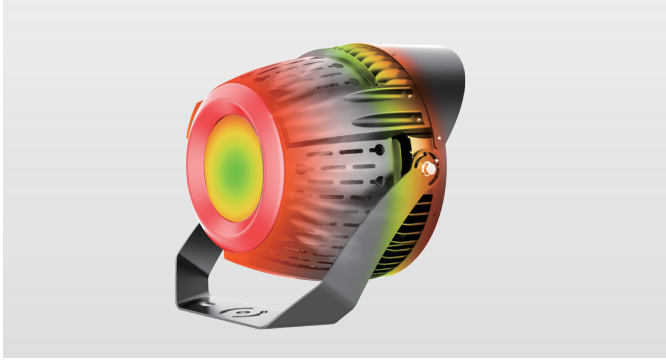

LASER AIMING DEVICES (OPTIONAL)

Our laser aiming device provides precise control for angling and aiming each sport light, allowing you to achieve the exact optimal position with ease and accuracy.

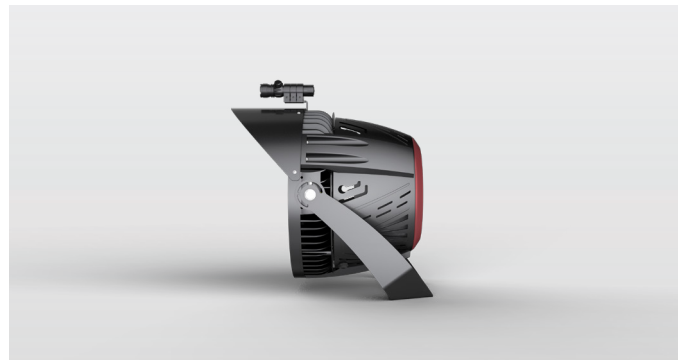

OSP-106-ACC-2-LAD

SLIP FITTER BRACKET (OPTIONAL)

The default mount yolk is included. The optional advanced slip fitter bracket offers a stable and compact footprint while allowing for rotation and tilt in various angles, providing the flexibility to position the sport light according to your specific requirements.



OSP-106-ACC-1-750-1250

OSP-106-1200W

TEST NO.: **EL06152321**

INPUT WATTS: **1183.7** LUMENS: **158741** EFFICACY: **134** BEAM ANGLE: **15** SPACING CRITERIA: **0.26 x 0.26**

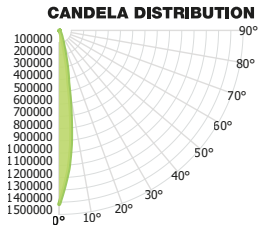

CANDELA TABLE			LUMINANCE (cd/sq.m)		LUMENS PER ZONE		ZONAL LUMEN SUMMARY				
0°		90°			0.00°	90.00°	ZONE	LUMENS	ZONE	UMENS	% LUMINAIRE
0°	1416617	1416617	0.00°	0	0		0° - 10°	79582	0° - 20°	128092	81%
10°	432575	443098	45.00°	0	0		10° - 20°	48511	0° - 30°	142616	90%
20°	66087	54026	55.00°	0	0		20° - 30°	14523	0° - 40°	148327	93%
30°	15593	12127	65.00°	0	0		30° - 40°	5711	0° - 60°	155044	98%
40°	5667	4778	75.00°	0	0		40° - 50°	3623	0° - 80°	158485	100%
50°	4208	3605	85.00°	0	0		50° - 60°	3095	0° - 90°	158741	100%
60°	3051	2702					60° - 70°	2261			
70°	1675	1520					70° - 80°	1180			
80°	606	532					80° - 90°	256			
90°	0	9									

CONE OF LIGHT

MOUNTING HEIGHT	FC AT BEAM CENTER	BEAM DIA. 0°-180°	BEAM DIA. 90°-270°
6.0 ft	39350.5 fc	1.7 ft	1.6 ft
8.0 ft	22134.6 fc	2.3 ft	2.2 ft
10.0 ft	14166.2 fc	2.8 ft	2.7 ft
12.0 ft	9837.6 fc	3.4 ft	3.3 ft
14.0 ft	7227.6 fc	4.0 ft	3.8 ft
16.0 ft	5537.7 fc	4.5 ft	4.4 ft
18.0 ft	4372.3 fc	5.1 ft	4.9 ft
20.0 ft	3541.5 fc	5.7 ft	5.5 ft

INDOOR COEFFICIENTS OF UTILIZATION

pf pc pw	20%																		0%						
	80%						70%						50%						30%						0%
	70%	50%	30%	10%	70%	50%	30%	10%	50%	30%	10%	50%	30%	10%	50%	30%	10%	0%							
	0%	0%	0%	0%	0%	0%	0%	0%	0%	0%	0%	0%	0%	0%	0%	0%	0%	0%							
0	119	119	119	119	116	116	116	116	111	111	111	106	106	106	102	102	102	100							
1	115	113	111	109	113	111	109	107	107	105	104	103	102	101	100	99	98	96							
2	111	107	104	102	109	106	103	101	103	100	98	100	98	96	97	96	94	93							
3	108	103	99	96	106	102	98	96	99	96	94	97	94	93	95	93	91	90							
4	104	99	95	92	103	98	94	92	96	93	90	94	92	89	92	90	88	87							
5	101	96	92	89	100	95	91	88	93	90	88	92	89	87	90	88	86	85							
6	99	93	89	86	98	92	88	86	91	87	85	90	87	84	88	86	84	83							
7	96	90	86	83	95	90	86	83	89	85	83	88	85	82	87	84	82	81							
8	94	88	84	81	93	87	84	81	87	83	81	86	83	81	85	82	80	79							
9	92	86	82	79	91	86	82	79	85	81	79	84	81	79	83	81	79	78							
10	90	84	80	78	90	84	80	78	83	80	78	82	79	77	82	79	77	76							

OSP-106-1200W

TEST NO.: **EL06152321**

INPUT WATTS: **1191.1** LUMENS: **165714** EFFICACY: **139** BEAM ANGLE: **20** SPACING CRITERIA: **0.29**

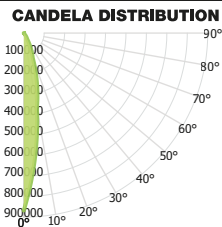

CANDELA TABLE			LUMINANCE (cd/sq.m)			LUMENS PER ZONE		ZONAL LUMEN SUMMARY		
0°		90°	0.00°		90.00°	ZONE	LUMENS	ZONE	UMENS	% LUMINAIRE
0°	868140	868140	0.00°	0	0	0° - 10°	52030	0° - 20°	111724	67%
10°	371387	480411	45.00°	0	0	10° - 20°	59694	0° - 30°	143494	87%
20°	129277	138108	55.00°	0	0	20° - 30°	31770	0° - 40°	154210	93%
30°	34154	36614	65.00°	0	0	30° - 40°	10716	0° - 60°	162163	98%
40°	8264	7971	75.00°	0	0	40° - 50°	4596	0° - 80°	165513	100%
50°	4987	4450	85.00°	0	0	50° - 60°	3357	0° - 90°	165714	100%
60°	3211	3063				60° - 70°	2238			
70°	1640	1687				70° - 80°	1112			
80°	581	635				80° - 90°	201			
90°	0	19								

CONE OF LIGHT

MOUNTING HEIGHT	FC AT BEAM CENTER	BEAM DIA. 0°-180°	BEAM DIA. 90°-270°
6.0 ft	24115.0 fc	1.8 ft	1.9 ft
8.0 ft	13564.7 fc	2.4 ft	2.5 ft
10.0 ft	8681.4 fc	3.1 ft	3.1 ft
12.0 ft	6028.7 fc	3.7 ft	3.8 ft
14.0 ft	4429.3 fc	4.3 ft	4.4 ft
16.0 ft	3391.2 fc	4.9 ft	5.0 ft
18.0 ft	2679.4 fc	5.5 ft	5.6 ft
20.0 ft	2170.3 fc	6.1 ft	6.3 ft

INDOOR COEFFICIENTS OF UTILIZATION

pf	20%																		0%
pc	80%						70%						30%						0%
pw	70%	50%	30%	10%	70%	50%	30%	10%	50%	30%	10%	50%	30%	10%	50%	30%	10%	10%	0%
0	119	119	119	119	116	116	116	116	111	111	111	106	106	106	102	102	102	102	100
1	114	112	110	108	112	110	108	106	106	104	103	102	101	100	99	98	97	95	95
2	110	106	102	99	108	104	101	98	101	98	96	98	96	94	95	93	92	90	90
3	105	100	96	93	104	99	95	92	96	93	90	94	91	89	92	90	88	86	86
4	102	95	91	87	100	94	90	87	92	89	86	90	87	85	89	86	84	83	83
5	98	91	86	83	96	90	86	83	89	85	82	87	84	81	86	83	81	79	79
6	95	87	83	79	93	87	82	79	85	81	78	84	81	78	83	80	77	76	76
7	91	84	79	76	90	83	79	76	82	78	75	81	78	75	80	77	75	74	74
8	89	81	76	73	88	81	76	73	80	76	73	79	75	72	78	75	72	71	71
9	86	78	74	71	85	78	73	70	77	73	70	76	73	70	76	72	70	69	69
10	83	76	71	68	82	75	71	68	75	71	68	74	70	68	73	70	68	67	67

OSP-106-1200W

TEST NO.: **EL06152321**

INPUT WATTS: **1206.8**

LUMENS: **167219**

EFFICACY: **139**

BEAM ANGLE: **25**

SPACING CRITERIA: **0.42**

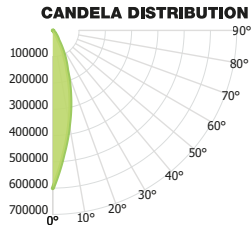

CANDELA TABLE

0°	90°
0° 600428	600428
10° 359838	343654
20° 159840	162501
30° 43327	43111
40° 9723	8549
50° 5298	4634
60° 3246	3067
70° 1619	1605
80° 580	579
90° 0	9

LUMINANCE (cd/sq.m)

0.00°	90.00°
0.00° 0	0
45.00° 0	0
55.00° 0	0
65.00° 0	0
75.00° 0	0
85.00° 0	0

LUMENS PER ZONE

ZONE	LUMENS
0° - 10°	40231
10° - 20°	62336
20° - 30°	39714
30° - 40°	12918
40° - 50°	5055
50° - 60°	3482
60° - 70°	2215
70° - 80°	1074
80° - 90°	193

ZONAL LUMEN SUMMARY

ZONE	UMENS	% LUMINAIRE
0° - 20°	102567	61%
0° - 30°	142281	85%
0° - 40°	155199	93%
0° - 60°	163736	98%
0° - 80°	167026	100%
0° - 90°	167219	100%

CONE OF LIGHT

MOUNTING HEIGHT	FC AT BEAM CENTER	BEAM DIA. 0°-180°	BEAM DIA. 90°-270°
6.0 ft	16678.6 fc	2.5 ft	2.3 ft
8.0 ft	9381.7 fc	3.4 ft	3.1 ft
10.0 ft	6004.3 fc	4.2 ft	3.9 ft
12.0 ft	4169.6 fc	5.1 ft	4.7 ft
14.0 ft	3063.4 fc	5.9 ft	5.5 ft
16.0 ft	2345.4 fc	6.7 ft	6.3 ft
18.0 ft	1853.2 fc	7.6 ft	7.0 ft
20.0 ft	1501.1 fc	8.4 ft	7.8 ft

INDOOR COEFFICIENTS OF UTILIZATION

pf	pc	pw	70%	50%	30%	10%	70%	50%	30%	10%	50%	30%	10%	50%	30%	10%	50%	30%	10%	0%
0	119	119	119	119	116	116	116	116	111	111	111	106	106	106	102	102	100	99	98	97
1	114	111	109	107	112	109	107	105	105	104	102	102	100	99	98	97	96	95	94	93
2	109	105	101	98	107	103	100	97	100	97	95	97	95	93	94	93	91	89	88	85
3	105	99	95	91	103	98	94	90	95	92	89	93	90	88	90	88	86	85	84	81
4	100	94	89	85	99	93	88	85	91	87	84	89	86	83	87	84	82	81	78	77
5	96	89	84	81	95	88	84	80	87	83	80	85	82	79	84	81	78	77	75	73
6	93	85	80	76	91	84	80	76	83	79	76	82	78	75	80	77	75	73	72	70
7	89	82	76	73	88	81	76	73	80	75	72	79	75	72	78	74	72	70	69	68
8	86	78	73	70	85	78	73	70	77	72	69	76	72	69	75	71	69	68	66	65
9	83	75	70	67	82	75	70	67	74	70	66	73	69	66	72	69	66	65	64	63
10	80	72	67	64	80	72	67	64	71	67	64	70	67	64	70	66	64	63		

OSP-106-1200W

TEST NO.: **EL06152321**

INPUT WATTS: **1206.5**

LUMENS: **166736**

EFFICACY: **138**

BEAM ANGLE: **40**

SPACING CRITERIA: **0.71**

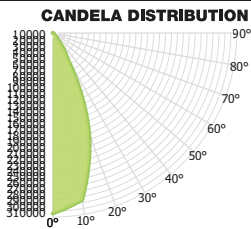

CANDELA TABLE

0°	90°
0° 303772	303772
10° 285256	287994
20° 179425	182622
30° 49783	46655
40° 10552	9139
50° 5308	4868
60° 3089	3018
70° 1491	1493
80° 526	513
90° 0	9

LUMINANCE (cd/sq.m)

0.00°	90.00°
0.00° 0	0
45.00° 0	0
55.00° 0	0
65.00° 0	0
75.00° 0	0
85.00° 0	0

LUMENS PER ZONE

ZONE	LUMENS
0° - 10°	27836
10° - 20°	64583
20° - 30°	47038
30° - 40°	14915
40° - 50°	5422
50° - 60°	3561
60° - 70°	2171
70° - 80°	1026
80° - 90°	184

ZONAL LUMEN SUMMARY

ZONE	UMENS	% LUMINAIRE
0° - 20°	92419	55%
0° - 30°	139457	84%
0° - 40°	154372	93%
0° - 60°	163356	98%
0° - 80°	166552	100%
0° - 90°	166736	100%

CONE OF LIGHT

MOUNTING HEIGHT	FC AT BEAM CENTER	BEAM DIA. 0°-180°	BEAM DIA. 90°-270°
6.0 ft	8438.1 fc	4.9 ft	4.7 ft
8.0 ft	4746.4 fc	6.5 ft	6.3 ft
10.0 ft	3037.7 fc	8.1 ft	7.8 ft
12.0 ft	2109.5 fc	9.7 ft	9.4 ft
14.0 ft	1549.9 fc	11.3 ft	11.0 ft
16.0 ft	1186.6 fc	13.0 ft	12.5 ft
18.0 ft	937.6 fc	14.6 ft	14.1 ft
20.0 ft	759.4 fc	16.2 ft	15.6 ft

INDOOR COEFFICIENTS OF UTILIZATION

pf	pc	pw	70%	50%	30%	10%	70%	50%	30%	10%	50%	30%	10%	50%	30%	10%	50%	30%	10%	0%
0	119	119	119	119	116	116	116	116	111	111	111	106	106	106	102	102	100	99	98	97
1	114	111	109	107	111	109	107	105	105	103	102	101	100	99	98	97	96	94	93	90
2	109	104	100	97	106	102	99	96	99	96	94	96	94	92	93	92	90	88	85	83
3	104	98	93	90	102	96	92	89	94	90	87	91	89	86	89	87	85	83	81	79
4	99	92	87	83	97	91	87	83	89	85	82	87	84	81	85	82	80	78	76	74
5	95	87	82	78	93	86	82	78	85	80	77	83	79	77	82	78	76	74	72	71
6	91	83	78	74	90	82	77	73	81	76	73	79	75	72	78	75	72	71	69	67
7	87	79	74	70	86	78	73	70	77	73	69	76	72	69	75	71	69	67	65	64
8	84	75	70	66	83	75	70	66	74	69	66	73	69	66	72	68	65	64	62	61
9	81	72	67	63	80	71	66	63	71	66	63	70	66	63	69	65	62	61	60	59
10	77	69	64	60	77	68	64	60	68	63	60	67	63	60	66	62	60	59		

OSP-106-1200W

TEST NO.: **EL06152321**

INPUT WATTS: **1188.2**

LUMENS: **162948**

EFFICACY: **137**

BEAM ANGLE: **60**

SPACING CRITERIA: **0.93**

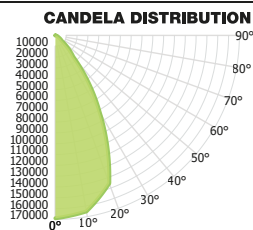

CANDELA TABLE

	0°	90°
0°	168931	168931
10°	165077	165705
20°	145404	147702
30°	81714	84293
40°	25800	27349
50°	7575	7782
60°	3430	3454
70°	1643	1622
80°	600	571
90°	0	8

LUMINANCE (cd/sq.m)

	0.00°	90.00°
0.00°	0	0
45.00°	0	0
55.00°	0	0
65.00°	0	0
75.00°	0	0
85.00°	0	0

LUMENS PER ZONE

ZONE	LUMENS
0° - 10°	15915
10° - 20°	44022
20° - 30°	51713
30° - 40°	30930
40° - 50°	11750
50° - 60°	4793
60° - 70°	2470
70° - 80°	1144
80° - 90°	210

ZONAL LUMEN SUMMARY

ZONE	UMENS	% LUMINAIRE
0° - 20°	59937	37%
0° - 30°	111650	69%
0° - 40°	142580	88%
0° - 60°	159123	98%
0° - 80°	162738	100%
0° - 90°	162948	100%

CONE OF LIGHT

MOUNTING HEIGHT	FC AT BEAM CENTER	BEAM DIA. 0°-180°	BEAM DIA. 90°-270°
6.0 ft	4692.5 fc	6.8 ft	6.7 ft
8.0 ft	2639.5 fc	9.1 ft	9.0 ft
10.0 ft	1689.3 fc	11.4 ft	11.2 ft
12.0 ft	1173.1 fc	13.7 ft	13.4 ft
14.0 ft	861.9 fc	16.0 ft	15.7 ft
16.0 ft	659.9 fc	18.2 ft	17.9 ft
18.0 ft	521.4 fc	20.5 ft	20.1 ft
20.0 ft	422.3 fc	22.8 ft	22.4 ft

INDOOR COEFFICIENTS OF UTILIZATION

	80%										20%										0%
	70%										50%										0%
pf																					0%
pc																					0%
pw	70%	50%	30%	10%	70%	50%	30%	10%	50%	30%	10%	50%	30%	10%	50%	30%	10%	50%	30%	10%	0%
0	119	119	119	119	116	116	116	116	111	111	111	106	106	106	102	102	102	102	102	100	
1	113	110	108	105	111	108	106	103	104	102	100	100	99	97	97	96	94	93	93		
2	107	102	98	94	105	100	96	93	97	94	91	94	91	89	91	89	87	85	85		
3	101	95	89	85	99	93	88	84	91	86	83	88	85	82	86	83	81	79	79		
4	96	88	82	78	94	87	82	77	85	80	76	83	79	76	81	77	75	73	73		
5	91	82	76	72	89	81	76	71	79	74	71	78	73	70	76	72	69	68	68		
6	86	77	71	66	85	76	70	66	75	69	66	73	69	65	72	68	65	63	63		
7	82	72	66	62	80	71	66	61	70	65	61	69	64	61	68	64	60	59	59		
8	78	68	62	57	76	67	61	57	66	61	57	65	60	57	64	60	57	55	55		
9	74	64	58	54	73	63	58	54	63	57	53	62	57	53	61	56	53	52	52		
10	70	60	54	51	69	60	54	50	59	54	50	58	54	50	58	53	50	49	49		