

 CUSTOM
COLORS

2" PROFILE

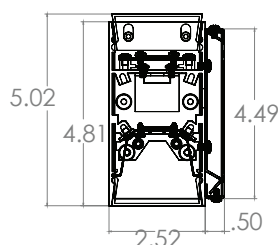
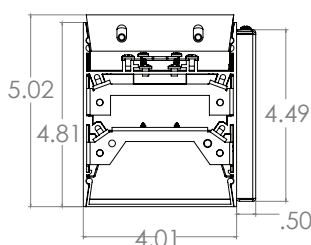
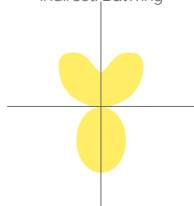
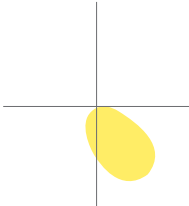
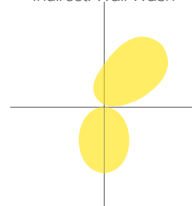
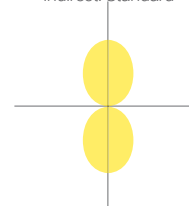

4" PROFILE

DIRECT			INDIRECT		
LUMENS/FT	ELITE	LUMENETIX	LUMENS/FT	ELITE	LUMENETIX
1000	9.5	10	1000	9.5	10
750	6.5	-	750	6.5	-
500	4.5	-	500	4.5	-

 Distribution Pattern:
 Direct: Standard
 Indirect: Batwing

 Distribution Pattern:
 Direct: Wall Wash

 Distribution Pattern:
 Direct: Standard
 Indirect: Wall Wash

 Distribution Pattern:
 Direct: Standard
 Indirect: Standard

DYNAMIC PLATFORM

SMART WHITE - Tunable White with Smart White technology allows the tuning of luminaires to mimic the natural color patterns throughout the day, enhancing interior office spaces, hospitality, and architectural elements. Tuning of intensity and color in classrooms enables a diversification in student activities, while the use of tunable white technology in healthcare stimulates circadian rhythm, accelerating the healing process. Complementing colors and textures in retail merchandising also has an impact on sales, utilizing the technology to adjust colors throughout the season. A CRI of 90+ is standard, and available on all three platforms. Elite Platform (50K-27K), Lumenetix Platform (80K-16K)

LUMENS PER FOOT	Direct & Indirect: Elite Platform: 500, 750, 1000 Lumenetix Platform: 1000Lt
CCT & DYNAMIC PLATFORMS	High Performance: TWH-50K-27K High Performance: TWH-65K-27K Lumenetix: TWH-LTX-80K-16K
CRI	90+ Standard
COLOR QUALITY	2 Step MacAdam Ellipses
WIDTHS	2", 4"
LENGTHS	2', 4', 6', 8', Custom
DISTRIBUTION PATTERNS	Direct: Standard, Wall Wash Indirect: Standard, Wall Wash, Batwing
CONFIGURATION PATTERNS & LENGTHS	Single, Continuous, L-Shape
MOUNTING	Wall
FINISH	WH (White), BK (Black), SI (Silver), Custom RAL
DIMMING & CONTROLS	0-10V Flicker Free 1% Dimming (DIM10), DMX-512 DMX-RDM, BLE, LUTH, DALI, DLM
EMERGENCY	10W - Up to 1000L Output (Bodine BSL310) 20W - Up to 2000L Output (Bodine BSL20)
LIFETIME	L70 at 50,000 Hours
PHOTOMETRIC TESTS	In Accordance with IES LM79-08, LM80 and TM-30, TM-21



FEATURES

FLEX Architectural LED Wall Mount Linear is "Performance Designed for You", combining the ultimate in flexibility and creativity, with continuous, uniform and glare-free illumination. Available in any combination of direct, indirect, and wall wash, with continuous mounting and fully illuminated corners for a seamless connection from luminaire to luminaire, in a variety of formed angles and shapes. Be inspired to create a long-lasting impression with a unique design that complements corporate offices, educational, commercial, and retail spaces.

OPTICS & PERFORMANCE

Fabricated from 20-gauge aluminum, with mitered corners, and post-painted with 95% reflective premium paint. The optical system delivers high efficiency LED light that passes through a high quality acrylic lens for optimal distribution patterns, creating a glare-free and even distribution. Distributions include Direct (Downlight), Indirect (Uplight) or Wall Wash, with zero light leakage.

CONSTRUCTION

One-piece rigid aluminum extrusion, made of T6063-T5 aluminum, with cast aluminum end caps. A precision cut, smooth white extruded frosted lens with snap in design attaches firmly into the grooves of the body and can be easily removed for access to the driver and LED boards.

For indirect distribution, the lens can be installed flush against the luminaire, or extended off the surface of the luminaire, creating a soft glow of illumination.

OPTICAL ASSEMBLY

Reflector is fabricated from 20-gauge aluminum, and post-painted finish with 95% reflective premium paint. Wall Wash reflectors are positioned at an angle.

DISTRIBUTION PATTERNS & DIFFUSER

Standard Distribution: A high-quality, smooth white frosted efficient acrylic lens is shipped standard for optimal distribution patterns, for most applications, and provides glare-free, even illumination.

Wall Wash Distribution: Illuminates from the ceiling, down, for uniform vertical illumination.

SMART WHITE

High Performance platform with a tuning range of 5000K to 2700K (TWH-50K-27K).

Control via DIM10 (0-10V), ELITE-CONNECT 0-10V, LUTRON, DMX512-RDM, DALI

LUMENETIX (Araya5 Module) platform with tuning range of 8000K to 1650K (TWH-LTX-80K-16K). For simple deployment, Lumenetix platform allows up to five scenes to be pre-programmed into the module and recalled at the venue using a 0-10V. Lumenetix App. Commissioning of the module and re-programming of Scenes are done via the wireless Lumenetix App Via Smartphone that connects to the embedded radio.

Control via DIM10, DMX512-RDM, LUTH (Lutron T Series 2 Channel Tunable White), BLE, DALI, DLM.

LUMINAIRE CONTROL

Luminaire can be pre-wired for independent 2-circuit control of uplight, downlight, or 1-circuit control for combined up/downlight.

CRM INSTALLATION

For continuous row mounting, the first luminaire in the row will always be the power supply feed. After plugging in the male and female harnesses, which are supplied with each luminaire, they will easily slide together, then secured with two screws from opposite directions in the connecting brackets.

DRIVER ELECTRICAL INFORMATION

Powered by high-quality constant-current power LED drivers which are rated for 50 to 60Hz at 120-277V input, produce less than 20% THD, and have a power factor of .90 to 1.00. Male and female 18-gauge 6 wire plug connectors are included with every luminaire to allow for simple hassle-free continuous wiring, and each luminaire must be installed male to female.

WARRANTY

Five-year warranty for parts and components. (Labor not included)

LISTINGS

c-UL-us - Listed for Feed Through Wiring.

All LED luminaires are rated and tested to LM-79 and LM-80 standards by an independent laboratory.





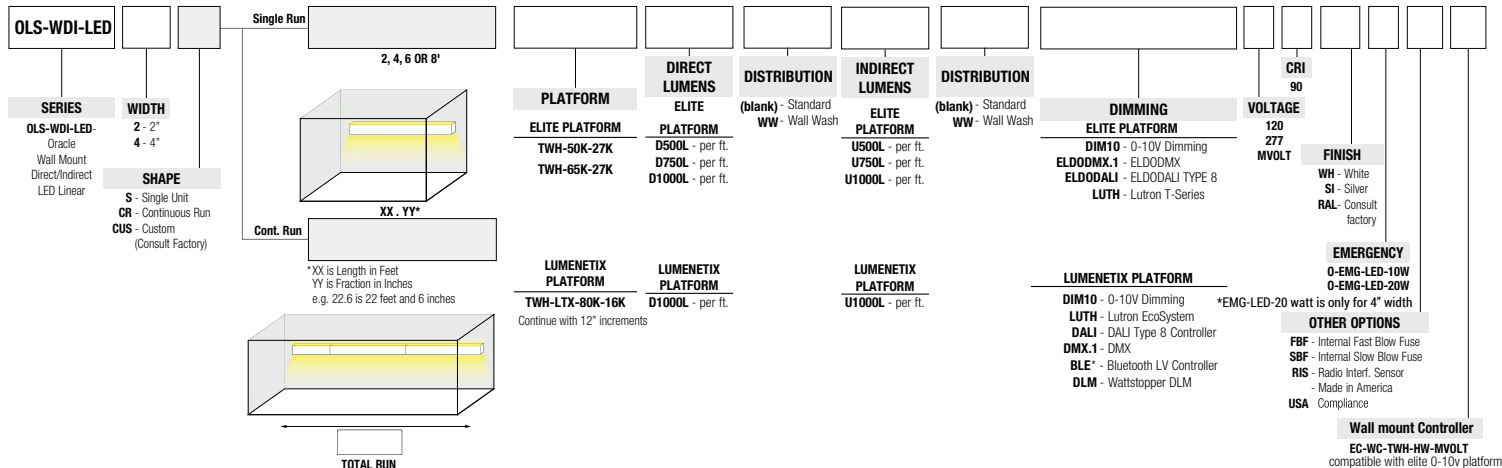

Example: **OLS-WDI-LED-2-CR24-TWH-50K-27K-D500L-U500L-DIM10-MVOLT-WH**



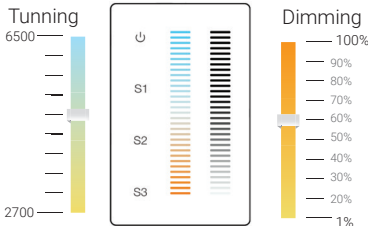

CONTROL OPTIONS

With the integration of controls, Elite Lighting now offers its products with controls-ready performance that increases energy efficiency, smarter space planning, and the enhancement of safety and productivity in the workplace. By utilizing these controls, Elite Lighting luminaires enable your customer's facility to run smarter, with the use of an easily controlled system through any platform.

CONTROL PROTOCOLS	SMART WHITE	LUMENETIX
<p>ELITE-CONNECT (EC-WC-TWH-HW-MVOLT) - Hard-wired, 0-10V, 120/277V wall mounted controller for CCT Tuning and Intensity Dimming through Simple Touch screen pad, provided by Elite Lighting. Programmable for up to 3-scenes, with a dimming range down to 1%. Applicable for office spaces, hospitality, educational, healthcare, and retail merchandising.</p> 	✓	N/A
<p>DIM10 (0-10V 1% Dimming Standard) In order to Control the Color Tuning and dimming option with 0-10V driver you must dedicate two control inputs, one for the Dimming Control and another for CCT Tuning. It can be dimmed and tuned with 2 wall box dimmers and compatible with most control systems and/or daylight harvesting systems.</p> <p>DIM10-LUTRON Compatible with Lutron GRAFIK Eye QS or GRAFIK Eye 3000 by using two GRX-TVI Lutron 0-10V Dimming interfaces; one to tune and another to control dimming. Also compatible with Lutron VIVE system by using two FCJS-010 PowPak or FCJS-ECO EcoSystem PowPak modules per luminaire; one to tune and one to control dimming.</p> 	✓	✓
<p>DMX (Available on Elite, LED Engin and Lumenetix platforms) - Compatible with Digital Multiplex Controller, Available with two options; DMX-512: Standard DMX Controller and DMX-RDM: DMX Controller with Remote Device Management.</p>	✓	✓
<p>LUTEKO Compatible with Lutron EcoSystem. Compatible with Lutron GRAFIK Eye EcoSystem, Lutron Energi Saver node EcoSystem, or Lutron Quantum systems.</p>	✓	✓
<p>DALI Compatible with Digital Addressable Lighting Interface, available with two options: DT6 and DT8.</p>	✓	✓



TWH-50K-27K

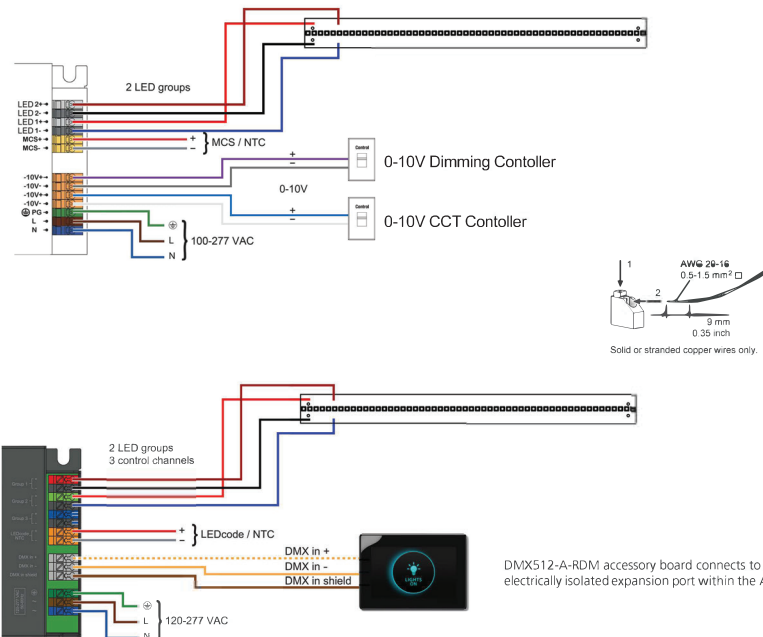

TWH Controller EC-WC-TWH-HW-MVOLT

Wiring Diagram:

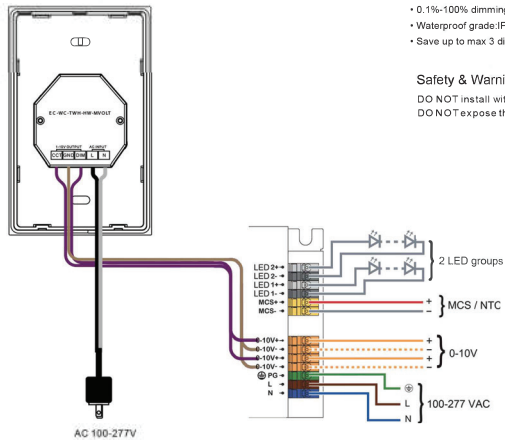

- 100-277VAC input.
- Touch slide tunable white and brightness control.
- 2 channels 1-10V signal output.
- 0.1%-100% dimming.
- Waterproof grade:IP20.
- Save up to max 3 different colors.

Safety & Warnings:
DO NOT install with power applied to device.
DO NOT expose the device to moisture.

Output Signal	2x(1-10V) signal
Power Supply	100-277VAC
Power consumption	30 mA max
Operating temperature	0-40°C
Relative humidity	8% to 80%
Dimensions	75x120x40.8mm

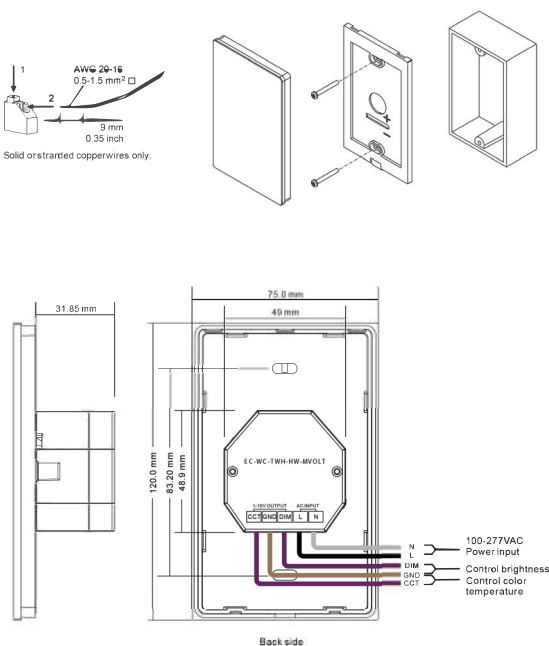
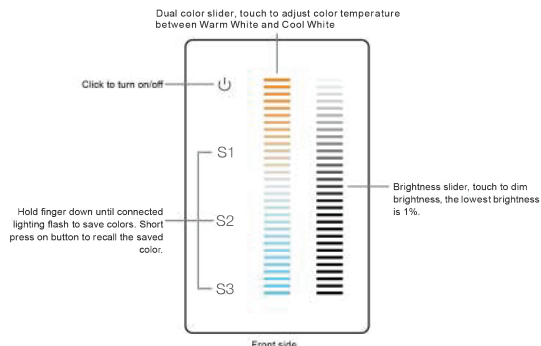



TWH-LTX-80K-16K

0-10V

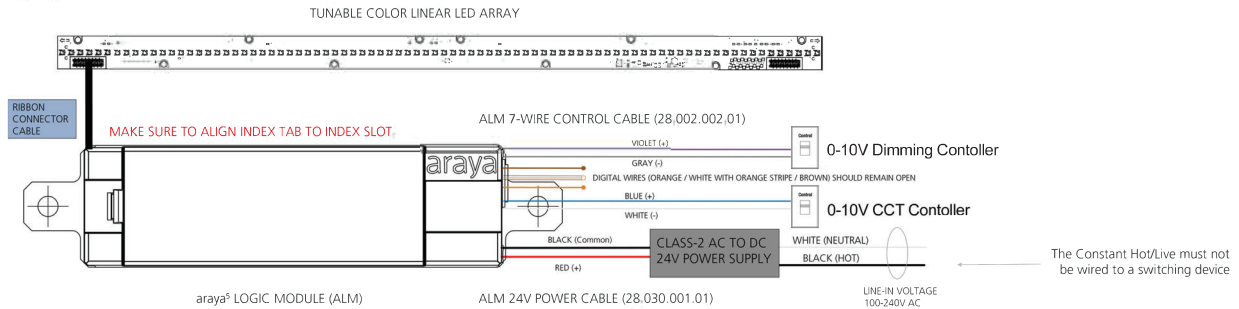

LUTRON

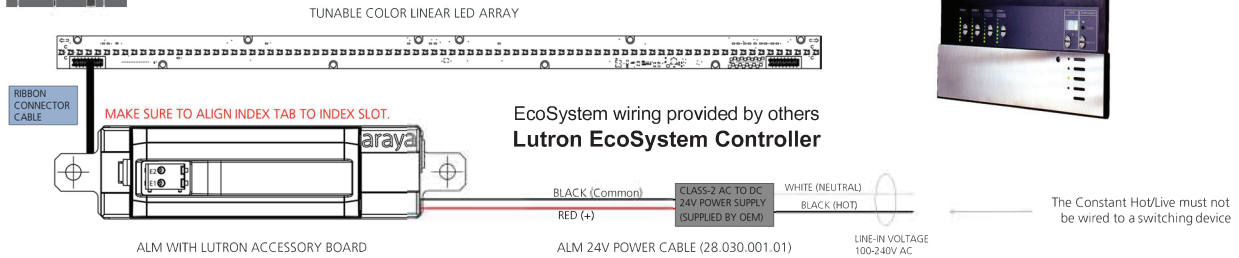

DMX

