

SUGGESTED USE

For areas where smooth and wide light distribution is needed. Ideal for building facades, security, recreation facilities, parking lots, signs, and displays.

CONSTRUCTION

Stainless steel corrosion-proof housing with PVC sleeve. The one-piece silicone gasket effectively limits outside contaminants by sealing off the optical chamber.

LENS - Clear, heat- and impact-resistant tempered glass lens.

LAMP/WATTAGE - 90W incandescent or 20W LED.

All specifications are subject to change without notice



Dimensions:

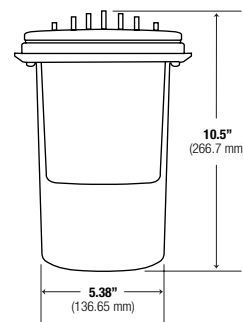
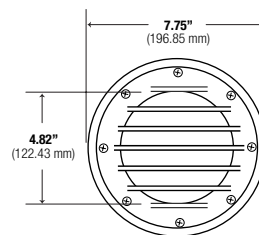

Ordering Guide > Example: OIWL-201-PAR38-20W-LED-120-CL

OIWL-201

SERIES

OIWL-201 - Oracle
In-Ground Well Light

LAMP TYPE/WATTAGE

PAR38
(90W Incandescent)
(20W LED)

VOLTAGE

120

COLOR

BZ - Bronze
BK - Black
GG - Garden Green