

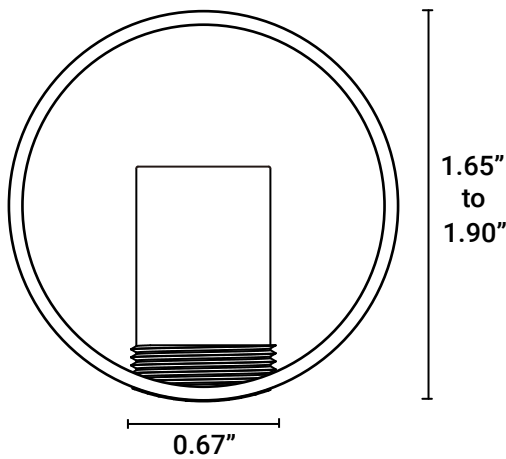

M18 DOT MODULES

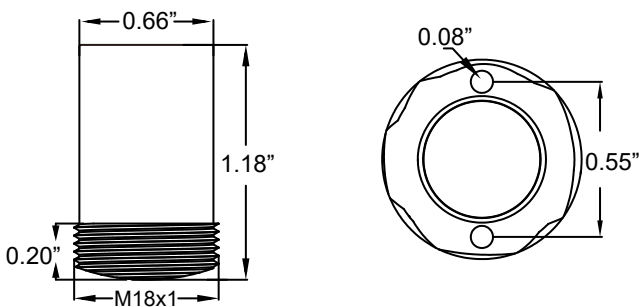

Dimensions



FEATURES

The M18 Dot Modules provide precise step illumination with controlled downward light that helps define step edges and improve visibility along paths of travel. Built from 316L stainless steel, each module combines a low-profile appearance with dependable performance in demanding environments. Four distinct beam options allow light to be directed where it's needed most. The result is a clean, subtle lighting solution that complements both contemporary and traditional architectural settings.

LUMENS	77L - 125L
CCT	27K - 60K/Amber/Blue/Green
DIMMING	Fixed Output
CRI	90+ CRI
VOLTAGE	24v DC - Constant Voltage
IP RATING	IP 67
BEAM PATTERNS	40°/55°/Asymm. 35°/Asymm. 55°
WORKING TEMPERATURE	-4° F to 113° F
LIFETIME	50,000 hours LED lifespan



OPTICS

The M18 Dot Module is designed to deliver precise, controlled illumination from a compact point source. Four beam options—40°, 55°, 55° asymmetric, and 35° x 25° asymmetric—allow light to be tailored to the application, from broader step visibility to more focused directional throw. Symmetric beam distributions provide even downward illumination, while asymmetric options help push light forward across walking surfaces, improving visibility along stairs, ramps, and pathways without unnecessary spill. M18 modules are ideal for handrails, awnings, canopies, trellises, and other architectural elements where discreet, targeted illumination is required.

CONSTRUCTION

M18 Dot Modules are constructed from 316L stainless steel for long-term durability, corrosion resistance, and dependable performance in demanding outdoor environments. Each module includes a silicone O-ring gasket seal to help protect against moisture and environmental exposure.

INSTALLATION

M18 Dot Modules are designed for quick installation into round handrails and other curved architectural surfaces. Each module installs through an M18 x 1.0 threaded opening, with optional installation tools for fast setup, including an M18 x 1 drill tap and 16 mm annular hole cutter. For added tamper resistance, thread-lock may be applied to the threads during installation. The system is compatible with standard Ø42–48 mm handrails with wall thicknesses from 1.5–2 mm.

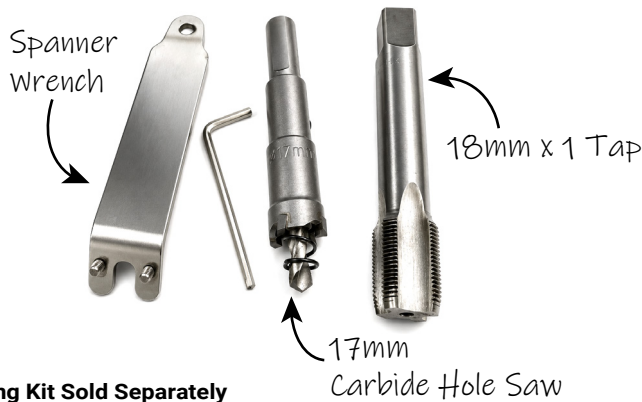

*Drilling Kit Sold Separately

DRIVERS

Power is provided by means of industry leading constant voltage LED drivers rated for universal power input from 120V to 277V at a frequency of 50-60Hz. Elite drivers produce less than 20% THD, and have a power factor of .90 to 1.00.

LISTINGS

UL Listed for Wet Location

cULus Listed for Wet Location

FCC 15 - EMI/RFI emission per FCC 47CFR part 15 at 120VAC or 277VAC

RoHS - Contains no mercury or lead and RoHS compliant

Photometric testing completed in accordance with IES LM-79 and TM-30 standards with calculated Life Time: L70 at 200,000 Hours

Qualifies for California Title 24 high-efficacy LED compliance

WARRANTY

Five-year warranty for parts and components (labor not included).

MOD-M18-LED					
SERIES	OPTICS	POWER	CCT (90 CRI)	DRILLING KIT	DRIVER
M18-M18 Dot Round Profile	R40 - Symmetric 40° R55 - Symmetric 55° RA55 - Asymmetric 55° RA35 - Asymmetric 35°x25°	1.2 - 1.2 Watt	27K - 2700K 30K - 3000K 35K - 3500K 40K - 4000K 50K - 5000K 60K - 6000K AMB - Amber 590nm BL - Blue GR - Green	DK - Hole Saw + Accessories	30W - 30 Watt 60W - 60 Watt 96W - 96 Watt

Photometric Data

Symmetric

M18 MODULES
4000K | 90 CRI | 24V

LED MODULE	BEAM ANGLE	LUMENS (lm)	POWER (W)
R40	40°	110	1.2
R55	55°	125	1.2



MOD-M18-LED-R40

1	2	2	2	2	2	2	2	2	1
2	5	6	6	6	6	6	6	5	2
5	31	35	35	35	35	35	35	31	6
5	31	35	35	35	35	35	35	31	6
2	5	6	6	6	6	6	6	5	2
1	2	2	2	2	2	2	2	2	1

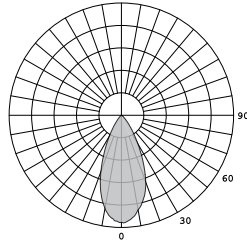

40° Spot

Rail Height: 36"
Module Spacing 1.0 ft.

MOD-M18-LED-R55

2	3	3	3	4	4	3	3	2	2
5	8	10	10	10	10	10	10	7	4
9	17	22	23	24	24	23	21	15	7
10	19	25	26	27	27	26	24	18	8
5	10	12	13	13	13	12	11	9	4
2	3	4	4	4	4	4	3	3	2

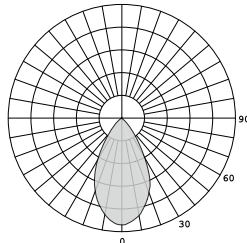

55° Spot

Rail Height: 36"
Module Spacing 1.0 ft.

Asymmetric

M18 MODULES
4000K | 90 CRI | 24V

LED MODULE	BEAM ANGLE	LUMENS (lm)	POWER (W)
RA55	55°	95	1.2
RA35	35°x25°	77	1.2



MOD-M18-LED-RA55

1	1	1	2	2	2	1	1	1	1
2	2	3	3	3	3	3	3	2	1
5	8	10	10	10	10	10	10	7	3
7	12	16	17	17	17	17	15	11	6
6	10	14	15	15	15	14	13	9	5
4	7	8	9	9	9	8	8	5	3

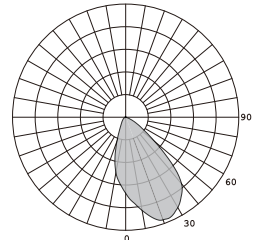

Asymm. 55°

Rail Height: 36"
Module Spacing 1.0 ft.

MOD-M18-LED-RA35

1	2	2	2	2	2	2	2	1	1
2	3	3	3	3	3	3	3	3	2
3	8	9	10	10	10	10	9	8	3
6	19	22	23	23	23	23	22	18	5
4	12	15	15	16	16	15	15	12	4
2	4	5	6	6	6	6	5	4	2

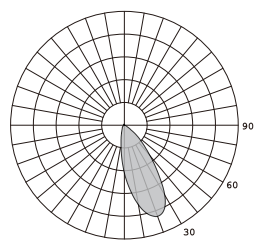

Asymm. 35°x25°

Rail Height: 36"
Module Spacing 1.0 ft.

LED Module Installation & Removal:

1 M18 x 1.0
Ø0.67"

2 Rotate 7 times counterclockwise

3 After applying anaerobic adhesive, Turn clockwise 7 turns

4 Rotate till two holes to the axis of the handrail

5 Fix the M18 on the steel pipe with adhesive tape, After the thread glue is dry, Tear off the tape

6

Instructions

1. Drill and tap a Ø0.67" hole with an M18 x 1.0 thread tap.
2. Insert the module and rotate it 7 turns counterclockwise.
3. Apply anaerobic adhesive, then turn the module 7 turns clockwise to secure it.
4. Rotate the module until the two holes are aligned with the axis of the handrail.
5. Hold the M18 fitting in place with adhesive tape until the thread glue dries, then remove the tape.
6. Confirm the module is fully seated and properly aligned in the handrail.