

**LB8000-16-ST Series**  
**Outdoor Tape Light**  
**Width / 0.62"**  
**Height / 0.66"**  
**IP68**



**FEATURES**

The LB8000-16-ST Lumi-PRO Strip Light is an **extremely easy-to-operate, dual-bending flex neon linear lighting solution** designed for both indoor and outdoor applications. The LB8000-16-ST Lumi-PRO Strip Light can be top-bent and side-bent, making it easy to fix on curved and complex irregular structures. It offers a color temperature range of **3000K, 4000K, and 5000K**, providing flexibility to create the desired ambiance and lighting effects in various **indoor or outdoor spaces**.

Designed for easy installation, the **LB8000-16-ST Lumi-PRO Strip Light** can be mounted on different surfaces, such as **walls, ceilings, or furniture**, using adhesive backing or mounting brackets.

Max run up to 33ft

Outdoor/Wet Location (IP68)

**Linear lighting**

Top/Side Bending

**Warranty:** 5 years for indoor and 3 years for outdoor limited warranty

**Color Temp.** **4.7 W/ft.**

3000K	255 lm/ft
3500K	260 lm/ft
4000K	260 lm/ft
5000K	270 lm/ft

**MOUNTING TRACK**

**FNC-1617-5**



Bending Aluminum Track  
19" length

**FNC-1617-1**



Bending Aluminum Track  
39" length

**BENDING RADIUS**

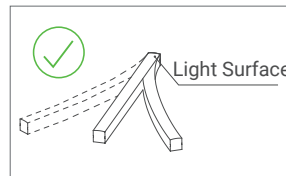

Side Bend / Min. 9.8" (250mm)

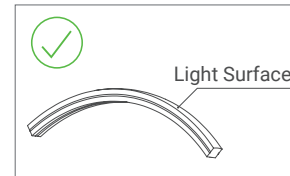

Top Bend / Min. 3.9" (100mm)

**TECHNICAL DETAILS**

Power	4.7W/ft
Voltage	24V
CRI	80+
IP	IP68
LED Qty	30/ft
Max Run(ft)	33ft
Cutting Length	2.5"
Dimensions	W0.62" X H0.66"
Working Temp.	-4F / +122F

Experience **unparalleled** performance with our precision-engineered, high-quality **Lumi-PRO LB8000-16-ST Outdoor LED Strip Light**, meticulously designed to meet the demands of the **most challenging applications**.

**DIMENSIONS**

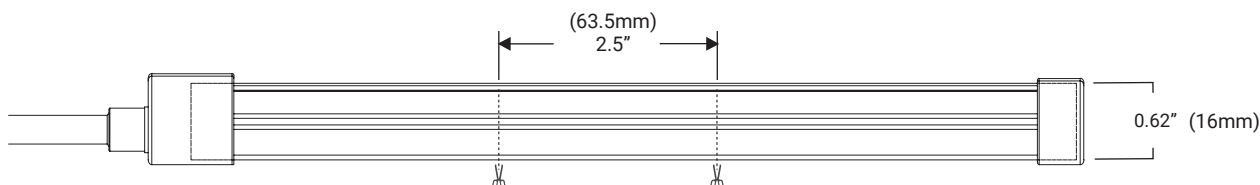

## Accessories

**LB8000-16-CH-FL-BR**

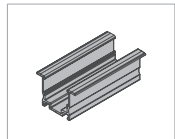

Extruded Channel  
flanged bracket

1.3"x0.7"x0.8"

**LB8000-16-CH-BR**

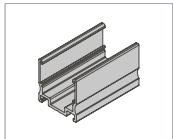

Extruded Channel  
flangeless bracket

1.3"x0.7"x1.1"

**LB8000-16-CH**

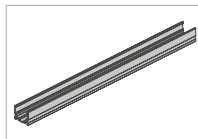

Extruded channel  
flangeless

39"x0.7"x0.8"

**LB8000-16-CH-FL**

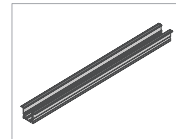

Extruded channel  
flanged

39"x0.7"x1.1"

**LB8000-16-EC**



Silicone end cap

0.7"x0.7"x0.74"

**LB8000-16-EC-PF-EF**



Silicone end cap  
power feed

1.1"x0.7"x0.7"

**LB8000-16-EC-PF-BF**



Silicone end cap Side  
bottom power feed

0.9"x1.1"x0.7"

## ORDERING SELECTION

Example: **LB8000-16-ST-4.7W-33F-30K-24V**

LB8000-16-ST					
SERIES	WATTAGE	LENGTH	CCT	VOLTAGE	MOUNTING TRACK
<b>LB8000-16-ST</b>	<b>4.7W</b> - 4.7W/ft	<b>33F</b> -33ft / Roll	<b>30K</b> - 3000K <b>35K</b> - 3500K <b>40K</b> - 4000K <b>50K</b> - 5000K	<b>24V</b> - 24V	<b>FNC-1617-5</b> - Bending Aluminum Track 19" length  <b>FNC-1617-1</b> - Bending Aluminum Track 39" length

### ACCESSORIES

- LB8000-16-CH-FL-BR** - Flanged bracket
- LB8000-16-CH-BR** - Flangeless bracket
- LB8000-16-CH** - Extruded channel flangeless
- LB8000-16-CH-FL** - Extruded channel flanged
- LB8000-16-EC** - Silicone end cap/end
- LB8000-16-EC-PF-EF** - Silicone end cap/power feed
- LB8000-16-EC-PF-BF** - Silicone end cap/side bottom power feed

### CONTROLLERS

- LB-2830A** - RF single color controller
- LB-2833-K5-MONO** - RF single color dimmer
- LED25W-24** - Power supply
- LB-1009EAWI** - RF+WiFi receiver

**Triac-Phase Cut/Triac ELV/0-10V/1-10V PWM/Potentiometer (5 in 1) Dimmable**

**PN: ED-30W-24V-TRIAC/DIM10**

Model	Input Voltage	Output Voltage	Wattage	Max. Output current	Frequency	Location	Certificate
ED-30W-24V-TRIAC/DIM10	100-277VAC	24V	30W	1.25A	50/60Hz	Dry, Damp, and Wet locations	UL, cUL, FCC, Class 2, RoHS

**Dimensions**

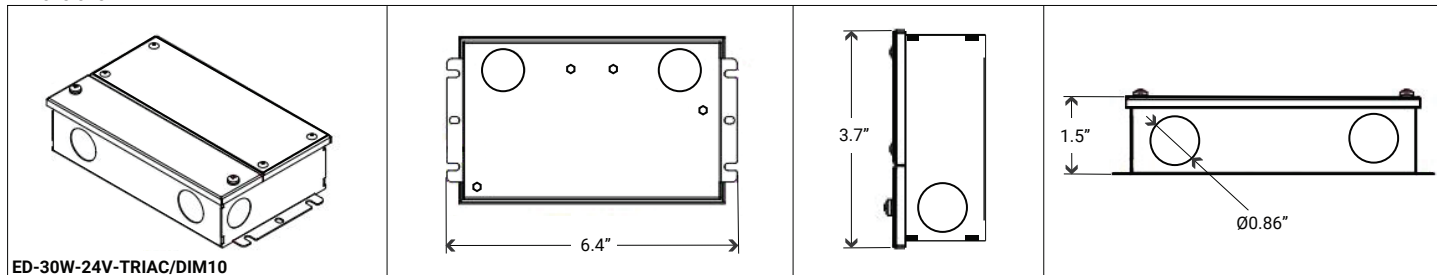

**PN: ED-60W-24V-TRIAC/DIM10**

Model	Input Voltage	Output Voltage	Wattage	Max. Output current	Frequency	Location	Certificate
ED-60W-24V-TRIAC/DIM10	100-277VAC	24V	60W	2.5A	50/60Hz	Dry, Damp, and Wet locations	UL, cUL, FCC, Class 2, RoHS

**Dimensions**

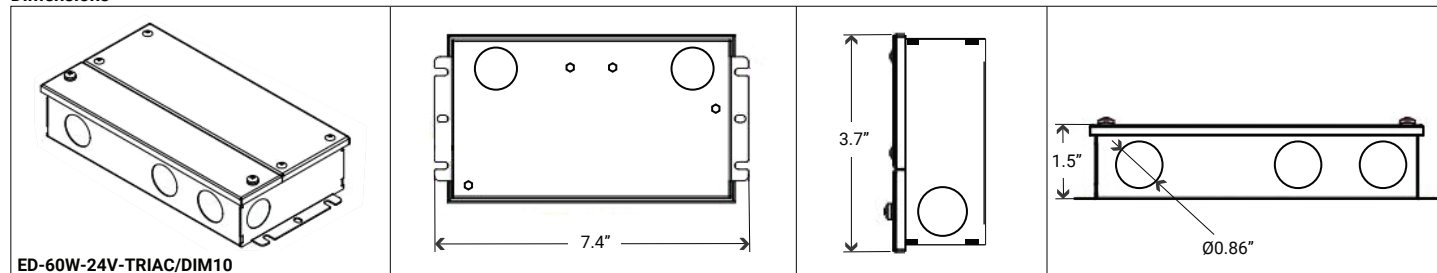

**PN: ED-96W-24V-TRIAC/DIM10**

Model	Input Voltage	Output Voltage	Wattage	Max. Output current	Frequency	Location	Certificate
ED-96W-24V-TRIAC/DIM10	100-277VAC	24V	96W	4A	50/60Hz	Dry, Damp, and Wet locations	UL, cUL, FCC, Class 2, RoHS

**Dimensions**

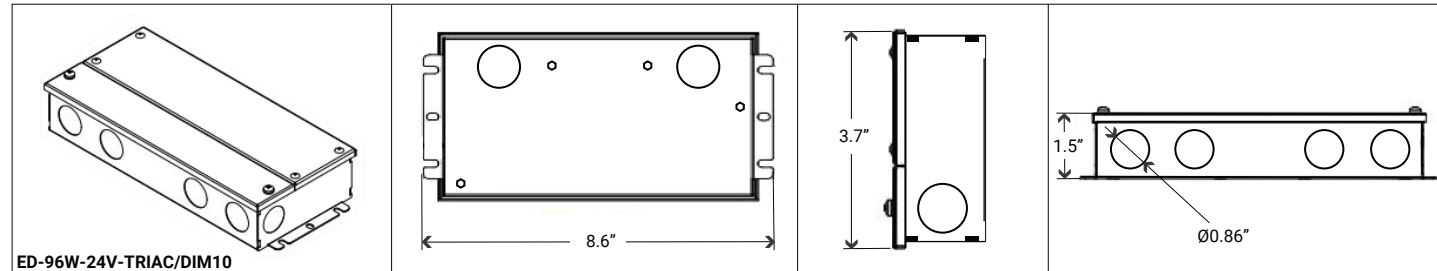

**Triac-Phase Cut/Triac ELV/0-10V/1-10V PWM/Potentiometer (5 in 1) Dimmable**

**PN: ED-192W-24V-TRIAC/DIM10**

Model	Input Voltage	Output Voltage	Wattage	Max. Output current	Frequency	Location	Certificate
ED-192W-24V-TRIAC/DIM10	100-277VAC	24V	192W	Multi 2X96W	50/60Hz	Dry, Damp, and Wet locations	UL, cUL, FCC, Class 2, RoHS

**Dimensions**

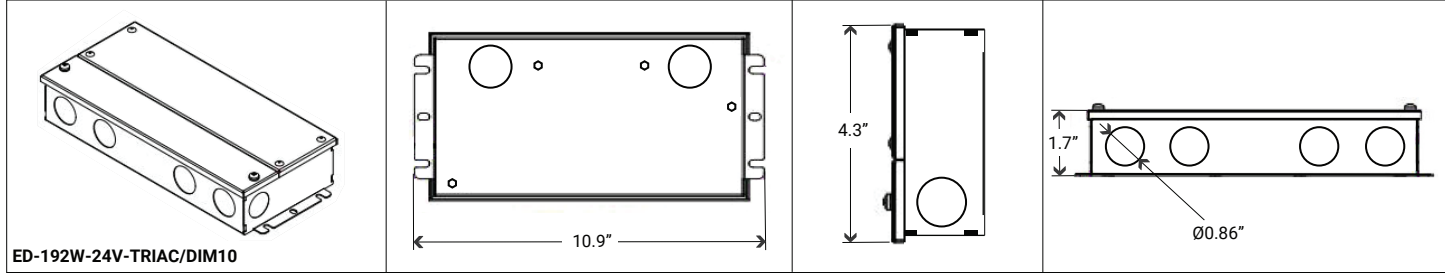

**PN: ED-288W-24V-TRIAC/DIM10**

Model	Input Voltage	Output Voltage	Wattage	Max. Output current	Frequency	Location	Certificate
ED-288W-24V-TRIAC/DIM10	100-277VAC	24V	288W	Multi 3X96W	50/60Hz	Dry, Damp, and Wet locations	UL, cUL, FCC, Class 2, RoHS

**Dimensions**

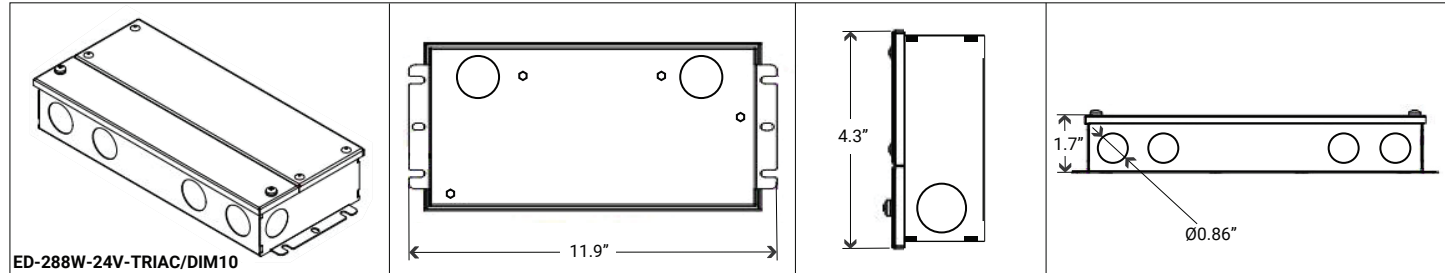

**PN: ED-384W-24V-TRIAC/DIM10**

Model	Input Voltage	Output Voltage	Wattage	Max. Output current	Frequency	Location	Certificate
ED-384W-24V-TRIAC/DIM10	110-277VAC	24V	384W	Multi 4X96W	50/60Hz	Dry, Damp, and Wet locations	UL, cUL, Class 2, RoHS

**Dimensions**

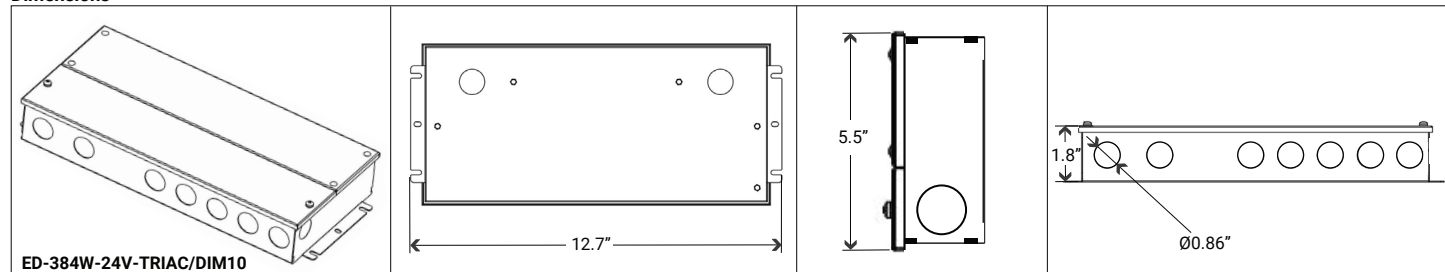

## Dimming Operation and Connecting Diagram

- **Using two ways of dimming at the same time**, you must be assured that LED lighting is up to the max. Brightness then you could operate with the other dimming;

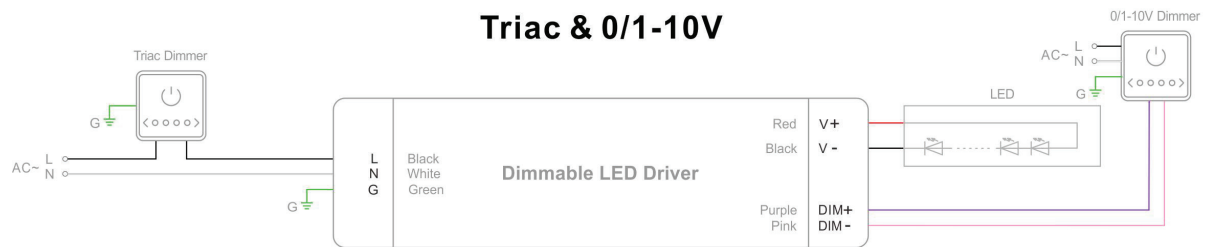

- **Using one dimming ---TRIAC/Phase cut dimming**

1. The Pulse-Width Modulation (PWM) of output voltage can be adjusted through input terminal of the AC phase line(L) by connection a phase /Triac dimmer or lighting system.
2. Working with forward phase, MLV and Reverse phase , ELV, TRIAC dimmers or light system.
3. Min. loading is about 10%
4. Please try to use dimmers with power at least 1.5 times as the output power of the driver.

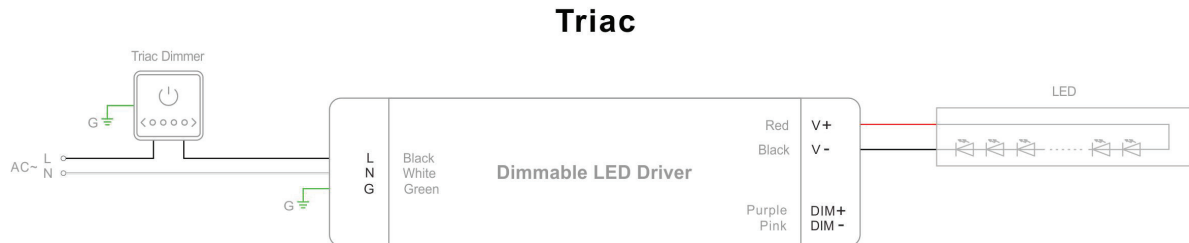

- **Using one dimming ---0-10/ 1-10V/ 10V PWM/ Potentiometer dimming**

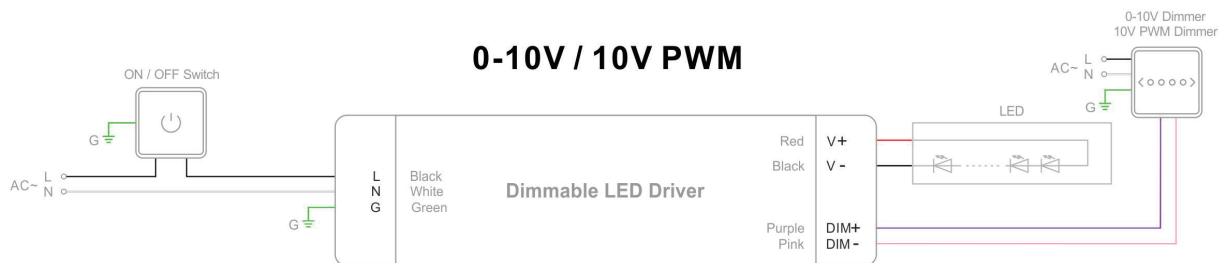

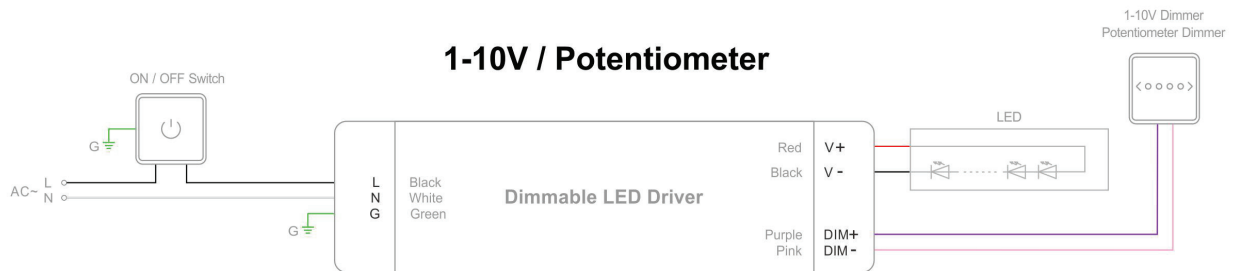
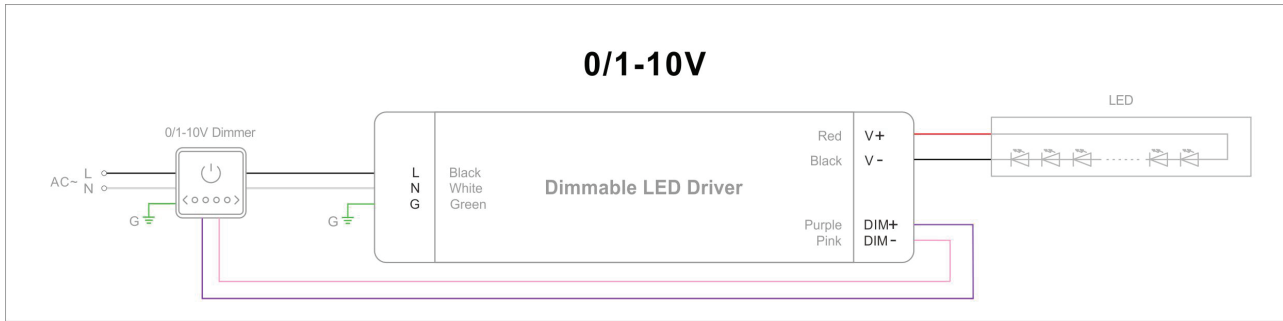

**Triac/Phase cut & 0-10V/1-10V PWM/Potentiometer (5 in 1) Dimmable**



**Constant Voltage TRIAC Dimmable Driver**

**PN: HBL040-AW-24-DA**

Model	Input Voltage	Output Voltage	Wattage	Rated Current	Frequency	Location	Certificate
HBL040-AW-24-DA	120-277VAC	24VDC	40W	1.66A	50/60Hz	Dry or Damp location	ETL, Class 2

TRIAC Dimming for 120VAC / Non-Dimming for 277VAC

**PN: HBL060-AW-24-DA**

Model	Input Voltage	Output Voltage	Wattage	Rated Current	Frequency	Location	Certificate
HBL060-AW-24-DA	120-277VAC	24VDC	60W	2.5A	50/60Hz	Dry or Damp location	ETL, Class 2

TRIAC Dimming for 120VAC / Non-Dimming for 277VAC

**PN: HBL096-AW-24-DA**

Model	Input Voltage	Output Voltage	Wattage	Rated Current	Frequency	Location	Certificate
HBL096-AW-24-DA	120-277VAC	24VDC	96W	4A	50/60Hz	Dry or Damp location	ETL, Class 2

TRIAC Dimming for 120VAC / Non-Dimming for 277VAC

**DIMENSIONS**

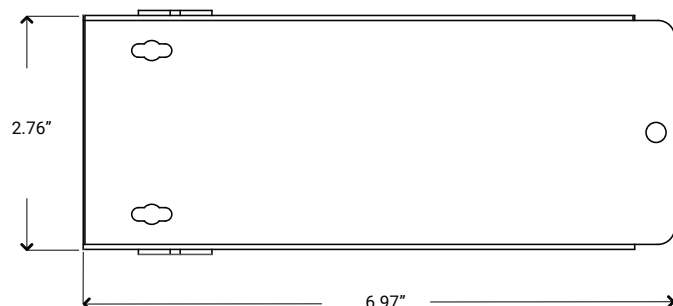
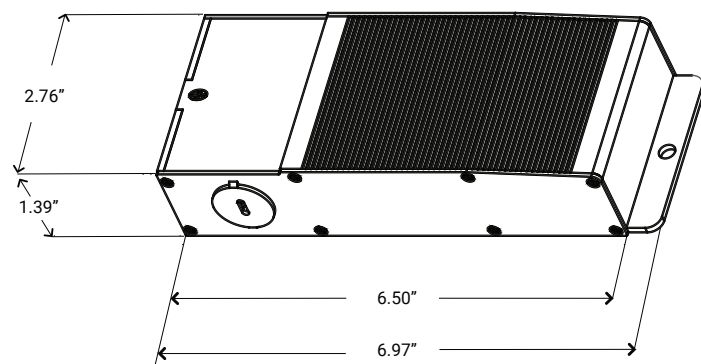

**PN: HBL150-AW-24-DI**

Model	Input Voltage	Output Voltage	Wattage	Rated Current	Location	Certificate
HBL150-AW-24-DI	120-277VAC	24VDC	150W	6.25A	Dry or Damp location	ETL, Class P

TRIAC Dimming for 120VAC / Non-Dimming for 277VAC

**DIMENSIONS**

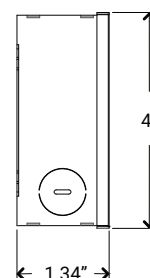
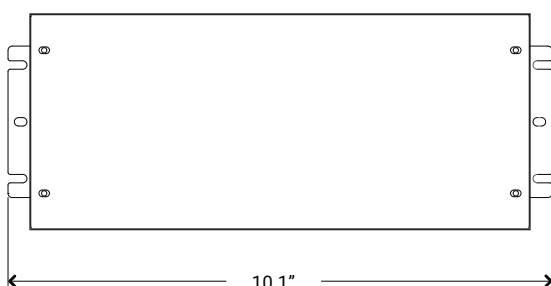

## Connecting Diagram

### Triac Dimmer

(Lutron & Clipsal  
C-Bus System)

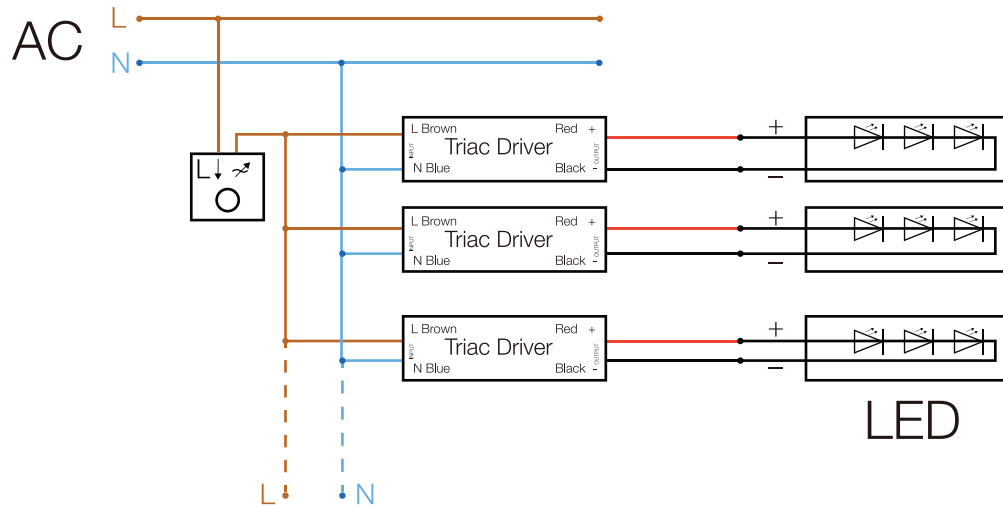

### Triac Dimmer

(Lutron & Clipsal  
C-Bus System)

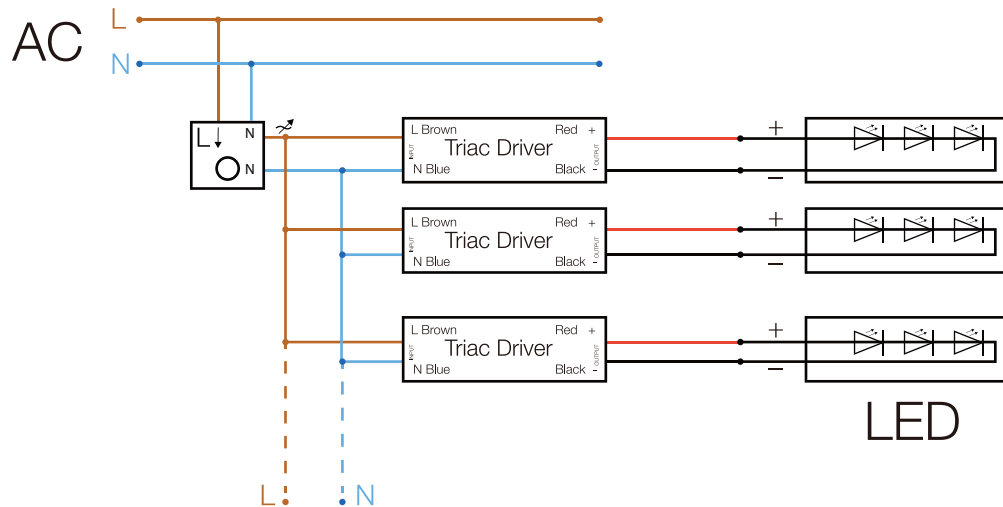

### LUTRON

Triac Dimmer

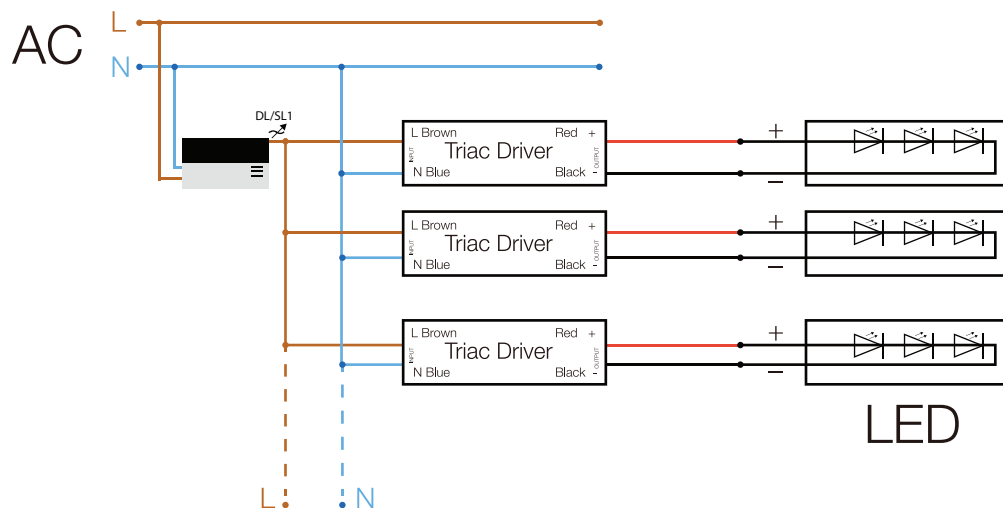





[Click on the picture for detailed information.](#)

## LB-2830A RF Single Color Controller

- Ultra-sensitive, high-strength glass touch panel features a color line for accurate, fast, and precise brightness control.
- Control 4 different zones separately or synchronously with endless receivers in each zone.
- Save 3 brightness or scenes for each zone.
- 256-level brightness adjustment for each white.
- Receivers can work with WiFi-RF converter after installing "Easylighting" app on IOS and android systems.

**Compatible with:** LB-1009EAWI

### TECHNICAL DETAILS

Output Signal	RF Signal
Power Supply	12-24 VDC
Power Consumption	<20 mA
Operating Temperature	0-40°C / 32°F-104°F
Dimensions	4.7"X2.9"X1.1"
Mounting	Wall Mount
Color	White/Black

Certifications	FCC / RoHS
Zones	4
Frequency	916.5MHz
Surface	Glass
Control	Single Color
Warranty	5 Years limited warranty



[Click on the picture for detailed information.](#)

## LB-2833-K5-MONO Single Color Dimmer

**RF wireless Single Color Remote can control 1 zone of receiver.** This single color controller is compatible with all universal series RF receivers. **One receiver can be paired with a maximum of 8 remote controllers.** This device contains a button lithium battery that should be stored and disposed of properly. **DO NOT expose the device to moisture.**

**Compatible with:** LB-1009EAWI

### TECHNICAL DETAILS

Output Signal	RF Signal
Power Supply	3V (CR2032 battery)
Operating Temperature	0-40°C / 32°F-104°F
Dimensions	2.5"X1.2"X0.35"
Color	White

Certifications	FCC / RoHS
Zones	Control 1 Zone of receiver
Frequency	916.5MHz
Rated	IP20
Warranty	5 Years limited warranty

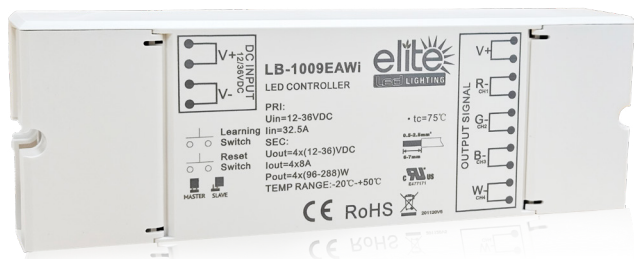

Click on the picture for detailed information.

## LB-1009EAWI RF+WiFi Receiver/LED Controller 4Channels

The RGBW controller LB-1009EAWI is a 12-36 VDC constant voltage RF and WiFi controller with 4 channel output, offering 8A per channel. It is compatible with a variety of RF remotes and apps installed on iOS and Android systems, enabling control of single-color, dual-color LEDs, and RGBW LEDs.

Multiple zones can be controlled separately or synchronously with endless receivers in each zone. Built-in changing patterns are available and can be saved to each zone. The brightness of each R, G, B, W channel can be adjusted separately to achieve millions of changing colors.

Thanks to the built-in WiFi to RF module, a significant advantage of this WiFi controller is its compatibility with RF remotes and apps on iOS and Android systems directly, without the need for a WiFi-RF converter.

A free app is available (Easylighting) from the App Store and Google Play. Simply download it on your iOS or Android device, then search and connect your mobile device WLAN to the WiFi controller network.

### TECHNICAL DETAILS

<b>Input Voltage</b>	12-36 VDC
<b>Output Current</b>	4x8A
<b>Output Power</b>	4x(96-288)W
<b>Dimensions</b>	6.6"X2.3"X1.1"

<b>Frequency</b>	869.5/916.5/434mhz
<b>Certifications</b>	FCC / RoHS
<b>Color</b>	White
<b>Warranty</b>	5-Years limited warranty



## LED25W-24 (Power Supply) Optional for Wall Controller

Total Power: 25 Watts  
Input Voltage: 100-277 VAC  
UL Dry & Damp Location Rated  
IP66  
High Efficiency  
High Power Factor  
Analog Dimming (0-10V)  
Black Magic Thermal Advantage, Plastic Housing

### GUIDE DIAGRAM

Static White

①

