

LB8000-12-ST Series
Outdoor Strip Light
Width / 0.47"
Height / 0.47"
IP68



FEATURES

The **LB8000-12-ST LED Tape Light** is an extremely **easy-to-operate**, dual bending flex neon linear lighting solution designed for both indoor and outdoor applications. It offers a color temperatures range of **3000K, 4000K, and 5000K**, providing flexibility to create the desired ambiance and lighting effects in various **indoor or outdoor spaces**.

The **LB8000-12-ST Lumi-PRO Strip Light** is designed for **easy installation**, allowing seamless integration into various indoor or outdoor settings. It can be mounted on **different surfaces**, such as **walls, ceilings, or furniture**, using adhesive backing or mounting brackets.

Max run up to 33ft
Outdoor/Wet Location (IP68)

Linear lighting

Top Bending

Warranty: 5 years for indoor and 3 years for outdoor limited warranty

Color Temp. **3.5 W/ft.**

3000K	215 lm/ft
3500K	220 lm/ft
4000K	225 lm/ft
5000K	230 lm/ft

MOUNTING TRACK

FNC-1212-5



Bending Aluminum Track
19" length

FNC-1212-1



Bending Aluminum Track
39" length

BENDING RADIUS / MIN. Bending radius 1.18" (30mm)

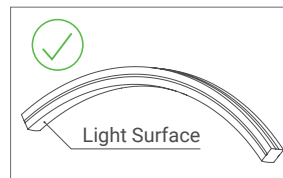

Concave Direction

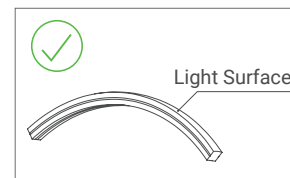

Convex Direction

TECHNICAL DETAILS

Power	3.5W/ft
Voltage	24V
IP	IP68
CRI	90+
LED Qty	44/ft
Max Run(ft)	33ft
Cutting Length	1.64"
Dimensions	W0.47" X H0.47"
Working Temp.	-4F / +122F

Experience **unparalleled** performance with our precision-engineered, high-quality **Lumi-PRO LB8000-12-ST Outdoor LED Strip Light**, meticulously designed to meet the demands of the **most challenging** applications.

DIMENSIONS

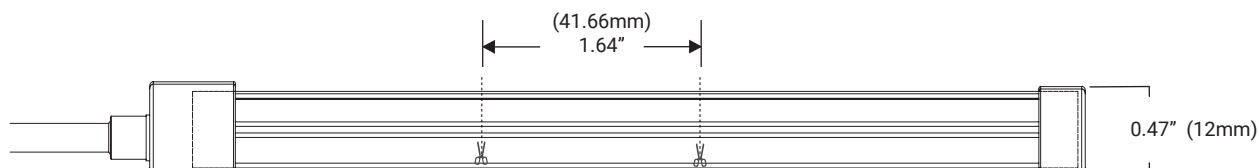

Accessories

LB8000-12-CH-BR

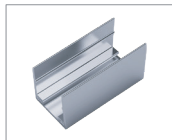

Extruded Channel
flangeless bracket

1.3"x0.5"x0.5"

LB8000-12-CH



Extruded channel
flangeless

39"x0.5"x0.5"

LB8000-12-WE



Welding end cap

1.6"x0.6"x0.6"

LB8000-12-WC



Welding Connector

1.9"x1.4"x0.6"

LB8000-12-ERO



Silicone end cap Side
Right Outlet

1"x0.8"x0.5"

LB8000-12-ELO



Silicone end cap Side
Left Outlet

1"x0.8"x0.5"

LB8000-12-EC



Silicone end cap

0.5"x0.1"x0.5"

LB8000-12-EC-PF-EF



Silicone end cap
power feed

1"x0.5"x0.5"

LB8000-12-EC-PF-BF



Silicone end cap Side
bottom power feed

1"x0.8"x0.5"

ORDERING SELECTION

Example: **LB8000-12-ST-3.5W-48F-30K-24V**

LB8000-12-ST					
SERIES	WATTAGE	LENGTH	CCT	VOLTAGE	MOUNTING TRACK
LB8000-12-ST	3.5W - 3.5W/ft	48F - 48ft Roll	30K - 3000K 35K - 3500K 40K - 4000K 50K - 5000K	24V - 24V	FNC-1212-5 - Bending Aluminum Track 19" length FNC-1212-1 - Bending Aluminum Track 39" length

ACCESSORIES	CONTROLLERS

LB8000-12-CH-BR - Flangeless bracket LB8000-12-CH - Extruded channel flangeless LB8000-12-WE - Welding end cap LB8000-12-WC - Welding connector LB8000-12-ERO - End cap right outlet LB8000-12-ELO - End cap left outlet LB8000-12-EC - Silicone end cap/end LB8000-12-EC-PF-EF - Silicone end cap/power feed LB8000-12-EC-PF-BF - Silicone end cap/side bottom power feed	LB-2830A - RF single color controller LB-2833-K5-MONO - RF single color dimmer LED25W-24 - Power supply LB-1009EAWI - RF+WiFi receiver
---	---

Triac-Phase Cut/Triac ELV/0-10V/1-10V PWM/Potentiometer (5 in 1) Dimmable

PN: ED-30W-24V-TRIAC/DIM10

Model	Input Voltage	Output Voltage	Wattage	Max. Output current	Frequency	Location	Certificate
ED-30W-24V-TRIAC/DIM10	100-277VAC	24V	30W	1.25A	50/60Hz	Dry, Damp, and Wet locations	UL, cUL, FCC, Class 2, RoHS

Dimensions

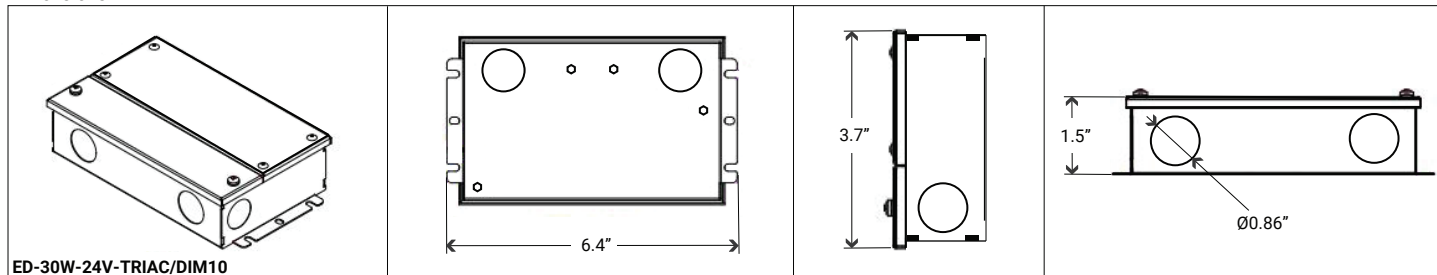

PN: ED-60W-24V-TRIAC/DIM10

Model	Input Voltage	Output Voltage	Wattage	Max. Output current	Frequency	Location	Certificate
ED-60W-24V-TRIAC/DIM10	100-277VAC	24V	60W	2.5A	50/60Hz	Dry, Damp, and Wet locations	UL, cUL, FCC, Class 2, RoHS

Dimensions

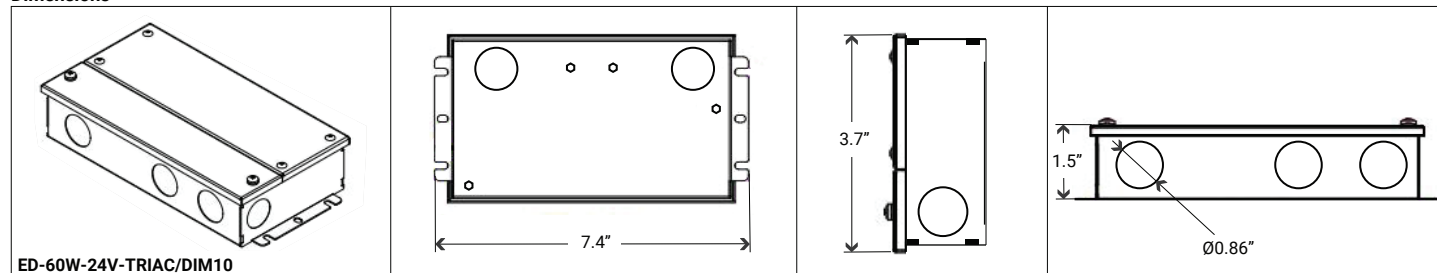

PN: ED-96W-24V-TRIAC/DIM10

Model	Input Voltage	Output Voltage	Wattage	Max. Output current	Frequency	Location	Certificate
ED-96W-24V-TRIAC/DIM10	100-277VAC	24V	96W	4A	50/60Hz	Dry, Damp, and Wet locations	UL, cUL, FCC, Class 2, RoHS

Dimensions

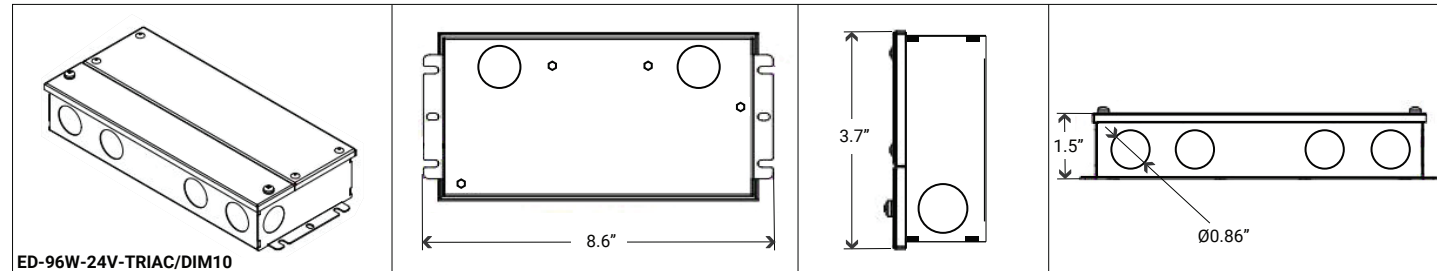

Triac-Phase Cut/Triac ELV/0-10V/1-10V PWM/Potentiometer (5 in 1) Dimmable

PN: ED-192W-24V-TRIAC/DIM10

Model	Input Voltage	Output Voltage	Wattage	Max. Output current	Frequency	Location	Certificate
ED-192W-24V-TRIAC/DIM10	100-277VAC	24V	192W	Multi 2X96W	50/60Hz	Dry, Damp, and Wet locations	UL, cUL, FCC, Class 2, RoHS

Dimensions

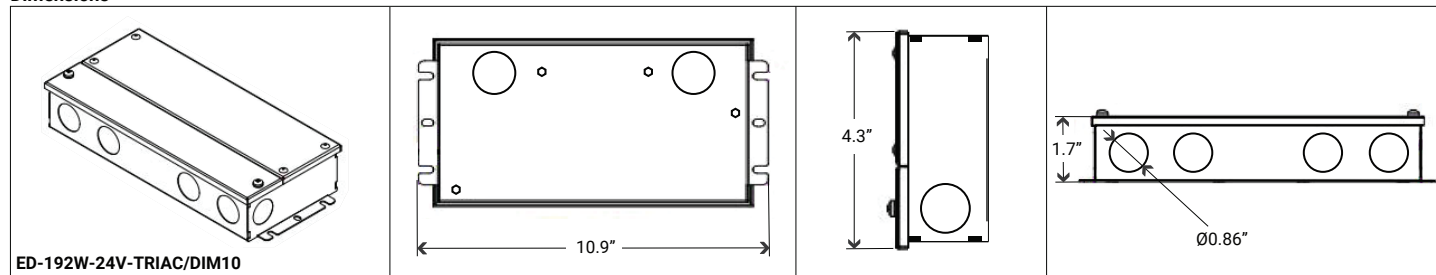

PN: ED-288W-24V-TRIAC/DIM10

Model	Input Voltage	Output Voltage	Wattage	Max. Output current	Frequency	Location	Certificate
ED-288W-24V-TRIAC/DIM10	100-277VAC	24V	288W	Multi 3X96W	50/60Hz	Dry, Damp, and Wet locations	UL, cUL, FCC, Class 2, RoHS

Dimensions

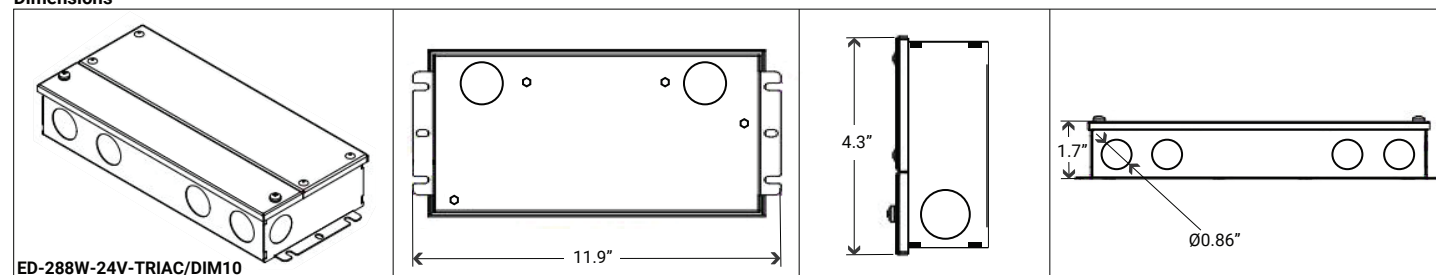

PN: ED-384W-24V-TRIAC/DIM10

Model	Input Voltage	Output Voltage	Wattage	Max. Output current	Frequency	Location	Certificate
ED-384W-24V-TRIAC/DIM10	110-277VAC	24V	384W	Multi 4X96W	50/60Hz	Dry, Damp, and Wet locations	UL, cUL, Class 2, RoHS

Dimensions

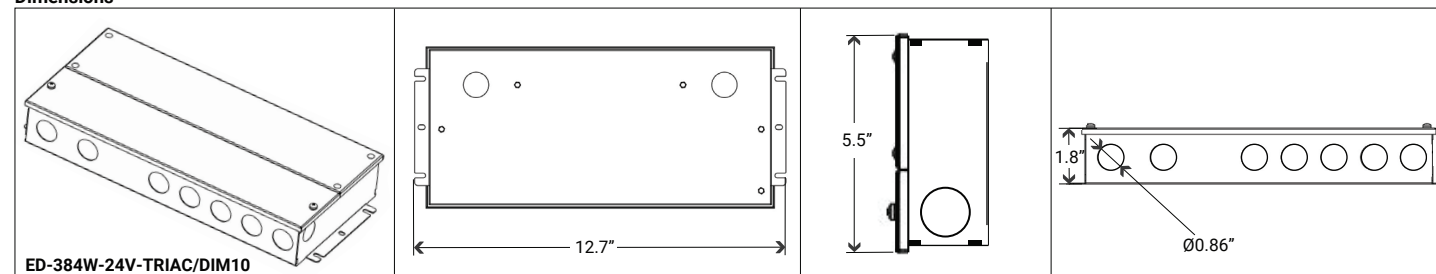

Dimming Operation and Connecting Diagram

- **Using two ways of dimming at the same time**, you must be assured that LED lighting is up to the max. Brightness then you could operate with the other dimming;

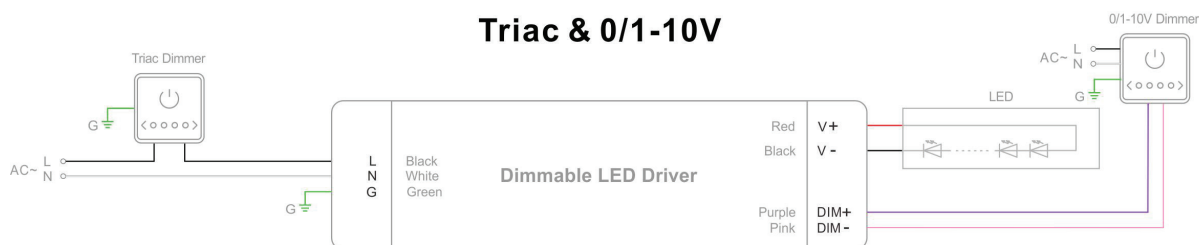

- **Using one dimming ---TRIAC/Phase cut dimming**

1. The Pulse-Width Modulation (PWM) of output voltage can be adjusted through input terminal of the AC phase line(L) by connection a phase /Triac dimmer or lighting system.
2. Working with forward phase, MLV and Reverse phase , ELV, TRIAC dimmers or light system.
3. Min. loading is about 10%
4. Please try to use dimmers with power at least 1.5 times as the output power of the driver.

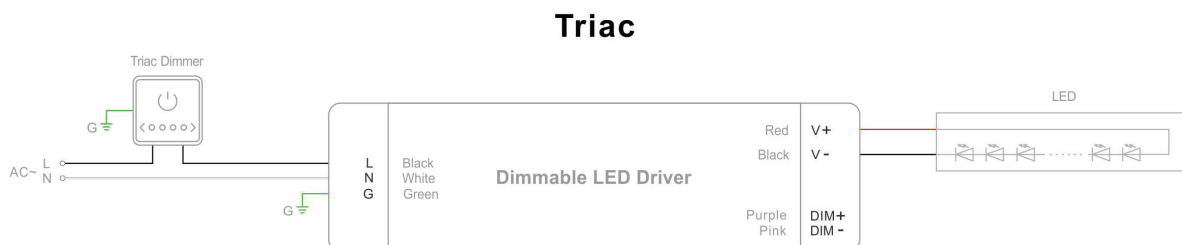

- **Using one dimming ---0-10/ 1-10V/ 10V PWM/ Potentiometer dimming**

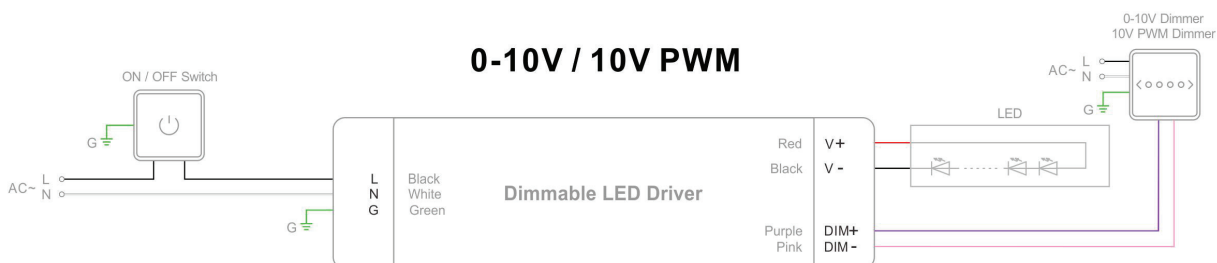

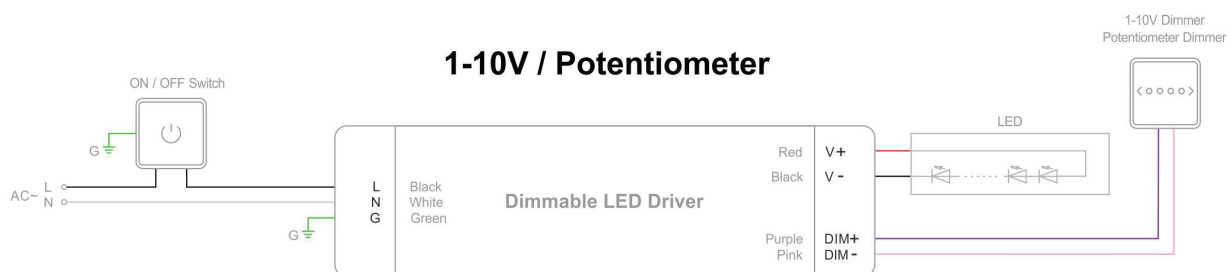
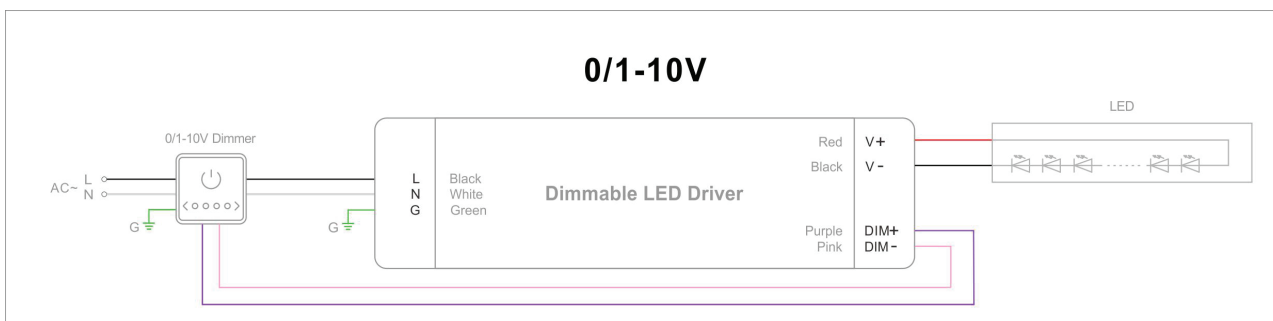

Triac/Phase cut & 0-10V/1-10V PWM/Potentiometer (5 in 1) Dimmable

Constant Voltage TRIAC Dimmable Driver
PN: HBL040-AW-24-DA

Model	Input Voltage	Output Voltage	Wattage	Rated Current	Frequency	Location	Certificate
HBL040-AW-24-DA	120-277VAC	24VDC	40W	1.66A	50/60Hz	Dry or Damp location	ETL, Class 2

TRIAC Dimming for 120VAC / Non-Dimming for 277VAC

PN: HBL060-AW-24-DA

Model	Input Voltage	Output Voltage	Wattage	Rated Current	Frequency	Location	Certificate
HBL060-AW-24-DA	120-277VAC	24VDC	60W	2.5A	50/60Hz	Dry or Damp location	ETL, Class 2

TRIAC Dimming for 120VAC / Non-Dimming for 277VAC

PN: HBL096-AW-24-DA

Model	Input Voltage	Output Voltage	Wattage	Rated Current	Frequency	Location	Certificate
HBL096-AW-24-DA	120-277VAC	24VDC	96W	4A	50/60Hz	Dry or Damp location	ETL, Class 2

DIMENSIONS

TRIAC Dimming for 120VAC / Non-Dimming for 277VAC

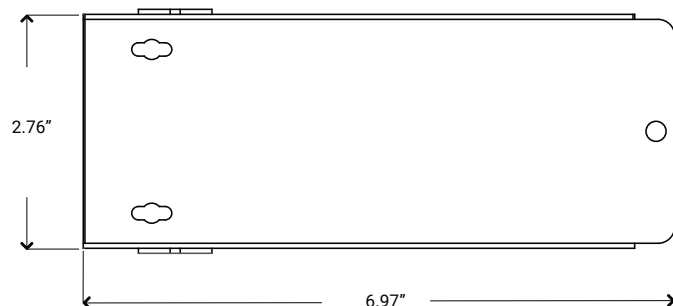
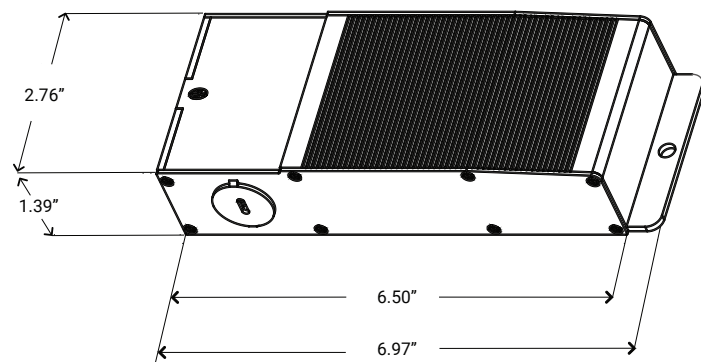
PN: HBL150-AW-24-DI

Model	Input Voltage	Output Voltage	Wattage	Rated Current	Location	Certificate
HBL150-AW-24-DI	120-277VAC	24VDC	150W	6.25A	Dry or Damp location	ETL, Class P

DIMENSIONS

TRIAC Dimming for 120VAC / Non-Dimming for 277VAC

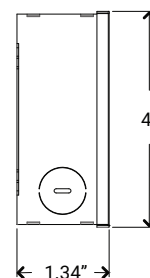
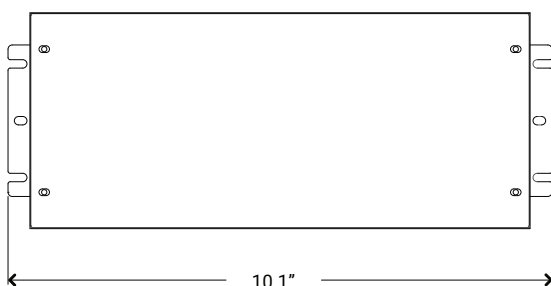

Connecting Diagram

Triac Dimmer
(Lutron & Clipsal
C-Bus System)

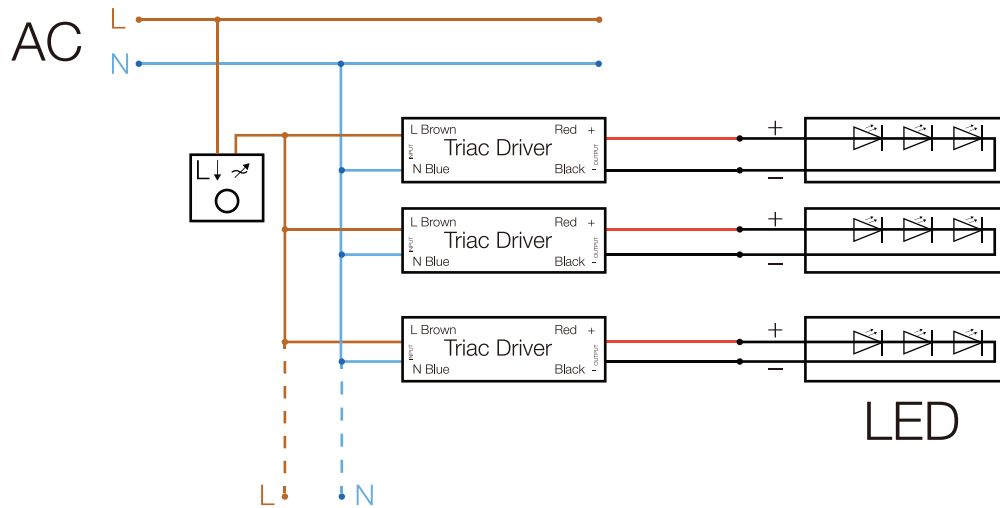

Triac Dimmer
(Lutron & Clipsal
C-Bus System)

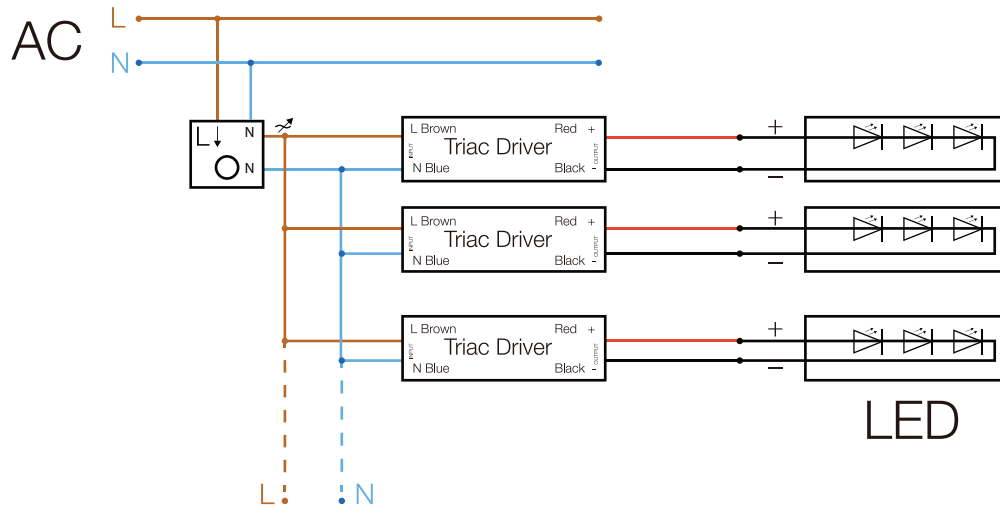

LUTRON
Triac Dimmer

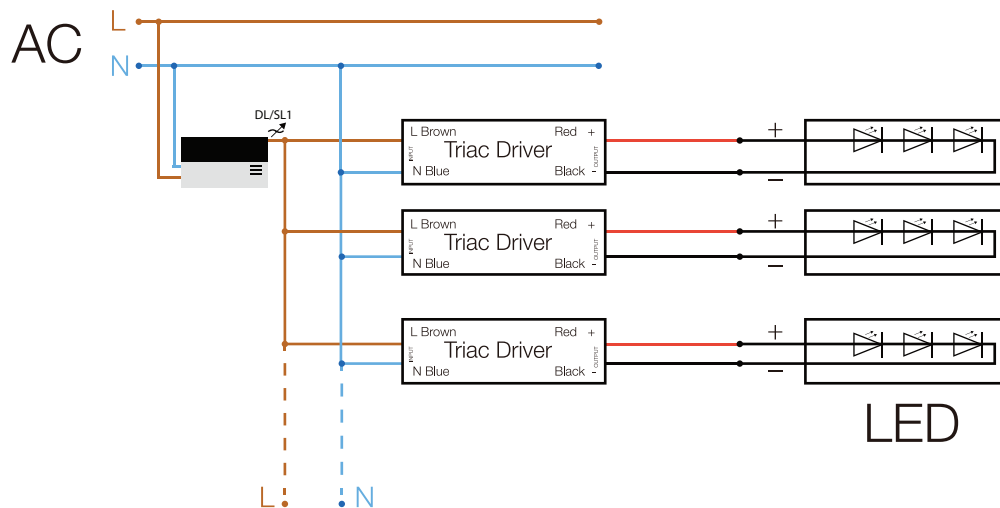



Click on the picture for detailed information.

LB-2830A RF Single Color Controller

- Ultra-sensitive, high-strength glass touch panel features a color line for accurate, fast, and precise brightness control.
- Control 4 different zones separately or synchronously with endless receivers in each zone.
- Save 3 brightness or scenes for each zone.
- 256-level brightness adjustment for each white.
- Receivers can work with WiFi-RF converter after installing "EasyLighting" app on IOS and android systems.

Compatible with: LB-1009EAWI

TECHNICAL DETAILS

Output Signal	RF Signal
Power Supply	12-24 VDC
Power Consumption	<20 mA
Operating Temperature	0-40°C / 32°F-104°F
Dimensions	4.7"X2.9"X1.1"
Mounting	Wall Mount
Color	White/Black

Certifications	FCC / RoHS
Zones	4
Frequency	916.5MHz
Surface	Glass
Control	Single Color
Warranty	5 Years limited warranty



Click on the picture for detailed information.

LB-2833-K5-MONO Single Color Dimmer

RF wireless Single Color Remote can control 1 zone of receiver. This single color controller is compatible with all universal series RF receivers. **One receiver can be paired with a maximum of 8 remote controllers.** This device contains a button lithium battery that should be stored and disposed of properly. **DO NOT expose the device to moisture.**

Compatible with: LB-1009EAWI

TECHNICAL DETAILS

Output Signal	RF Signal
Power Supply	3V (CR2032 battery)
Operating Temperature	0-40°C / 32°F-104°F
Dimensions	2.5"X1.2"X0.35"
Color	White

Certifications	FCC / RoHS
Zones	Control 1 Zone of receiver
Frequency	916.5MHz
Rated	IP20
Warranty	5 Years limited warranty



Click on the picture for detailed information.

LB-1009EAWI RF+WiFi Receiver/LED Controller 4Channels

The RGBW controller LB-1009EAWI is a 12-36 VDC constant voltage RF and WiFi controller with 4 channel output, offering 8A per channel. It is compatible with a variety of RF remotes and apps installed on iOS and Android systems, enabling control of single-color, dual-color LEDs, and RGBW LEDs.

Multiple zones can be controlled separately or synchronously with endless receivers in each zone. Built-in changing patterns are available and can be saved to each zone. The brightness of each R, G, B, W channel can be adjusted separately to achieve millions of changing colors.

Thanks to the built-in WiFi to RF module, a significant advantage of this WiFi controller is its compatibility with RF remotes and apps on iOS and Android systems directly, without the need for a WiFi-RF converter.

A free app is available (Easylighting) from the App Store and Google Play. Simply download it on your iOS or Android device, then search and connect your mobile device WLAN to the WiFi controller network.

TECHNICAL DETAILS

Input Voltage	12-36 VDC
Output Current	4x8A
Output Power	4x(96-288)W
Dimensions	6.6"X2.3"X1.1"

Frequency	869.5/916.5/434mhz
Certifications	FCC / RoHS
Color	White
Warranty	5-Years limited warranty



LED25W-24 (Power Supply) Optional for Wall Controller

Total Power: 25 Watts
Input Voltage: 100-277 VAC
UL Dry & Damp Location Rated
IP66
High Efficiency
High Power Factor
Analog Dimming (0-10V)
Black Magic Thermal Advantage, Plastic Housing

GUIDE DIAGRAM

Static White

①

