

FEATURES

The **LB-2820US** is an **RGBW touch controller** that adopts an ultra-sensitive full-touch glass panel with a touch color wheel to offer accurate and fast color tone adjustment. The touch panel controller is designed with a **sleek appearance and a user-friendly interface** for easy operation. Independent dimming function of each **R, G, B, W** channel enables the RGB controller to create millions of colors.

- Touch sensitive.
- Glass interface.
- Compatible with all universal series RF receivers.
- Control RGBW color.
- Control 1 zone/area.
- Receivers can work with the WiFi-RF converter using the "Easylighting" or "Easyhome" app on IOS and Android systems.



Wall Control

DIMENSIONS

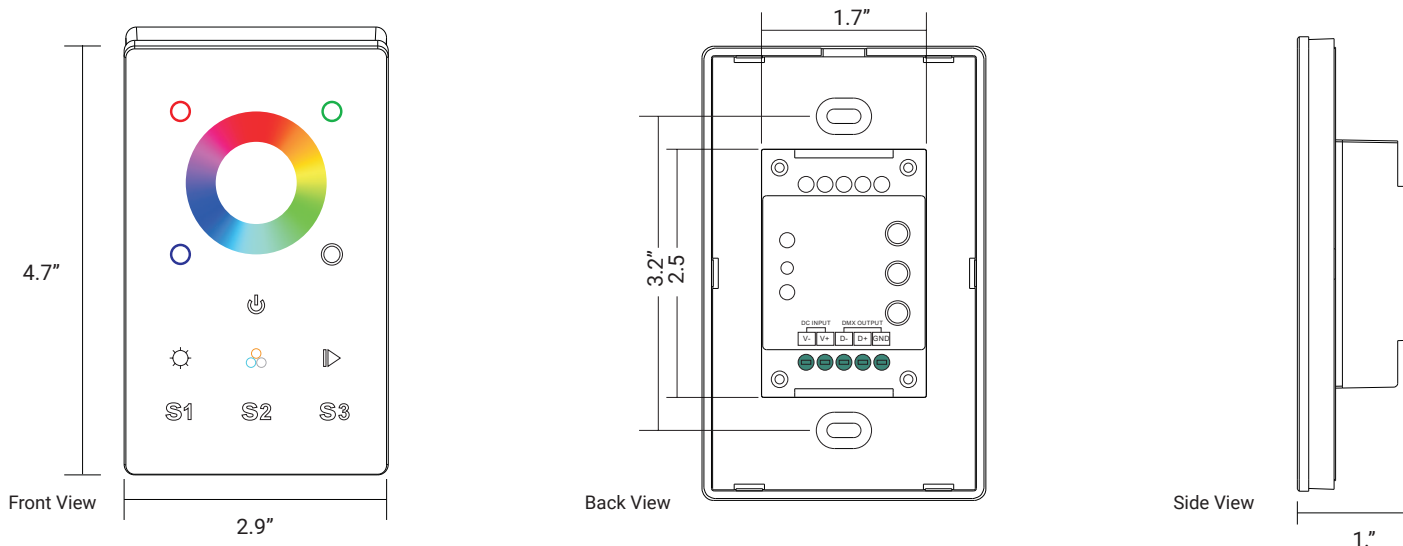

TECHNICAL DETAILS

Output Signal	RF Signal
Power Supply	120 VAC
Power Consumption	< 15 mA
Operating Temperature	0-40°C / 32°F-104°F
Dimensions	2.9"X4.7"X1"
Frequency	916.5MHz
Color	White/Black

Certifications	FCC / RoHS
Zones	1
Indoor	IP20
Surface	Glass
Channels	RGBW
Warranty	5 Years limited warranty

MASTER CONTROL OPERATION.

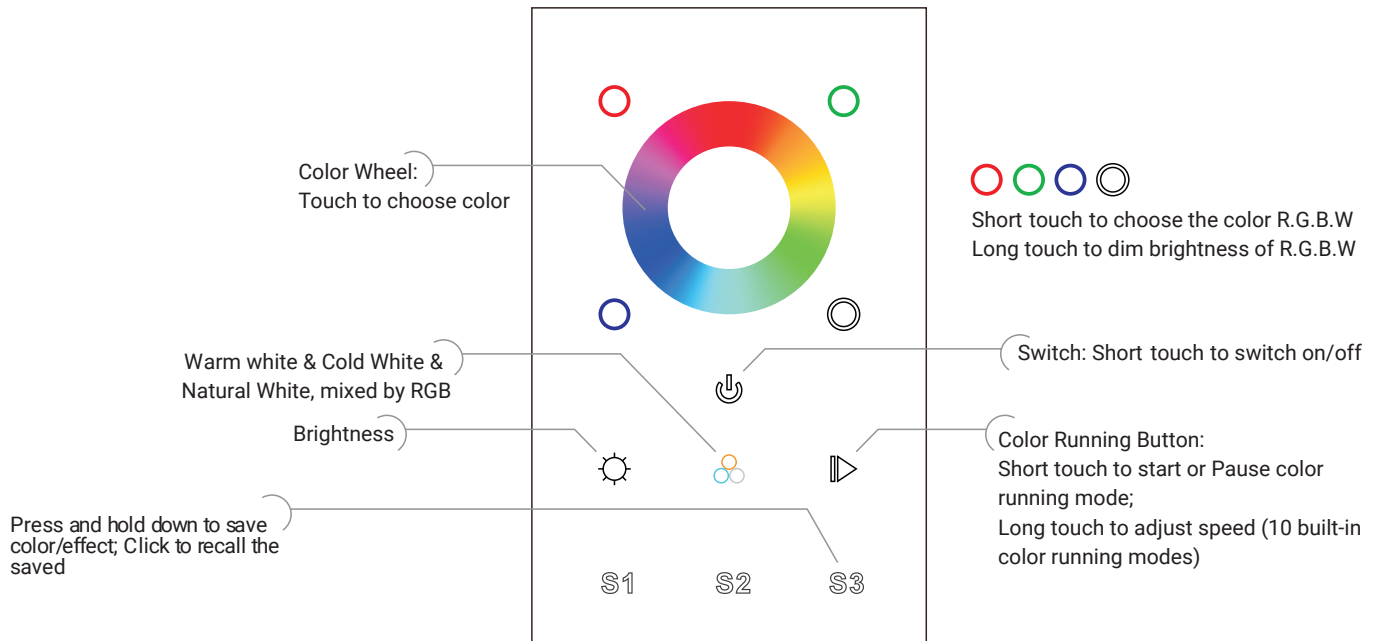

WIRING DIAGRAM

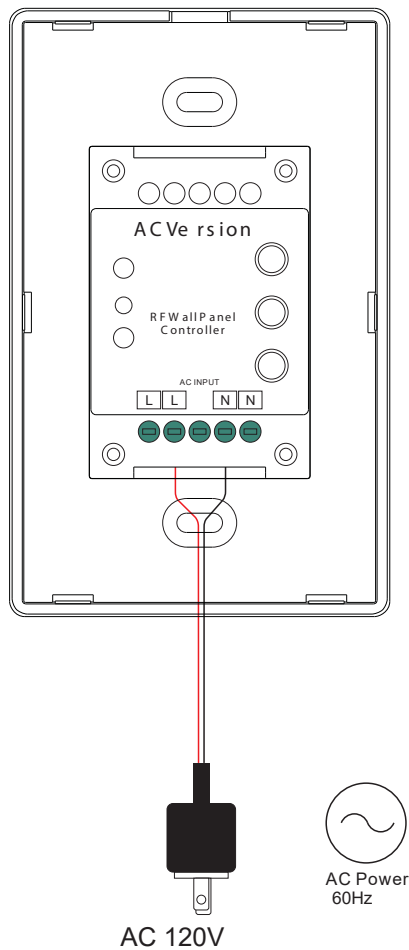

WIRING DIAGRAM

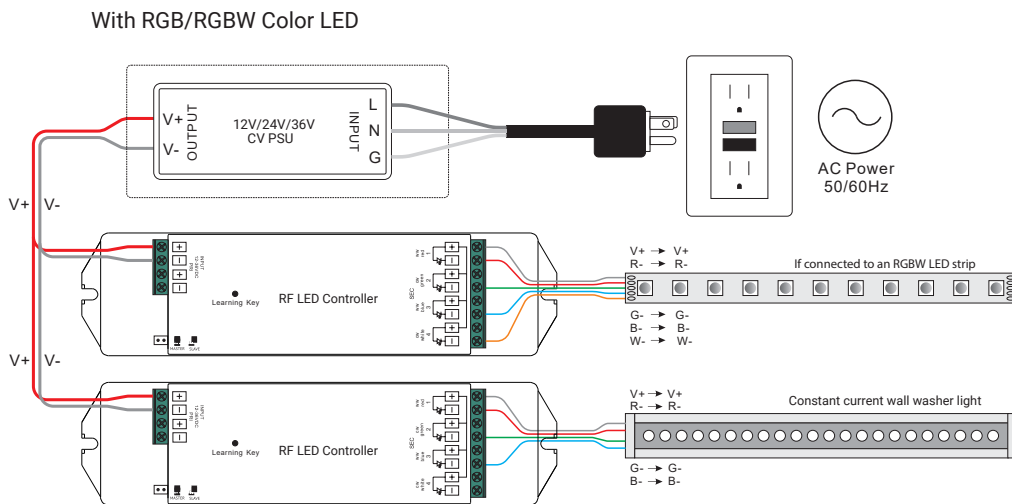

MASTER CONTROL PAIRING WITH RECEIVER

Pair With RF Receiver

1. Wire the wall panel and RF receiver according to the wiring diagram (please refer to the instructions of the RF receiver that you would like to pair with).
2. Power on, then touch the button  to activate the controller; the indicator of the controller will turn blue.

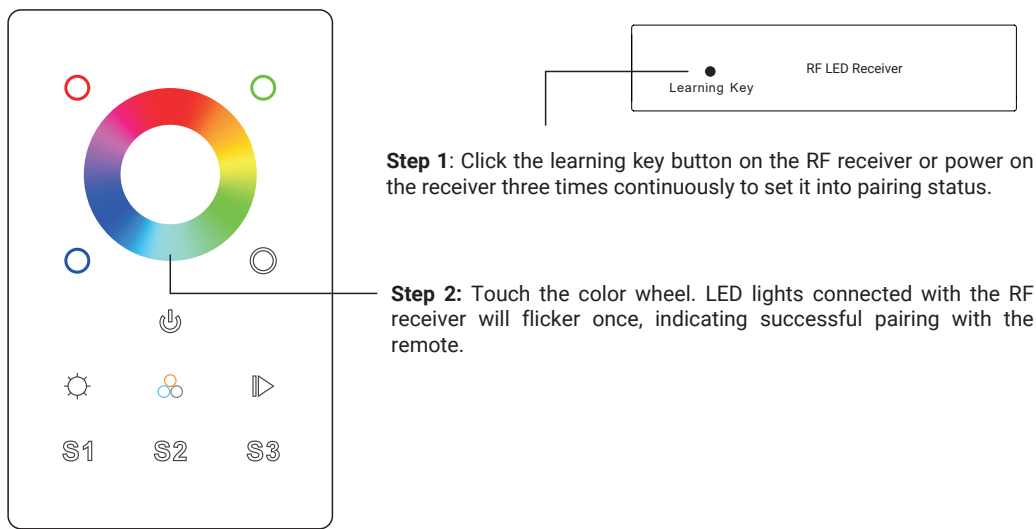

Built-in 10 color changing modes are as follows:

- Mode 1: Any two colors of RGB mix fade-in & fade-out
- Mode 2: RGB three colors mix fade-in & fade-out
- Mode 3: RGB three colors mix fade-out & fade-in
- Mode 4: RGB flash
- Mode 5: RGB three colors fade-in & fade-out successively
- Mode 6: RGB three colors fade-in successively
- Mode 7: RGB three colors fade-out successively
- Mode 8: RGB three colors jump changing successively
- Mode 9: R&B two colors mix fade (R in B out), then G fade-in, then R&B mix fade (R out B in), then G fade-out
- Mode 10: B fade-out, then G&B mix fade (G out B in), then R&G mix fade (R out G in), then R fade-in

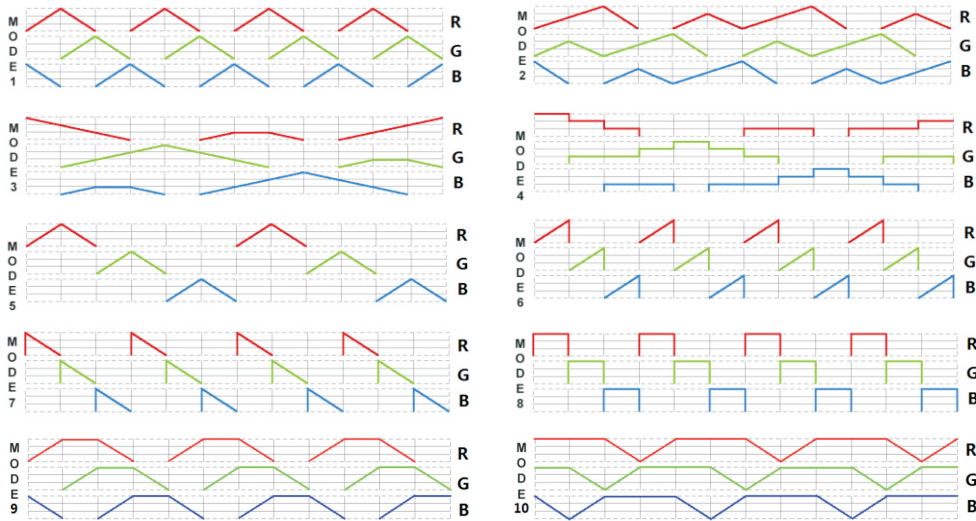

INSTALLATION

- ① Detach the faceplate using a flathead screwdriver.

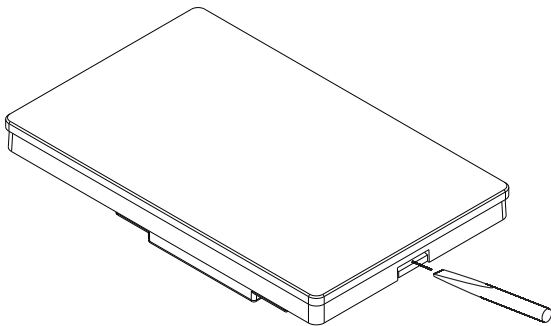

- ② Install on a regular switchbox.

