



HH10-1501
Flanged Downlight



HH10-1507
Flanged Wall Wash



HH10-1577
Flanged Double Wall Wash



HH10-TL-1501
Trimless Downlight



HH10-TL-1507
Trimless Wall Wash

REFLECTOR/
TRIM COLOR

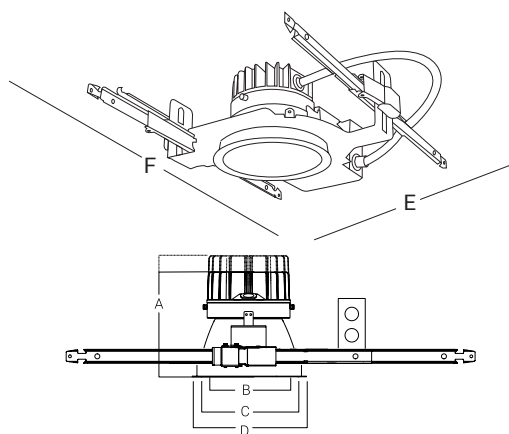

A 900L to 4000L: Height = 9"
A 6000L to 8000L: Height = 12"
B: Trim Aperture = 9-5/8"
C: Cut-Out = 10-1/2"
D: Trim Outside Dia = 11"
E: Width = 17-1/2"
F: Length = 16-1/2"

LUMENS	WATTAGES
2500L	30 W
2000L	24 W
1500L	18 W
1200L	14 W
900L	10 W

Based on 4000K, 90CRI with semi-specular chrome reflector.
Actual wattage may vary +/-5%

DYNAMIC PLATFORM

SMART WHITE - Tunable White with Smart White technology allows the tuning of luminaires to mimic the natural color patterns throughout the day, enhancing interior office spaces, hospitality, and architectural elements. Tuning of intensity and color in classrooms enables a diversification in student activities, while the use of tunable white technology in healthcare stimulates circadian rhythm, accelerating the healing process. Complementary colors and textures in retail merchandising also has an impact on sales, utilizing the technology to adjust colors throughout the season. A CRI of 90+ is standard, and available on all three platforms. Elite Platform (50K-27K).

LUMENS	Elite Platform: 900, 1200, 1500, 2000 & 2500
TUNABLE WHITE PLATFORM	TWH-50K-27K (50K to 27K) TWH-65K-27K (65K to 27K)
CRI	90+ Standard
COLOR QUALITY	2 Step MacAdam Ellipse
DISTRIBUTIONS	VWD, WD, MWD, MD, ND, SPD, NSPD, 45°-50° visual cutoff
TRIM OPTIONS	Downlight, Wall Wash, Double Wall Wash, Wet Location
REFLECTOR COLORS	CL (Semi-Specular Chrome), SHZ (Low Iridescent Satin Haze), WT (Wheat), WH (White), MB (Black)
FLANGE COLORS	Self-flanged WH (White), SCH (Semi-Specular Chrome), SHZ (Low Iridescent Satin Haze), MB (Black) and TL (Trimless)
DIMMING	1% Dimming Standard, 0-10V (DIM10), DMX-512 DMX-RDM, BLE, LUTH, DALI
EMERGENCY	10W - Up to 1000L Output (Bodine BSL310) 20W - Up to 2000L Output (Bodine BSL20)
LIFETIME	L70 at 102,000 Hours
PHOTOMETRIC TESTS	In Accordance with IES LM79-08, LM80 and TM-30, TM-21

VWD: Very Wide Candlepower Distribution Curve WD: Wide Candlepower Distribution Curve MWD: Medium Wide Candlepower Distribution Curve MD: Medium Candlepower Distribution Curve ND: Narrow Candlepower Distribution Curve SPD: Spot Candlepower Distribution Curve NSPD: Narrow Spot Candlepower Distribution Curve

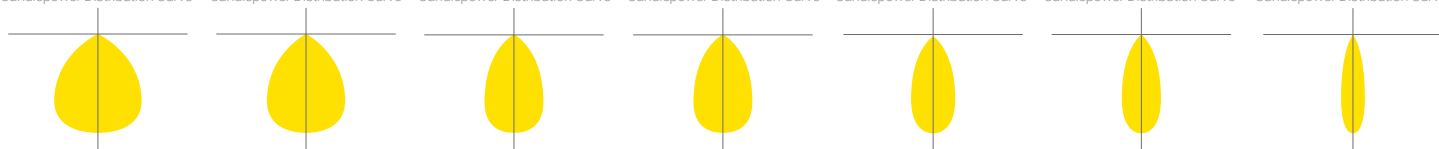

Reference IES files for additional distribution curve information.





FEATURES

A highly sustainable and ultra-efficient architectural LED downlight that provides even, glare-free illumination. Available in a range of finishes, distributions, and lumen packages, it is ideally suited for use in corporate office space, hospitality, healthcare, commercial, academic, churches and retail.

OPTICS AND REFLECTOR

The reflector has a 45° visual cutoff, and is shipped standard with a Solite lens in a smooth frosted finish. Spun from 0.05" thick aluminum, with a 1-step anodized finish, and available in different colors or custom RAL finishes. Reflector flange options include self-flanged and white painted flange. Various distribution options are available, and all optics are field changeable.

THERMAL MANAGEMENT SYSTEM

Passive cooling Diecast Aluminum Heat Sink, LED light engine and driver are replaceable, upgradeable, and can be accessed from below the ceiling. The consistency in the quality of light is delivered with precision performance by the use of a unique locking mechanism that aligns the reflector with the light engine.

MOUNTING FRAME & BRACKET

The downlight mounting frame is a fabricated assembly constructed of 16-gauge steel, with C-channel mounting brackets, included. The versatility of the mounting bracket allows for an adjustability of up to 28" horizontally, and 2-3/4" vertically, locking into place. With the added die-formed construction of the mounting frame, it provides maximum heat dissipation and rust protection.

DRIVER ELECTRICAL INFORMATION

The LED driver is rated for 50 to 60Hz at 120V/277V input, produces less than 20%THD, has a power factor between 90% and 100%, and is thermally protected for additional safety. Junction box and Driver can be accessed from below the ceiling and above the ceiling. Junction Box is Listed for through branch circuit wiring.

DIMMING & DRIVER INFORMATION

SMART WHITE High Performance platform with a tuning range of 5000K to 2700K (TWH-50K-27K).
Control via DIM10 (0-10V), ELITE-CONNECT 0-10V, LUTRON, DMX512-RDM, DALI

Control via DIM10, ELITE-CONNECT 0 10V, DMX512, DMX-RDM, BLE, DALI
Junction box and Driver can be accessed from below the ceiling and above the ceiling. Junction Box is Listed for through branch circuit wiring.

WARRANTY

Five-year warranty for parts and components. (Labor not included)

LISTINGS

c-UL-us - Listed for Wet Location if used with HH10-1501 Trim.

c-UL-us - Listed for Feed Through Wiring.

All LED luminaires are rated and tested to LM-79 and LM-80 standards by an independent laboratory.

U.S Patent No. - D685,118S



Example: HH10-LED-TWH-50K-27K-900L-DIM10-120-MD-90-HH10-1501-CL-WH

SERIES	LUMENS	DRIVER	VOLTAGE		EMERGENCY	TRIM TYPE	REFLECTOR/TRIM- FINISH	WALL MOUNT CONTROLLER
HH10-LED-TWH-50K-27K HH10-LED-TWH-65K-27K	<div><input type="checkbox"/> 900L</div> <div><input type="checkbox"/> 1200L</div> <div><input type="checkbox"/> 1500L</div> <div><input type="checkbox"/> 2000L</div> <div><input type="checkbox"/> 2500L</div>	<div><input type="checkbox"/> DIM10*</div> <div><input type="checkbox"/> DMX-512</div> <div><input type="checkbox"/> DMX-RDM</div> <div><input type="checkbox"/> DALI</div> <div><input type="checkbox"/> BLE</div> <div><input type="checkbox"/> LUTH ²</div>	<div><input type="checkbox"/> 120</div> <div><input type="checkbox"/> 277</div> <div><input type="checkbox"/> MVOLT</div>		<div><input type="checkbox"/> EMG-LED-10W</div> <div><input type="checkbox"/> EMG-LED-20W</div> <div>Typical lumen output of the luminaire is up to 1000L with EMG-LED-10W option & 2000L with EMG-LED-20W option in emergency mode. Contact the factory for details.</div> <div>Remote mounted installation</div>	<div><input type="checkbox"/> HH10-1501 Flanged Downlight</div> <div><input type="checkbox"/> HH10-1507 Flanged Wall Wash</div> <div><input type="checkbox"/> HH10-1577 Flanged Double Wall Wash</div>	<div><input type="checkbox"/> CL-WH</div> <div><input type="checkbox"/> CL-SCH</div> <div><input type="checkbox"/> SHZ-WH</div> <div><input type="checkbox"/> SHZ-SHZ</div> <div><input type="checkbox"/> WT-WH</div> <div><input type="checkbox"/> WH-WH</div> <div><input type="checkbox"/> MB-WH</div> <div><input type="checkbox"/> CL-MB</div>	<div><input type="checkbox"/> EC-WC-TWH-HW-MVOLT ¹</div>
			<div><div><div><input type="checkbox"/> VWD</div><div>70°</div></div><div><input type="checkbox"/> WD</div><div>60°</div></div> <div><input type="checkbox"/> MWD</div> <div>52°</div> <div><input type="checkbox"/> MD</div> <div>36°</div> <div><input type="checkbox"/> ND</div> <div>30°</div> <div><input type="checkbox"/> SPD</div> <div>24°</div> <div><input type="checkbox"/> NSPD</div> <div>15°</div>	<div><input type="checkbox"/> 90+</div>				
<div><div><input type="checkbox"/> HH10-TL-1501 Trimless Downlight-</div><div><input type="checkbox"/> HH10-TL-1507 Trimless Wall Wash</div></div>	<div><input type="checkbox"/> SHZ</div> <div><input type="checkbox"/> CL</div>							

* For 0-10V driver you must dedicate two control inputs, one for the Dimming Control and another for CCT Tuning.

** For Details Consult Factory

¹ Compatible with Elite 0-10V Platform and LED Engin 0-10V Platform ² (Lutron T Series 2 Channel Tunable White)



HH10-LED-TWH-50K-27K-2000L-ND-HH10-1501-CL-WH

TEST NO.: **LM-63-2002**

INPUT WATTS: **24.8**

LUMENS: **2093**

CRI: **90+**

EFFICACY: **84**

CCT: **4000K**

SPACING CRITERIA: **0.44**

Candle Power Distribution (Candelas)

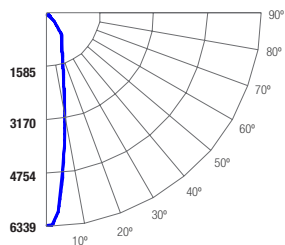

Zonal Lumens Summary

Zone	Lumens	%Lamp	%Fixt
0-20	995.74	47.60	47.60
0-30	1502.05	71.80	71.80
0-40	1919.71	91.70	91.70
0-60	2085.57	99.60	99.60
0-80	2092.54	100.00	100.00
0-90	2093.37	100.00	100.00

Luminance (Average candela/M²)

Angle in Degrees	Average 0°	Average 45°	Average 90°
45	3230	7321	11944
55	763	1252	2041
65	173	219	1029
75	106	177	232
85	69	433	537

Lumens Per Zone

Zone	Lumens
0-10	412.84
10-20	582.89
20-30	506.31
30-40	417.66
40-50	142.87
50-60	22.99
60-70	5.65
70-80	1.33
80-90	0.83

Candela Tabulation

0	
0	6339.33
5	5150.18
15	1962.79
25	1044.09
35	752.22
45	72.67
55	13.92
65	2.32
75	0.87
85	0.19
90	0.05

Coefficients of Utilization - Zonal Cavity Method

Effective Floor Cavity Reflectance 0.20

Cone of Light		
4.0	396	1.5 ft.
8.0	99.1	3.1 ft.
12.0	44.0	4.6 ft.
16.0	24.8	6.1 ft.
20.0	15.8	7.6 ft.
24.0	11.0	9.2 ft.
Distance to Plane	Initial Footcandle at Nadir	Beam diameter

BEAM DIA. MEASURED AT 50% OF NADIR F.C.



	RC	80%				70%				50%				30%				10%				0%
	RW	70%	50%	30%	10%	70%	50%	30%	10%	50%	30%	10%	50%	30%	10%	50%	30%	10%	0%			
ROOM CAVITY RATIO	0	119	119	119	119	116	116	116	116	111	111	111	106	106	106	102	102	102	100			
	1	114	111	109	107	111	109	107	105	105	103	102	101	100	99	98	97	96	94			
	2	109	104	100	97	106	102	99	96	99	96	94	96	94	92	93	92	90	88			
	3	104	97	93	89	102	96	92	88	94	90	87	91	88	86	89	86	84	83			
	4	99	92	86	82	97	90	86	82	88	84	81	86	83	80	85	82	79	78			
	5	94	86	81	77	93	85	80	76	84	79	76	82	78	75	81	77	75	73			
	6	90	82	76	72	88	81	76	72	79	75	71	78	74	71	77	73	70	69			
	7	86	77	72	68	85	77	71	68	75	71	67	74	70	67	73	69	66	65			
	8	82	73	68	64	81	73	68	64	72	67	64	71	66	63	70	66	63	62			
	9	79	70	64	61	78	69	64	61	68	64	60	68	63	60	67	63	60	59			
10	76	67	61	58	75	66	61	58	65	61	57	65	60	57	64	60	57	56				

RC - Ceiling Cavity Reflectance RW - Wall Reflectance

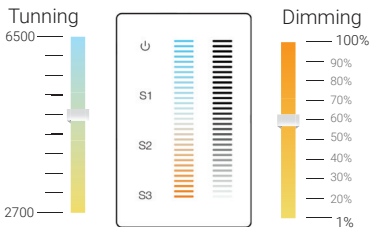

CONTROL OPTIONS

With the integration of controls, Elite Lighting now offers its products with controls-ready performance that increases energy efficiency, smarter space planning, and the enhancement of safety and productivity in the workplace. By utilizing these controls, Elite Lighting luminaires enable your customer's facility to run smarter, with the use of an easily controlled system through any platform.

CONTROL PROTOCOLS	SMART WHITE	LEDENGIN
<p>ELITE-CONNECT (EC-WC-TWH-HW-MVOLT) - Hard-wired, 0-10V, 120/277V wall mounted controller for CCT Tuning and Intensity Dimming through Simple Touch screen pad, provided by Elite Lighting. Programmable for up to 3-scenes, with a dimming range down to 1%. Applicable for office spaces, hospitality, educational, healthcare, and retail merchandising.</p> 	✓	✓
<p>DIM10 (0-10V 1% Dimming Standard) In order to Control the Color Tuning and dimming option with 0-10V driver you must dedicate two control inputs, one for the Dimming Control and another for CCT Tuning. Can be dimmed and tuned with 2 wall box dimmers and compatible with most control systems and/or daylight harvesting systems.</p> <p>DIM10-LUTRON Compatible with Lutron GRAFIK Eye QS or GRAFIK Eye 3000 by using two GRX-TVI Lutron 0-10V Dimming interfaces; one to tune and another to control dimming. Also compatible with Lutron VIVE system by using two FCJS-010 PowPak or FCJS-ECO EcoSystem PowPak modules per fixture; one to tune and one to control dimming.</p> 	✓	✓
<p>DMX (Available on Elite, LED Engin) - Compatible with Digital Multiplex Controller, Available with two options: DMX-512: Standard DMX Controller and DMX-RDM: DMX Controller with Remote Device Management.</p>	✓	✓
<p>LUTECO Compatible with Lutron EcoSystem. Compatible with Lutron GRAFIK Eye EcoSystem, Lutron Energi Saver node EcoSystem, or Lutron Quantum systems.</p>	✓	N/A
<p>DALI Compatible with Digital Addressable Lighting Interface, available with two options: DT6 and DT8.</p>	✓	✓