

**EASY 5 COLORS
SELECTOR**
2700K • 3000K • 3500K • 4000K • 5000K



2 HOUR FIRE RATING

Tested to comply with UL 263, ASTM E119 & CAN ULC S101

DIMENSION

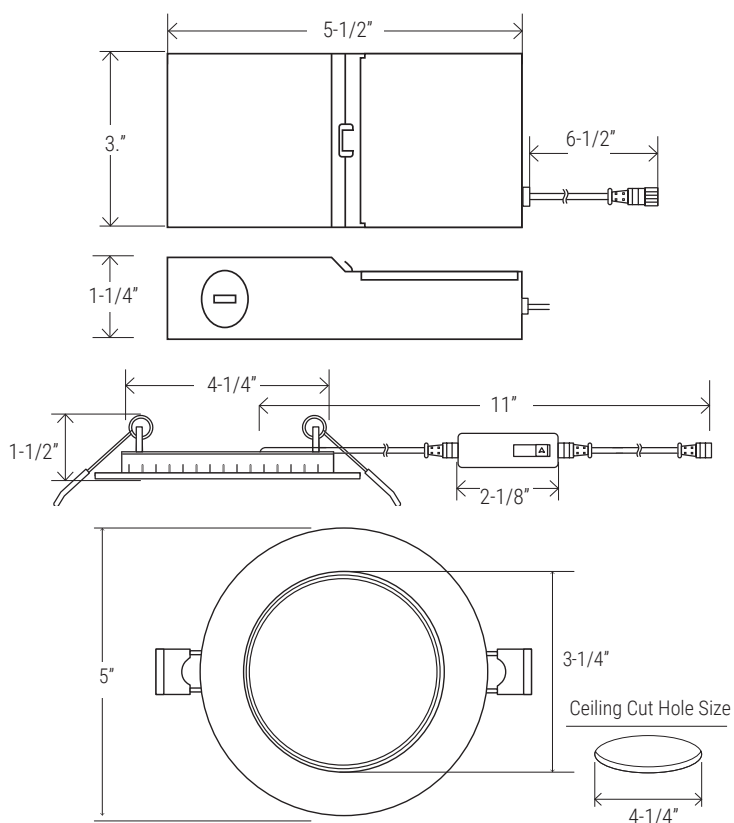

NOMINAL LUMENS	DELIVERED LUMENS	WATTAGE
800	805	11W

Based on 4000K, 90+ CRI. Actual wattage may vary +/- 5%

INSTALLATION

Cut hole in ceiling. Insert luminaire into opening by squeezing spring clips on both sides of luminaire. The width in ceiling needed for the driver to fit is 3".

You MUST seal all gaps between the ceiling and fixture with weatherproof silicone sealant. This deters moisture and water from damaging fixtures and other mechanical ceiling elements.

FEATURES

2 Hours Fire Rated 4" round multi-CCT LED "Slim Disk" engineered for new construction, remodel, or retrofit to accommodate insulated or dropped ceilings. Easily access field-adjustable 5-Color SeleCCTor switch by lowering the luminaire from the opening. Recessed housing not required, especially with limited plenum applications. Remote driver allows easy installation and maintenance. Small aperture and shallow depth are ideal for unlimited applications.

LUMENS	800
CCT	27K/30K/35K/40K/50K
CRI	90+
COLOR QUALITY	3-Step MacAdam Ellipse
CONSTRUCTION	Aluminum die-cast body and trim
TRIM OPTION	Round Baffle Lens
TRIM COLORS	WH (White)
DIMMING	DIMTR (Triac)
EMERGENCY	16W high voltage inverter (remote)
LIFETIME	L70 at 50,000 Hours
PHOTOMETRIC TESTS	In Accordance with IES LM79-08, LM80 and TM-30, TM-21

FEATURES

- 2-Hour fire rating providing a reinforced and heat resistant steel casing
- Selectable color temperature: 27K, 30K, 35K, 40K & 50K
- Junction box with commercial grade driver included
- Triac Dimmable, Certified airtight, IC rated
- Easy installation with Heavy-Duty Commercial Grade Steel spring clip
NO ADDITIONAL BOX REQUIRED
- Ambient operating temperature: -40°C (-40°F) to +40°C (+104°F).
- Aluminum Die Cast trim with powder paint coat preventing discoloring and rusting.
- ETL listed in USA & Canada. 2-HOUR FIRE RATING and complies with ASTM E119, UL 263. certified to CSA standard C22.2 No. 250.0-08
- 5-Year, no-compromise warranty.



SLIM TRIM



EXAMPLE:
FS-RL479-800L-DIMTR-120-27K/30K/35K/40K/50K-90-WH

TYPE	LUMEN	CCT	CRI	FINISH
FS-RL479	800L-DIMTR-120	27K/30K/35K/40K/50K	90+	WH - White

ACCESSORIES

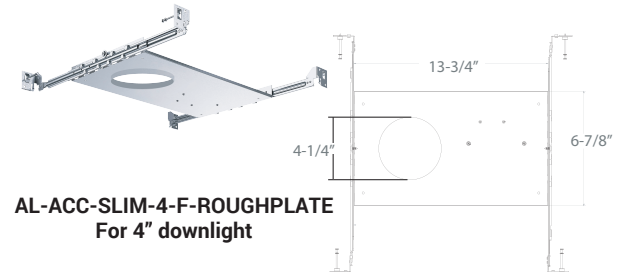
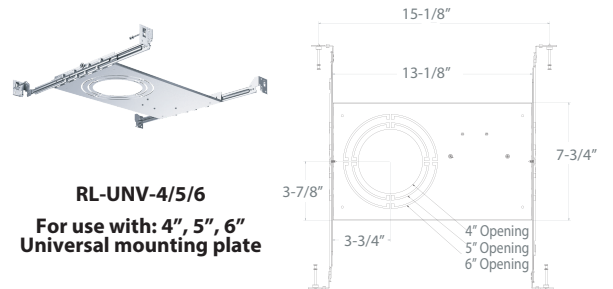

RL-ACC-SLIM-1-10F

OPTIONS

- ☐ RL-UNV-4/5/6 - Universal Mounting Plate for 4", 5" and 6"
- ☐ RL-ACC-SLIM-4-ROUGHPLATE - 4" Mounting Plate
- ☐ AL-ACC-SLIM-4-F-ROUGHPLATE - 4" Flanged Roughplate
- ☐ EMG-LED-G-16W-HV-FLEX - 16W high voltage inverter (remote)

FS-RL479-800L-DIMTR-120-27K-30K-35K-40K-50K-90-WH

TEST NO.: **EL08082309**

INPUT WATTS: **11.4**

LUMENS: **805**

EFFICACY: **71**

BEAM ANGLE: **109**

SPACING CRITERIA: **1.23**

CANDELA DISTRIBUTION

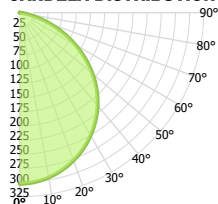

CANDELA TABLE

	0°	90°
0°	302	302
10°	296	298
20°	278	284
30°	250	259
40°	214	225
50°	168	181
60°	114	128
70°	57	70
80°	11	19
90°	0	0

LUMINANCE (cd/sq.m)

	0.00°	90.00°
0.00°	25909	25885
45.00°	23291	24714
55.00°	21110	23282
65.00°	17254	20146
75.00°	10203	14016
85.00°	1258	3872

LUMENS PER ZONE

ZONE	LUMENS
0° - 10°	30
10° - 20°	82
20° - 30°	124
30° - 40°	148
40° - 50°	152
50° - 60°	132
60° - 70°	91
70° - 80°	40
80° - 90°	6

ZONAL LUMEN SUMMARY

ZONE	UMENS	% LUMINAIRE
0° - 20°	112	14%
0° - 30°	236	29%
0° - 40°	384	48%
0° - 60°	669	83%
0° - 80°	800	99%
0° - 90°	805	100%

CONE OF LIGHT

MOUNTING HEIGHT	FC AT BEAM CENTER	BEAM DIA. 0°-180°	BEAM DIA. 90°-270°
6.0 ft	8.4 fc	16.9 ft	16.8 ft
8.0 ft	4.7 fc	22.5 ft	22.5 ft
10.0 ft	3.0 fc	28.1 ft	28.1 ft
12.0 ft	2.1 fc	33.7 ft	33.7 ft
14.0 ft	1.5 fc	39.4 ft	39.3 ft
16.0 ft	1.2 fc	45.0 ft	44.9 ft
18.0 ft	0.9 fc	50.6 ft	50.5 ft
20.0 ft	0.8 fc	56.2 ft	56.2 ft

INDOOR COEFFICIENTS OF UTILIZATION

pf pc pw	20%																		0%		
	80%				70%				50%				30%				10%				0%
	70%	50%	30%	10%	70%	50%	30%	10%	50%	30%	10%	50%	30%	10%	50%	30%	10%	0%			
0	119	119	119	119	116	116	116	116	111	111	111	106	106	106	102	102	102	100			
1	110	105	101	98	107	103	99	96	99	96	93	95	92	90	91	89	88	86			
2	100	92	86	80	98	90	85	80	87	82	78	84	80	76	81	77	74	72			
3	92	81	74	67	89	80	73	67	77	71	66	74	69	64	72	67	63	61			
4	84	72	64	57	82	71	63	57	69	62	56	66	60	55	64	59	55	53			
5	77	65	56	50	75	64	55	49	62	54	49	60	53	48	58	52	48	46			
6	71	58	50	43	70	57	49	43	56	48	43	54	47	42	52	47	42	40			
7	66	53	44	38	65	52	44	38	51	43	38	49	43	38	48	42	37	35			
8	62	48	40	34	60	48	40	34	46	39	34	45	39	34	44	38	34	32			
9	58	44	36	31	56	44	36	31	43	36	31	42	35	30	41	35	30	28			
10	54	41	33	28	53	40	33	28	40	33	28	39	32	28	38	32	28	26			