

**EASY 5 COLORS
SELECTOR**
2700K • 3000K • 3500K • 4000K • 5000K



2 HOUR FIRE RATING

Tested to comply with UL 263, ASTM E119 & CAN ULC S101

DIMENSION

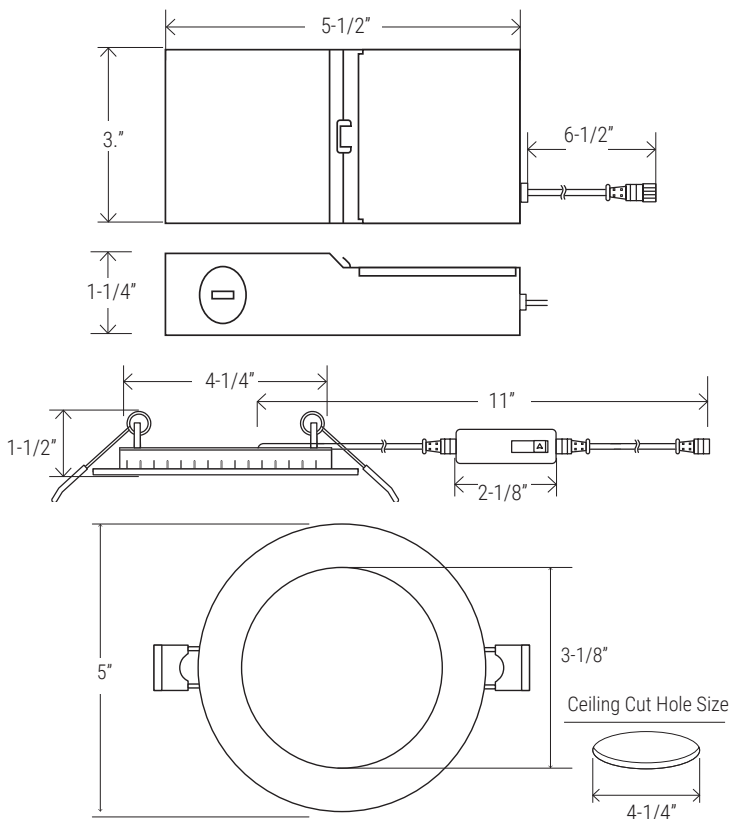

NOMINAL LUMENS	DELIVERED LUMENS	WATTAGE
800	817	11W

Based on 4000K, 90+ CRI. Actual wattage may vary +/- 5%

INSTALLATION

Cut hole in ceiling. Insert luminaire into opening by squeezing spring clips on both sides of luminaire. The width in ceiling needed for the driver to fit is 3".

You MUST seal all gaps between the ceiling and fixture with weatherproof silicone sealant. This deters moisture and water from damaging fixtures and other mechanical ceiling elements.

FEATURES

2 Hours Fire Rated 4" round multi-CCT LED "Slim Disk" engineered for new construction, remodel, or retrofit to accommodate insulated or dropped ceilings. Easily access field-adjustable 5-Color SeleCCTor switch by lowering the luminaire from the opening. Recessed housing not required, especially with limited plenum applications. Remote driver allows easy installation and maintenance. Small aperture and shallow depth are ideal for unlimited applications.

LUMENS	800
CCT	27K/30K/35K/40K/50K
CRI	90+
COLOR QUALITY	3-Step MacAdam Ellipse
CONSTRUCTION	Aluminum die-cast body and trim
TRIM OPTION	Round Flat Lens
TRIM COLORS	WH (White), BK (Black), BZ (Bronze), CP (Copper) and CH (Chrome)
DIMMING	DIMTR (Triac)
EMERGENCY	16W high voltage inverter (remote)
LIFETIME	L70 at 50,000 Hours
PHOTOMETRIC TESTS	In Accordance with IES LM79-08, LM80 and TM-30, TM-21

FEATURES

- 2-Hour fire rating providing a reinforced and heat resistant steel casing
- Selectable color temperature: 27K, 30K, 35K, 40K & 50K
- Junction box with commercial grade driver included
- Triac Dimmable, Certified airtight, IC rated
- Easy installation with Heavy-Duty Commercial Grade Steel spring clip
NO ADDITIONAL BOX REQUIRED
- Ambient operating temperature: -40°C (-40°F) to +40°C (+104°F).
- Aluminum Die Cast trim with powder paint coat preventing discoloring and rusting.
- ETL listed in USA & Canada. 2-HOUR FIRE RATING and complies with ASTM E119, UL 263. certified to CSA standard C22.2 No. 250.0-08
- 5-Year, no-compromise warranty.



SLIM TRIM



EXAMPLE:
FS-RL475-800L-DIMTR-120-27K/30K/35K/40K/50K-90-WH

TYPE	LUMEN	CCT	CRI	FINISH
FS-RL475	<input type="checkbox"/> 800L-DIMTR-120	<input type="checkbox"/> 27K/30K/35K/40K/50K	<input type="checkbox"/> 90+	<input type="checkbox"/> WH - White

TRIM RINGS



RL475-RT-BK
(Black)



RL475-RT-BZ
(Bronze)



RL475-RT-CH
(Chrome)



RL475-RT-CP
(Copper)

RL475-RT-BZ

ACCESSORIES

- ☐ RL475-RT-BZ-Bronze
- ☐ RL475-RT-BK-Black
- ☐ RL475-RT-CH-Chrome
- ☐ RL475-RT-CP-Copper

ACCESSORIES

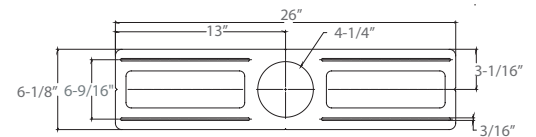
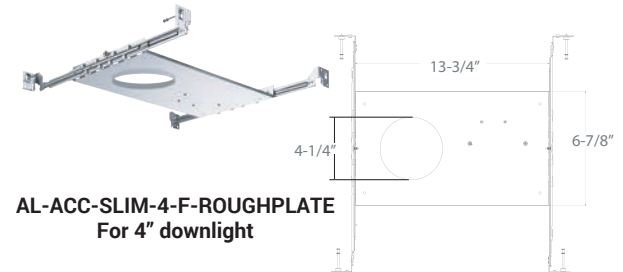
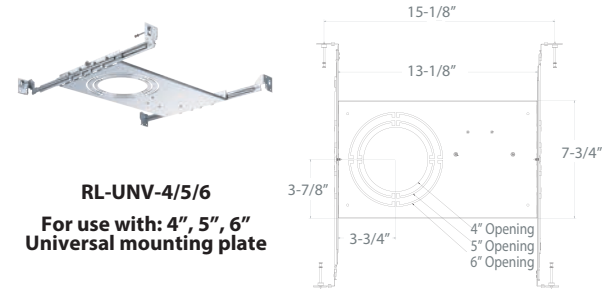

RL-ACC-SLIM-1-10F

OPTIONS

- ☐ RL-UNV-4/5/6 - Universal Mounting Plate for 4", 5" and 6"
- ☐ RL-ACC-SLIM-4-ROUGHPLATE - 4" Mounting Plate
- ☐ AL-ACC-SLIM-4-F-ROUGHPLATE - 4" Flanged Roughplate
- ☐ EMG-LED-G-16W-HV-FLEX - 16W high voltage inverter (remote)

FS-RL475-800L-DIMTR-120-27K-30K-35K-40K-50K-90-WH

TEST NO.: **EL03212325**

INPUT WATTS: **11.3**

LUMENS: **817**

EFFICACY: **72**

BEAM ANGLE: **110**

SPACING CRITERIA: **1.24**

CANDELA DISTRIBUTION

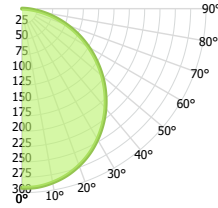

CANDELA TABLE

	0°	90°
0°	292	292
10°	288	288
20°	272	273
30°	246	247
40°	212	213
50°	171	173
60°	125	127
70°	78	80
80°	33	36
90°	0	0

LUMINANCE (cd/sq.m)

	0.00°	90.00°
0.00°	100102	100174
45.00°	92897	93871
55.00°	88474	89889
65.00°	82507	84210
75.00°	72981	75933
85.00°	53582	60147

LUMENS PER ZONE

ZONE	LUMENS
0° - 10°	29
10° - 20°	79
20° - 30°	119
30° - 40°	142
40° - 50°	146
50° - 60°	130
60° - 70°	99
70° - 80°	57
80° - 90°	16

ZONAL LUMEN SUMMARY

ZONE	UMENS	% LUMINAIRE
0° - 20°	108	13%
0° - 30°	227	28%
0° - 40°	369	45%
0° - 60°	645	79%
0° - 80°	801	98%
0° - 90°	816	100%

CONE OF LIGHT

MOUNTING HEIGHT	FC AT BEAM CENTER	BEAM DIA. 0°-180°	BEAM DIA. 90°-270°
6.0 ft	8.1 fc	17.1 ft	17.2 ft
8.0 ft	4.6 fc	22.8 ft	22.9 ft
10.0 ft	2.9 fc	28.4 ft	28.7 ft
12.0 ft	2.0 fc	34.1 ft	34.4 ft
14.0 ft	1.5 fc	39.8 ft	40.2 ft
16.0 ft	1.1 fc	45.5 ft	45.9 ft
18.0 ft	0.9 fc	51.2 ft	51.6 ft
20.0 ft	0.7 fc	56.9 ft	57.4 ft

INDOOR COEFFICIENTS OF UTILIZATION

pf	20%																		0%		
pc	80%				70%				50%				30%				10%				0%
pw	70%	50%	30%	10%	70%	50%	30%	10%	50%	30%	10%	50%	30%	10%	50%	30%	10%	0%			
0	119	119	119	119	116	116	116	116	111	111	111	106	106	106	102	102	102	100			
1	109	104	100	96	106	102	98	94	97	94	91	94	91	88	90	88	86	84			
2	99	91	84	78	96	89	82	77	85	80	75	82	77	74	79	75	72	70			
3	90	80	71	65	88	78	70	64	75	68	63	72	67	62	70	65	61	59			
4	83	71	62	55	80	69	61	55	67	60	54	64	58	53	62	57	52	50			
5	76	63	54	47	74	62	53	47	60	52	47	58	51	46	56	50	46	43			
6	70	57	48	41	68	56	47	41	54	46	41	52	46	40	51	45	40	38			
7	65	52	43	37	63	51	42	36	49	42	36	48	41	36	46	40	36	34			
8	61	47	39	33	59	46	38	33	45	38	32	44	37	32	43	36	32	30			
9	57	43	35	29	55	43	35	29	41	34	29	40	34	29	39	33	29	27			
10	53	40	32	27	52	39	32	27	38	31	26	37	31	26	37	31	26	24			