



**EASY 5 COLORS
SELECTOR**
2700K • 3000K • 3500K • 4000K • 5000K



2 HOUR FIRE RATING

Tested to comply with UL 263, ASTM E119 & CAN ULC S101

DIMENSION

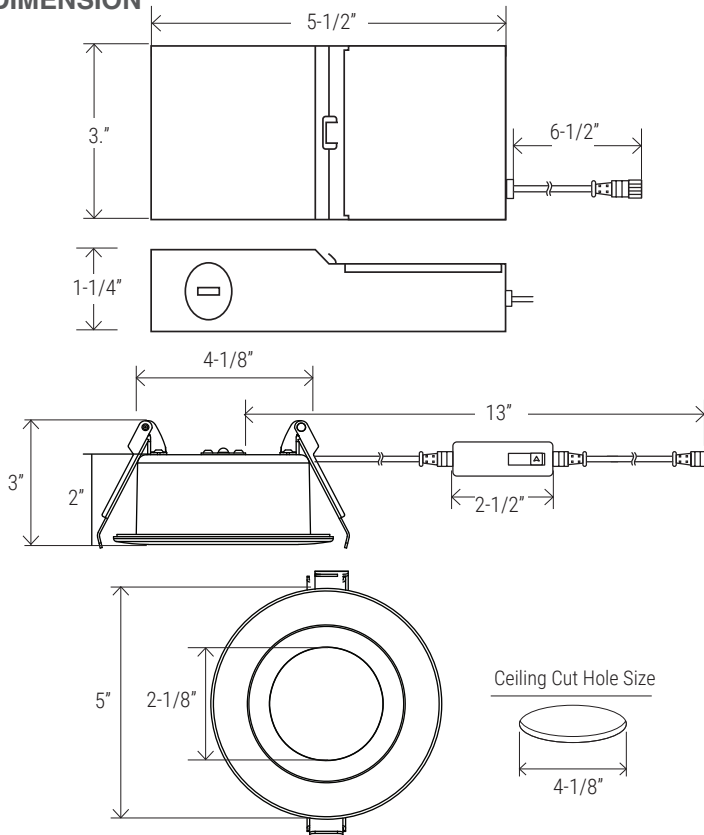

NOMINAL LUMENS	DELIVERED LUMENS	WATTAGE
600	639	10W

Based on 4000K, 90+ CRI. Actual wattage may vary +/- 5%

INSTALLATION

Cut hole in ceiling. Insert luminaire into opening by squeezing spring clips on both sides of luminaire. The width in ceiling needed for the driver to fit is 3".

You MUST seal all gaps between the ceiling and fixture with weatherproof silicone sealant. This deters moisture and water from damaging fixtures and other mechanical ceiling elements.

FEATURES

2 Hours Fire Rated 4" round multi-CCT LED "Slim Disk" engineered for new construction, remodel, or retrofit to accommodate insulated or dropped ceilings. Easily access field-adjustable 5-Color SeleCCTor switch by lowering the luminaire from the opening. Recessed housing not required, especially with limited plenum applications. Remote driver allows easy installation and maintenance. Small aperture and shallow depth are ideal for unlimited applications.

LUMENS	600
CCT	27K/30K/35K/40K/50K
CRI	90+
COLOR QUALITY	3-Step MacAdam Ellipse
CONSTRUCTION	Aluminum die-cast body and trim
TRIM OPTION	Round Flat Lens
TRIM COLORS	WH (White)
DIMMING	DIMTR (Triac)
EMERGENCY	16W high voltage inverter (remote)
LIFETIME	L70 at 50,000 Hours
PHOTOMETRIC TESTS	In Accordance with IES LM79-08, LM80 and TM-30, TM-21

FEATURES

- 2-Hour fire rating providing a reinforced and heat resistant steel casing
- Selectable color temperature: 27K, 30K, 35K, 40K & 50K
- Junction box with commercial grade driver included
- Triac Dimmable, Certified airtight, IC rated
- Easy installation with Heavy-Duty Commercial Grade Steel spring clip
NO ADDITIONAL BOX REQUIRED
- Ambient operating temperature: -40°C (-40°F) to +40°C (+104°F).
- Aluminum Die Cast trim with powder paint coat preventing discoloring and rusting.
- ETL listed in USA & Canada. 2-HOUR FIRE RATING and complies with ASTM E119, UL 263. certified to CSA standard C22.2 No. 250.0-08
- 5-Year, no-compromise warranty.



SLIM TRIM



EXAMPLE:

FS-RL440-600L-DIMTR-120-27K/30K/35K/40K/50K-90-W-WH

TYPE	LUMEN	CCT	CRI	FINISH
FS-RL440	600L-DIMTR-120	27K/30K/35K/40K/50K	90+	W-WH

ACCESSORIES



RL-UNV-4/5/6

For use with: 4", 5", 6"
Universal mounting plate

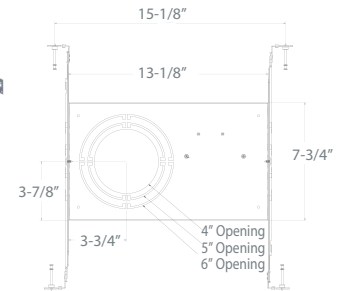

AL-ACC-SLIM-4-F-ROUGHPLATE
For 4" downlight

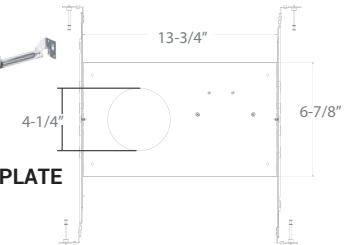

RL-ACC-SLIM-4-ROUGHPLATE
Rough-in plate for use with 4" downlights

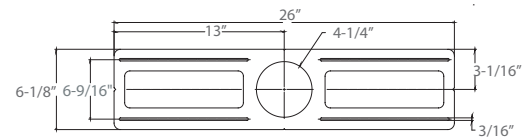

RL-ACC-SLIM-1-10F

OPTIONS

- ☐ RL-UNV-4/5/6 - Universal Mounting Plate for 4", 5" and 6"
- ☐ RL-ACC-SLIM-4-ROUGHPLATE - 4" Mounting Plate
- ☐ AL-ACC-SLIM-4-F-ROUGHPLATE - 4" Flanged Roughplate
- ☐ EMG-LED-G-16W-HV-FLEX - 16W high voltage inverter (remote)

FS-RL440-600L-DIMTR-120V-27K-30K-35K-40K-50K-90

TEST NO.: **EL03142317**

INPUT WATTS: **9.8**

LUMENS: **639**

EFFICACY: **65**

BEAM ANGLE: **96**

SPACING CRITERIA: **1.17**

CANDELA DISTRIBUTION

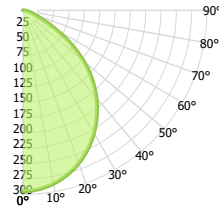

CANDELA TABLE

	0°	90°
0°	295	295
10°	287	290
20°	265	272
30°	231	240
40°	186	195
50°	129	139
60°	61	70
70°	20	24
80°	6	8
90°	0	0

LUMINANCE (cd/sq.m)

	0.00°	90.00°
0.00°	25307	25307
45.00°	19316	20439
55.00°	14257	15755
65.00°	7019	8306
75.00°	3975	4690
85.00°	1523	3332

LUMENS PER ZONE

ZONE	LUMENS
0° - 10°	30
10° - 20°	79
20° - 30°	117
30° - 40°	134
40° - 50°	127
50° - 60°	91
60° - 70°	42
70° - 80°	16
80° - 90°	4

ZONAL LUMEN SUMMARY

ZONE	UMENS	% LUMINAIRE
0° - 20°	108	17%
0° - 30°	225	35%
0° - 40°	359	56%
0° - 60°	577	90%
0° - 80°	634	99%
0° - 90°	638	100%

CONE OF LIGHT

MOUNTING HEIGHT	FC AT BEAM CENTER	BEAM DIA. 0°-180°	BEAM DIA. 90°-270°
6.0 ft	8.2 fc	13.4 ft	13.4 ft
8.0 ft	4.6 fc	17.8 ft	17.8 ft
10.0 ft	3.0 fc	22.3 ft	22.3 ft
12.0 ft	2.1 fc	26.7 ft	26.7 ft
14.0 ft	1.5 fc	31.2 ft	31.2 ft
16.0 ft	1.2 fc	35.7 ft	35.7 ft
18.0 ft	0.9 fc	40.1 ft	40.1 ft
20.0 ft	0.7 fc	44.6 ft	44.6 ft

INDOOR COEFFICIENTS OF UTILIZATION

pf	20%																0%				
pc	80%				70%				50%				30%				10%				0%
pw	70%	50%	30%	10%	70%	50%	30%	10%	50%	30%	10%	50%	30%	10%	50%	30%	10%	0%			
0	119	119	119	119	116	116	116	116	111	111	111	106	106	106	102	102	102	100			
1	111	107	103	100	108	105	101	98	100	98	95	97	94	93	93	91	90	88			
2	102	95	89	85	100	93	88	84	90	86	82	87	83	80	84	81	78	76			
3	94	85	78	72	92	84	77	72	81	75	71	78	73	69	76	72	68	66			
4	87	76	69	63	85	75	68	62	73	66	61	71	65	61	68	64	60	58			
5	81	69	61	55	79	68	60	55	66	59	54	64	58	54	62	57	53	51			
6	75	63	54	49	73	62	54	48	60	53	48	58	52	48	57	51	47	45			
7	70	57	49	43	68	56	49	43	55	48	43	54	47	43	52	47	42	41			
8	65	52	45	39	64	52	44	39	51	44	39	49	43	39	48	43	38	37			
9	61	48	41	35	60	48	40	35	47	40	35	46	39	35	45	39	35	33			
10	57	45	37	32	56	44	37	32	43	37	32	42	36	32	42	36	32	30			