



**EASY 5 COLORS
SELECCTOR**
2700K • 3000K • 3500K • 4000K • 5000K



2 HOUR FIRE RATING

Tested to comply with UL 263, ASTM E119 & CAN ULC S101

DIMENSION

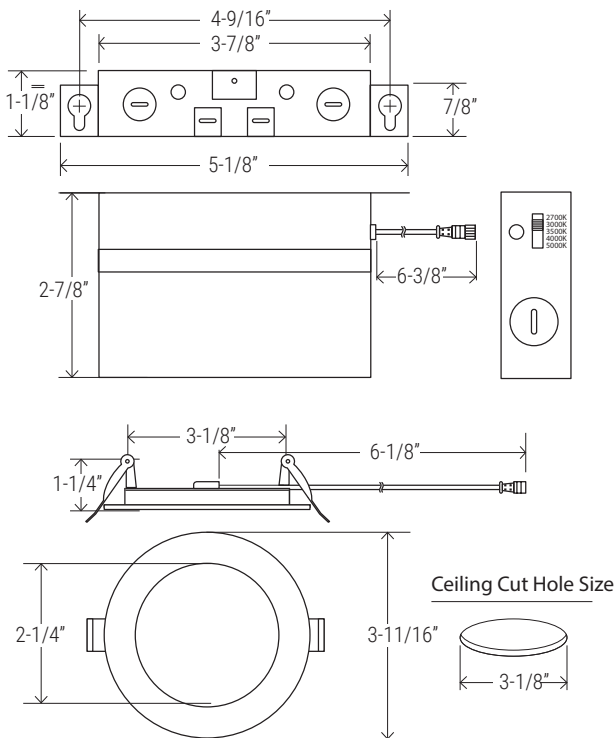

NOMINAL LUMENS	DELIVERED LUMENS	WATTAGE
500	455	8W

Based on 4000K, 90+ CRI. Actual wattage may vary +/- 5%

INSTALLATION

Cut hole in ceiling. Insert luminaire into opening by squeezing spring clips on both sides of luminaire. The width in ceiling needed for the driver to fit is 3".

You MUST seal all gaps between the ceiling and fixture with weatherproof silicone sealant. This deters moisture and water from damaging fixtures and other mechanical ceiling elements.

FEATURES

2 Hours Fire Rated 3" round multi-CCT LED "Slim Disk" engineered for new construction, remodel, or retrofit to accommodate insulated or dropped ceilings. Easily access field-adjustable 5-Color SeleCCTor switch by lowering the luminaire from the opening. Recessed housing not required, especially with limited plenum applications. Remote driver allows easy installation and maintenance. Small aperture and shallow depth are ideal for unlimited applications.

LUMENS	500
CCT	27K/30K/35K/40K/50K
CRI	90+
COLOR QUALITY	3-Step MacAdam Ellipse
CONSTRUCTION	Aluminum die-cast body and trim
TRIM OPTION	Round Flat Lens
COLORS	WH (White-standard) BZ (Bronze), BK (Black), CP (Copper), SN (Satin Nickel)
DIMMING	DIMTR (Triac)
EMERGENCY	16W high voltage inverter (remote)
LIFETIME	L70 at 50,000 Hours
PHOTOMETRIC TESTS	In Accordance with IES LM79-08, LM80 and TM-30, TM-21

FEATURES

- 2-Hour fire rating providing a reinforced and heat resistant steel casing
- Selectable color temperature: 27K, 30K, 35K, 40K & 50K
- Junction box with commercial grade driver included
- Triac Dimmable, Certified airtight, IC rated
- Easy installation with Heavy-Duty Commercial Grade Steel spring clip
NO ADDITIONAL BOX REQUIRED
- Ambient operating temperature: -40°C (-40°F) to +40°C (+104°F).
- Aluminum Die Cast trim with powder paint coat preventing discoloring and rusting.
- ETL listed in USA & Canada. 2-HOUR FIRE RATING and complies with ASTM E119, UL 263. certified to CSA standard C22.2 No. 250.0-08
- 5-Year, no-compromise warranty.



SLIM TRIM



EXAMPLE:
FS-RL375-500L-DIMTR-120-27K/30K/35K/40K/50K-90

TYPE	LUMEN	CCT	CRI	FINISH
RL375	<input type="checkbox"/> 500L-DIMTR-120	<input type="checkbox"/> 27K/30K/35K/40K/50K	<input type="checkbox"/> 90+	<input type="checkbox"/> WH - White

TRIM RINGS



FS-RL375-RT-BK
(Black)



FS-RL375-RT-BZ
(Bronze)



FS-RL375-RT-CP
(Copper)



FS-RL375-RT-SN
(Satin Nickel)

FS-RL375-RT-BZ

INSERTS

- ☐ FS-RL375-RT-BZ-Bronze
- ☐ FS-RL375-RT-CP-Copper
- ☐ FS-RL375-RT-BK-Black
- ☐ FS-RL375-RT-SN-Satin Nickel

ACCESSORIES

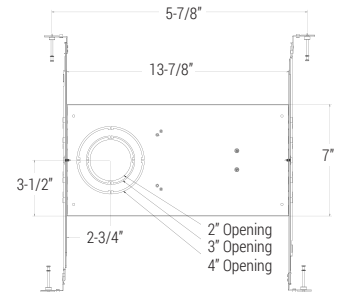

RL-UNV-2/3/4
For use with: 2", 3", 4"
Universal mounting plate

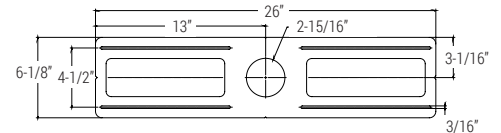

RL-ACC-SLIM-3-ROUGHPLATE
Rough-in plate for use with 3" downlights

RL-ACC-SLIM-1-10F

OPTIONS

- ☐ RL-UNV-2/3/4 - Universal Mounting Plate for 2", 3" and 4"
- ☐ RL-ACC-SLIM-3-ROUGHPLATE - 3" Mounting Plate
- ☐ EMG-LED-G-16W-HV-FLEX - 16W high voltage inverter (remote)

FS-RL375-500L-DIMTR-120-27K-30K-35K-40K-50K-90-WH

TEST NO.: **EL08082308**

INPUT WATTS: **8.0**

LUMENS: **455**

EFFICACY: **57**

BEAM ANGLE: **108**

SPACING CRITERIA: **1.20**

CANDELA DISTRIBUTION

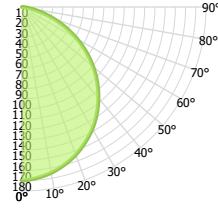

CANDELA TABLE

	0°	90°
0°	170	171
10°	165	168
20°	154	159
30°	138	144
40°	116	124
50°	91	99
60°	62	71
70°	32	41
80°	9	15
90°	0	0

LUMINANCE (cd/sq.m)

	0.00°	90.00°
0.00°	14539	14659
45.00°	12601	13567
55.00°	11457	12746
65.00°	9485	11358
75.00°	6268	8956
85.00°	2280	5592

LUMENS PER ZONE

ZONE	LUMENS
0° - 10°	17
10° - 20°	46
20° - 30°	69
30° - 40°	83
40° - 50°	84
50° - 60°	73
60° - 70°	52
70° - 80°	26
80° - 90°	6

ZONAL LUMEN SUMMARY

ZONE	UMENS	% LUMINAIRE
0° - 20°	63	14%
0° - 30°	132	29%
0° - 40°	214	47%
0° - 60°	372	82%
0° - 80°	449	99%
0° - 90°	455	100%

CONE OF LIGHT

MOUNTING HEIGHT	FC AT BEAM CENTER	BEAM DIA. 0°-180°	BEAM DIA. 90°-270°
6.0 ft	4.7 fc	16.5 ft	16.6 ft
8.0 ft	2.7 fc	22.0 ft	22.1 ft
10.0 ft	1.7 fc	27.6 ft	27.6 ft
12.0 ft	1.2 fc	33.1 ft	33.1 ft
14.0 ft	0.9 fc	38.6 ft	38.6 ft
16.0 ft	0.7 fc	44.1 ft	44.2 ft
18.0 ft	0.5 fc	49.6 ft	49.7 ft
20.0 ft	0.4 fc	55.1 ft	55.2 ft

INDOOR COEFFICIENTS OF UTILIZATION

pf	20%																0%	
pc	80%																0%	
pw	70%	50%	30%	10%	70%	50%	30%	10%	50%	30%	10%	50%	30%	10%	50%	30%	10%	0%
0	119	119	119	119	116	116	116	116	111	111	111	106	106	106	102	102	102	100
1	109	105	101	97	107	103	99	95	98	95	92	94	92	90	91	89	87	85
2	100	92	85	80	97	90	84	79	86	81	77	83	79	75	80	77	73	71
3	91	81	73	67	89	79	72	66	76	70	65	74	68	64	71	66	63	60
4	84	72	63	57	81	70	62	56	68	61	55	66	60	55	63	58	54	52
5	77	64	55	49	75	63	55	49	61	54	48	59	53	48	57	52	47	45
6	71	58	49	43	69	57	49	43	55	48	42	53	47	42	52	46	41	39
7	66	53	44	38	64	52	44	38	50	43	37	49	42	37	47	41	37	35
8	61	48	40	34	60	47	39	34	46	39	34	45	38	33	44	38	33	31
9	57	44	36	30	56	44	36	30	42	35	30	41	35	30	40	34	30	28
10	54	41	33	28	53	40	33	28	39	32	27	38	32	27	37	31	27	25