



**MULTI LUMEN
SELECTOR**

**EASY 5 COLORS
SELECTOR**
2700K • 3000K • 3500K • 4000K • 5000K

2-HOUR FIRE RATING

Tested to comply with UL 263, ASTM E119 & CAN ULC S101

DIMENSIONS

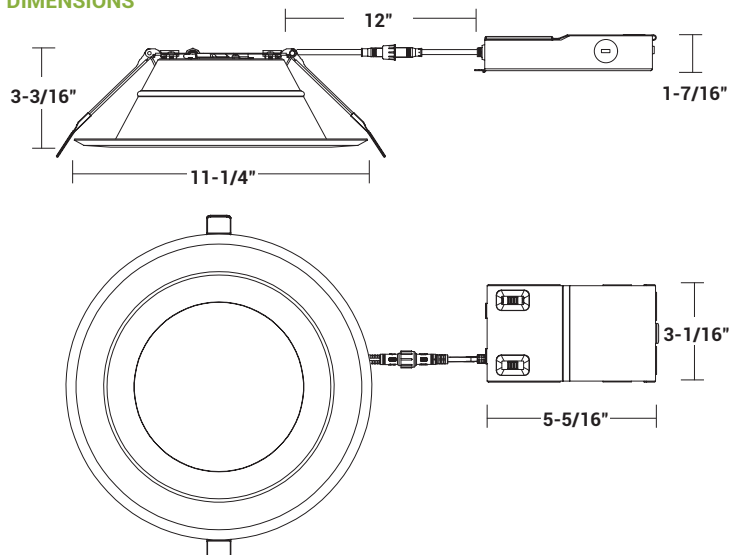

Recommended Hole Cut-out Size: 8-1/16"

NOMINAL LUMENS	DELIVERED LUMENS	WATTAGE
3000L	3137L	23W
3500L	4005L	31W
4000L	4340L	34W

Based on 4000K, 90+ CRI. Actual wattage may vary +/- 5%

INSTALLATION

Cut hole in ceiling. Insert luminaire into opening by squeezing spring clips on both sides of luminaire. The width in ceiling needed for the driver to fit is 3".

For wet location application, you **MUST** seal all gaps between the ceiling and fixture with weatherproof silicone sealant. This deters moisture and water from damaging fixtures and other mechanical ceiling elements.



FEATURES

SAFETY AND SOPHISTICATION

This 10", 2-hour fire rated downlight features a recessed design and regressed lens for a modern, low-glare look that capitalizes on both safety and aesthetics. 0-10V dimming, and selectable lumen and CCT options make for versatile application and are easily accessed by lowering the luminaire from the ceiling. Ideal for general lighting in recessed retrofit, remodel, and new construction applications in apartments, dormitories, corporate commercial, retail, and hospitality spaces.

Remote driver and small aperture allow for easy installation. Accommodates low plenum spaces and insulated and dropped ceilings. No housing necessary.

LUMENS	3000L/3500L/4000L
CCT	27K/30K/35K/40K/50K
CRI	90+ Standard
COLOR QUALITY	3-Step MacAdam Ellipse
MOUNTING	Recessed
DIMMING	DIM10 - 0-10V Flicker-free 1% Dimming
BEAM ANGLE	Very Wide (VWD) at 85°
FINISH	White (WH) Standard
TRIM COLOR	White (W)
WORKING TEMP.	-20°C (-4°F) to 40°C (104°F)
EMERGENCY	15W High Voltage Inverter (Remote)
LIFETIME	L70 at 50,000 Hours
PHOTOMETRIC	In accordance with IES LM79-08, LM80 and TM-30, TM-21

- Can be installed in shallow plenum spaces
- May be installed in drywall or suspended ceilings
- Even illumination achieved with patent-pending optics and edge-lit LED technology
- Ideal where ceiling or top access is unavailable



OPTICS

Features a regressed polycarbonate lens and reflector for an optimal, glare-free beam.

A beam angle of 85° translates to a Very Wide indoor distribution (VWD), for broad reaching illumination.

Available in a lumen set of 3000L/3500L/4000L and with 5 selectable CCT options of 27K/30K/35K/40K/50K for selectable warm to cool color atmospheres.

CCT factory set to 5000K; lumen factory set to 4000L.

CONSTRUCTION

Housing and reflector made from a durable, lightweight spun iron. A reinforced and heat resistant steel casing ensures a 2-hour fire rating.

A slim profile and remote driver allows for use in low plenum spaces. Pre-installed torsion clips allow for easy and fast recessed installation; no recessed housing necessary.

Junction box with commercial grade driver included. Lumen and CCT switch located on driver.

Sealed for wet location use. Airtight, non-IC rated.

Available in a trademark red housing with a white trim finish.

MAINTENANCE

Fixture can be regularly and safely wiped down to ensure optimal fixture performance.

MOUNTING

Suitable for recessed mounting in retrofit, remodel, and new construction applications. Ideal where ceiling or top access is unavailable. Compatible with various rough plates for new construction use. 8-1/16" installation hole size.

OPTIONS & ACCESSORIES

Available to order with 15W emergency battery backup option.

Extension cable options:

- RL-ACC-SLIM-1-10F (10-ft)
- RL-ACC-SLIM-1-20F (20-ft)

Rough plate options:

- RL-UNV-1/2/3/4/5/6/8/10 for use with 1", 2", 3", 4", 5", 6", 8" and 10" downlights

See order chart for details.

DRIVER & ELECTRICAL INFORMATION

Powered by high-quality constant-current power LED drivers which are rated for 50 to 60Hz at 120V-277V input, produce less than 20% THD, and have a power factor of .90 to 1.00.

DIMMING

DIM10 - 0-10V 1% Dimming at 120-277V.

WARRANTY

5-year warranty for parts and components (labor not included).

LISTINGS

UL listed.

Energy Star certified.

Wet location suitable.

Title 24 and JA8 compliant.

Non-IC rated.

2-hour fire rating complies with ASTM E119, UL263. Certified to CSA standard C22.2 No. 250.0-08.

MULTI-LUMEN & MULTI-CCT SWITCHES

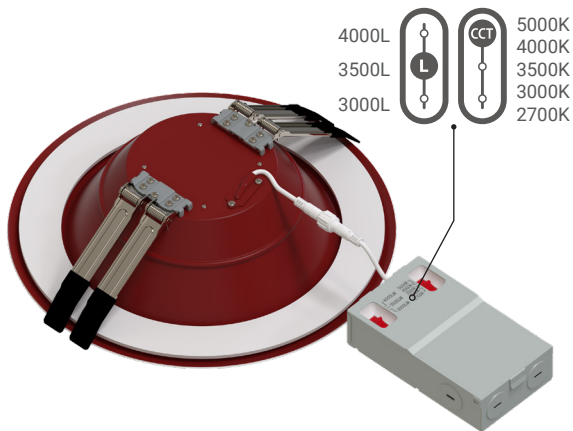

OPTION & ACCESSORIES



RL-ACC-SLIM-1-10F
10-ft long extension

RL-ACC-SLIM-1-20F
20-ft long extension

RL-UNV-1/2/3/4/5/6/8/10

For use with 1", 2", 3", 4", 5", 6", 8", and 10" downlights

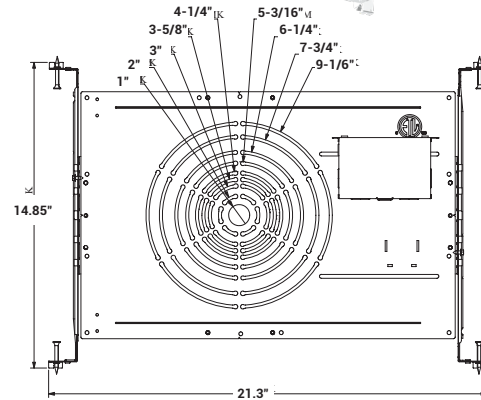

Example: **FS-RL1044-3000L/3500L/4000L-DIM10-MVOLT-27K/30K/35K/40K/50K-90-W-WH**

SERIES	LUMENS	DIMMING	CCT	FINISH	OPTION / ACCESSORIES
FS-RL1044	3000L/3500L/4000L	DIM10/MVOLT	27K/30K/35K/40K/50K	W-WH - White	RL-ACC-SLIM-1-10F - 10-ft long extension RL-ACC-SLIM-1-20F - 20-ft long extension RL-UNV-1/2/3/4/5/6/8/10 - Universal Mounting Plate for 1", 2", 3", 4", 5", 6", 8" and 10" O-EMG-LED-JBOX-15W-FLEX (Remote) - 15W Emergency Back up (Remote)

FS-RL1044-3000L-3500L-4000L-DIM10-MVOLT-27K-30K-35K-40K-50K(3000L)

TEST NO.: **EL08142422**

INPUT WATTS: **23.1**

LUMENS: **3137**

EFFICACY: **136**

BEAM ANGLE: **93**

SPACING CRITERIA: **1.15**

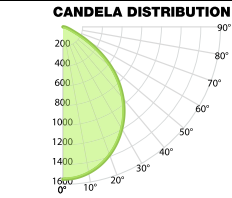

CANDELA TABLE		
	0°	90°
0°	1548	1548
10°	1505	1502
20°	1383	1393
30°	1192	1215
40°	945	978
50°	641	689
60°	278	336
70°	73	86
80°	24	30
90°	0	0

LUMINANCE (cd/sq.m)		
	0.00°	90.00°
0.00°	33139	33139
45.00°	24215	25417
55.00°	17272	19466
65.00°	6838	8763
75.00°	3471	4114
85.00°	1985	3135

LUMENS PER ZONE	
ZONE	LUMENS
0° - 10°	154
10° - 20°	408
20° - 30°	596
30° - 40°	676
40° - 50°	626
50° - 60°	436
60° - 70°	173
70° - 80°	53
80° - 90°	14

ZONAL LUMEN SUMMARY		
ZONE	LUMENS	% LUMINAIRE
0° - 20°	562	18%
0° - 30°	1159	37%
0° - 40°	1834	58%
0° - 60°	2896	92%
0° - 80°	3122	100%
0° - 90°	3136	100%

CONE OF LIGHT

MOUNTING HEIGHT	FC AT BEAM CENTER	BEAM DIA. 0° -180°	BEAM DIA. 90° -270°
6.0 ft	43.0 fc	12.6 ft	12.5 ft
8.0 ft	24.2 fc	16.9 ft	16.7 ft
10.0 ft	15.5 fc	21.1 ft	20.9 ft
12.0 ft	10.7 fc	25.3 ft	25.1 ft
14.0 ft	7.9 fc	29.5 ft	29.3 ft
16.0 ft	6.0 fc	33.7 ft	33.5 ft
18.0 ft	4.8 fc	37.9 ft	37.6 ft
20.0 ft	3.9 fc	42.1 ft	41.8 ft

INDOOR COEFFICIENTS OF UTILIZATION

ρ _c	ρ _w	20%																0%		
		80%				70%				50%				30%				10%	0%	
		70%	50%	30%	10%	70%	50%	30%	10%	70%	50%	30%	10%	50%	30%	10%	50%	30%	10%	0%
0	119	119	119	119	119	116	116	116	116	111	111	111	111	106	106	106	102	102	102	100
1	111	107	104	101	109	105	102	99	101	98	96	97	95	93	94	92	90	89	87	89
2	103	96	90	86	100	94	89	85	91	87	83	88	84	81	85	82	79	77	75	77
3	95	86	79	74	93	85	78	73	82	76	72	79	75	71	77	73	70	68	66	68
4	88	78	70	64	86	76	69	64	74	68	63	72	66	62	70	65	61	59	57	59
5	82	70	62	56	80	69	62	56	67	61	56	65	59	55	63	58	54	53	51	53
6	76	64	56	50	74	63	55	50	61	54	49	60	54	49	58	53	49	47	45	47
7	71	58	50	45	69	58	50	45	56	49	44	55	49	44	53	48	44	42	40	42
8	66	54	46	40	65	53	45	40	52	45	40	50	44	40	49	44	40	38	36	38
9	62	49	42	37	60	49	42	37	48	41	36	47	41	36	46	40	36	34	32	34
10	58	46	38	34	57	45	38	33	44	38	33	43	37	33	43	37	33	31	29	31

FS-RL1044-3000L-3500L-4000L-DIM10-MVOLT-27K-30K-35K-40K-50K(3500L)

TEST NO.: **EL08142422**

INPUT WATTS: **30.8**

LUMENS: **4005**

EFFICACY: **130**

BEAM ANGLE: **92**

SPACING CRITERIA: **1.14**

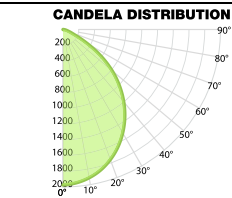

CANDELA TABLE		
	0°	90°
0°	1974	1974
10°	1912	1963
20°	1757	1821
30°	1515	1589
40°	1199	1280
50°	812	902
60°	351	442
70°	92	114
80°	30	39
90°	0	0

LUMINANCE (cd/sq.m)		
	0.00°	90.00°
0.00°	42268	42268
45.00°	30716	33259
55.00°	21874	25499
65.00°	8629	11642
75.00°	4382	5429
85.00°	2486	4165

LUMENS PER ZONE	
ZONE	LUMENS
0° - 10°	197
10° - 20°	521
20° - 30°	761
30° - 40°	862
40° - 50°	799
50° - 60°	556
60° - 70°	222
70° - 80°	68
80° - 90°	18

ZONAL LUMEN SUMMARY		
ZONE	LUMENS	% LUMINAIRE
0° - 20°	718	18%
0° - 30°	1478	37%
0° - 40°	2341	58%
0° - 60°	3696	92%
0° - 80°	3986	100%
0° - 90°	4003	100%

CONE OF LIGHT

MOUNTING HEIGHT	FC AT BEAM CENTER	BEAM DIA. 0° -180°	BEAM DIA. 90° -270°
6.0 ft	54.8 fc	12.5 ft	12.7 ft
8.0 ft	30.8 fc	16.6 ft	16.9 ft
10.0 ft	19.7 fc	20.8 ft	21.2 ft
12.0 ft	13.7 fc	24.9 ft	25.4 ft
14.0 ft	10.1 fc	29.1 ft	29.6 ft
16.0 ft	7.7 fc	33.2 ft	33.9 ft
18.0 ft	6.1 fc	37.4 ft	38.1 ft
20.0 ft	4.9 fc	41.5 ft	42.4 ft

INDOOR COEFFICIENTS OF UTILIZATION

ρ _c	20%																0%		
	80%				70%				50%				30%					10%	
ρ _w	70%	50%	30%	10%	70%	50%	30%	10%	50%	30%	10%	50%	30%	10%	50%	30%	10%	0%	
0	119	119	119	119	116	116	116	116	111	111	111	106	106	106	102	102	102	100	
1	111	107	104	101	109	105	102	99	101	98	96	97	95	93	94	92	90	89	
2	103	96	90	86	100	94	89	85	91	87	83	88	84	81	85	82	79	77	
3	95	86	79	74	93	85	78	73	82	76	72	79	75	71	77	73	69	68	
4	88	78	70	64	86	76	69	64	74	68	63	72	66	62	70	65	61	59	
5	82	70	62	56	80	69	62	56	67	61	56	65	59	55	63	58	54	53	
6	76	64	56	50	74	63	55	50	61	54	49	60	54	49	58	53	49	47	
7	71	58	50	45	69	58	50	45	56	49	44	55	49	44	53	48	44	42	
8	66	54	46	40	64	53	45	40	52	45	40	50	44	40	49	44	40	38	
9	62	49	42	37	60	49	42	37	48	41	36	47	41	36	46	40	36	34	
10	58	46	38	34	57	45	38	33	44	38	33	43	37	33	43	37	33	31	

FS-RL1044-3000L-3500L-4000L-DIM10-MVOLT-27K-30K-35K-40K-50K(4000L)

TEST NO.: **EL08142422**

INPUT WATTS: **33.8**

LUMENS: **4340**

EFFICACY: **128**

BEAM ANGLE: **93**

SPACING CRITERIA: **1.14**

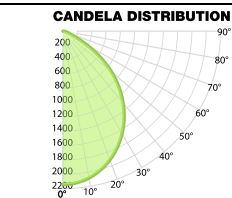

CANDELA TABLE		
	0°	90°
0°	2143	2143
10°	2084	2091
20°	1914	1937
30°	1650	1690
40°	1304	1360
50°	883	958
60°	380	467
70°	99	120
80°	33	41
90°	0	0

LUMINANCE (cd/sq.m)		
	0.00°	90.00°
0.00°	45892	45892
45.00°	33425	35351
55.00°	23743	27074
65.00°	9283	12167
75.00°	4749	5720
85.00°	2690	4398

LUMENS PER ZONE	
ZONE	LUMENS
0° - 10°	214
10° - 20°	565
20° - 30°	825
30° - 40°	935
40° - 50°	866
50° - 60°	602
60° - 70°	239
70° - 80°	74
80° - 90°	19

ZONAL LUMEN SUMMARY		
ZONE	LUMENS	% LUMINAIRE
0° - 20°	779	18%
0° - 30°	1604	37%
0° - 40°	2539	59%
0° - 60°	4008	92%
0° - 80°	4320	100%
0° - 90°	4339	100%

CONE OF LIGHT

MOUNTING HEIGHT	FC AT BEAM CENTER	BEAM DIA. 0° -180°	BEAM DIA. 90° -270°
6.0 ft	59.5 fc	12.6 ft	12.6 ft
8.0 ft	33.5 fc	16.8 ft	16.8 ft
10.0 ft	21.4 fc	21.0 ft	21.0 ft
12.0 ft	14.9 fc	25.2 ft	25.2 ft
14.0 ft	10.9 fc	29.5 ft	29.4 ft
16.0 ft	8.4 fc	33.7 ft	33.6 ft
18.0 ft	6.6 fc	37.9 ft	37.8 ft
20.0 ft	5.4 fc	42.1 ft	42.0 ft

INDOOR COEFFICIENTS OF UTILIZATION

pc pw	20%																		0%
	70%	50%	30%	10%	70%	50%	30%	10%	50%	30%	10%	50%	30%	10%	50%	30%	10%	0%	
0	119	119	119	119	116	116	116	116	111	111	111	106	106	106	102	102	102	100	89
1	111	107	104	101	109	105	102	99	101	98	96	97	95	93	94	92	90	89	80
2	103	96	90	86	100	94	89	85	91	87	83	88	84	81	85	82	79	77	68
3	95	86	79	74	93	85	78	73	82	76	72	79	75	71	77	73	70	68	59
4	88	78	70	64	86	76	69	64	74	68	63	72	66	62	70	65	61	59	53
5	82	70	62	56	80	69	62	56	67	61	56	65	60	55	63	58	54	53	47
6	76	64	56	50	74	63	55	50	61	55	49	60	54	49	58	53	49	47	42
7	71	58	50	45	69	58	50	45	56	49	44	55	49	44	53	48	44	42	38
8	66	54	46	40	65	53	46	40	52	45	40	50	44	40	49	44	40	38	34
9	62	49	42	37	61	49	42	37	48	41	36	47	41	36	46	40	36	34	31
10	58	46	38	34	57	45	38	33	44	38	33	43	37	33	43	37	33	31	28