

DIMENSIONS

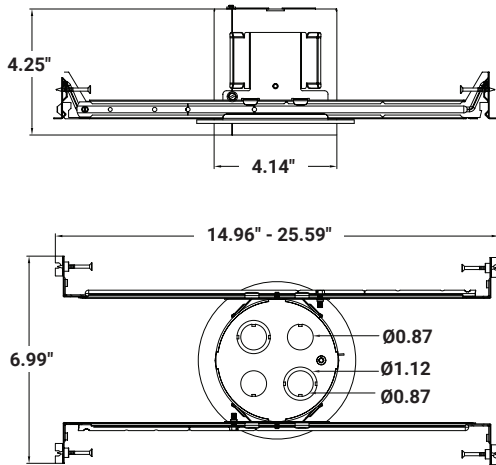

2-HOUR FIRE RATING

- Conforms to UL1598, IC ratings for recessed luminaire housings
- Conforms to Metallic Outlet Box, fire rated up to 2 hours
- Suitable for Damp Location
- ASTM E283 Air Tight Certified
- Solution for suspended lights with external drivers
- Painted steel junction box construction
- Fits most surface mount fixtures and retrofit fixtures

SERIES	MAX CURRENT (A)	MAX WATTAGE (W)	WEIGHT (LB)
FS-JBOX	0.18	10	1.72

ORDERING GUIDE

PART NUMBER

FS-IC-JBOX-ADJ

NOTE: Refer to page 2 for all compatible Elite Lighting Luminaires.

FEATURES

This 4" fire-rated junction box helps bolster fire-safety compliance in low plenum spaces with a can that adjusts to accommodate different ceiling thicknesses. Compatible with existing Elite downlights, adjustable LED trims, and both surface and recessed mount installations. Included quick connector enables use with round retrofit downlights.

Ideal for quick, easy new construction drywall and joist installation, as well as T-bar grid and suspended ceiling applications. IC rated, airtight, and ready for contact with insulation. Damp location suitable.

Heat-resistant steel construction maintains a maximum 2-hour fire-rating to deter fire-spread, when installed according to the International Building Code, Section 714.

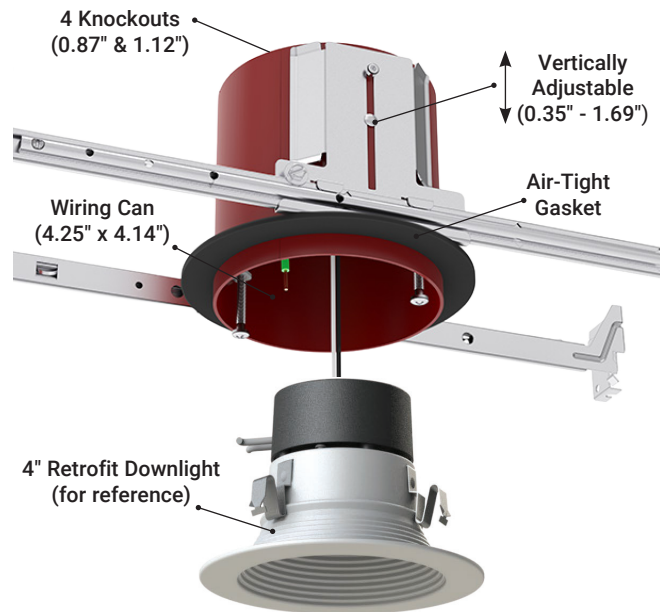

NOTE: Metallic outlet boxes with metallic or nonmetallic cover plates may be used in floor-ceiling and roof-ceiling assemblies with ratings not exceeding 2 hours. These assemblies should have gypsum board membranes. The metallic outlet boxes should be securely fastened to the joists and the opening in the gypsum board facing should be cut so that the clearance between the box and the gypsum board does not exceed 1/8 in. The surface area of individual boxes should not exceed 16 sq. in. The aggregate surface area of the boxes should not exceed 100 sq. in. per 100 sq. ft of ceiling surface.

FS-IC-JBOX-ADJ COMPATIBLE ELITE LIGHTING LED RETROFIT

EASY 5 COLORS
SELECCTOR
(2700K • 3000K • 3500K • 4000K • 5000K)

BAFFLE

WET
LOCATION

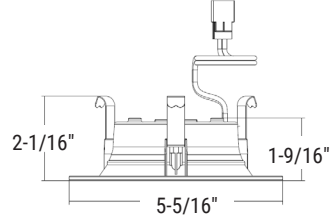
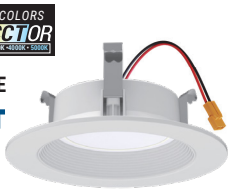

TYPE	LUMEN/DIM/VOLT.	CCT	CRI	FINISH
REL434	700L-DIMTR-120	27K/30K/35K/40K/50K	90+	W-WH - White

EASY 5 COLORS
SELECCTOR
(2700K • 3000K • 3500K • 4000K • 5000K)

BAFFLE

WET
LOCATION

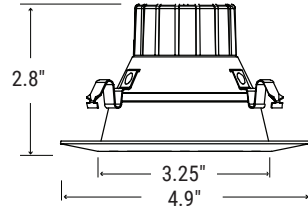

TYPE	LUMEN/DIM/VOLT.	CCT	CRI	FINISH
REL437	700L-DIMTR-120 1100L-DIMTR-120	27K/30K/35K/40K/50K	90+	W-WH - White P-BK - Black

EASY 5 COLORS
SELECCTOR
(2700K • 3000K • 3500K • 4000K • 5000K)

WET
LOCATION

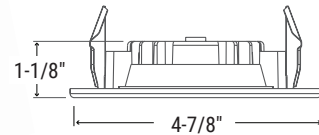

TYPE	LUMEN/DIM/VOLT.	CCT	CRI	FINISH
RL412	550L-DIMTR-120	27K/30K/35K/40K/50K	90+	BK - Black BN - Brushed Nickel CL - Chrome CP - Copper SI - Silver WH - White

EASY 5 COLORS
SELECCTOR
(2700K • 3000K • 3500K • 4000K • 5000K)

REFLECTOR

WET
LOCATION

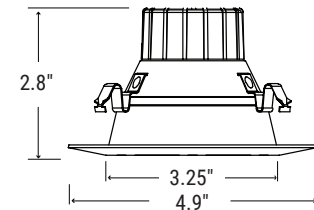

TYPE	LUMEN/DIM/VOLT.	CCT	CRI	FINISH
RL428	700L-DIMTR-120 950L-DIMTR-120	27K/30K/35K/40K/50K	90+	W-WH - White

EASY 5 COLORS
SELECCTOR
(2700K • 3000K • 3500K • 4000K • 5000K)

BAFFLE

WET
LOCATION

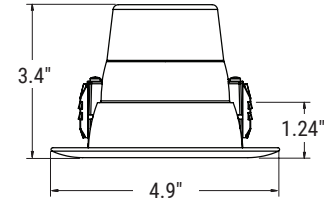

TYPE	LUMEN/DIM/VOLT.	CCT	CRI	FINISH
RL431	700L-DIMTR-120 950L-DIMTR-120	27K/30K/35K/40K/50K	90+	W-WH - White

FS-IC-JBOX-ADJ COMPATIBLE ELITE LIGHTING LED RETROFIT

NON-CONDUCTIVE

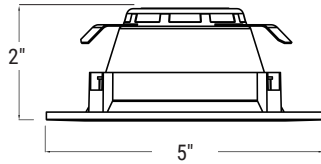

TYPE	LUMEN/DIM/VOLT.	CCT	CRI	FINISH
RL432	700L-DIMTR-120	27K 30K 35K 40K	90+	W-WH - White

ADJUSTABLE

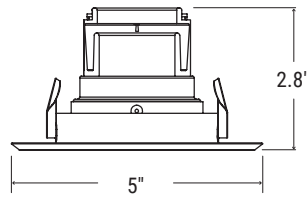

TYPE	LUMEN/DIM/VOLT.	CCT	CRI	FINISH
RL461	650L-DIMTR-120	27K 30K 40K	90+	BK-BK - Black BZ-BZ - Bronze SN-SN - Satin Nickel W-WH - White

ADJUSTABLE

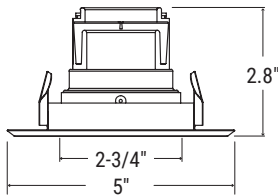

TYPE	LUMEN/DIM/VOLT.	CCT	CRI	FINISH
RL481	650L-DIMTR-120	27K 30K 40K	90+	BK-BK - Black BZ-BZ - Bronze SN-SN - Satin Nickel W-WH - White

ADJUSTABLE

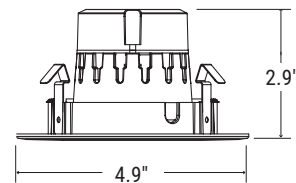

TYPE	LUMEN/DIM/VOLT.	CCT	BEAM ANGLE	CRI	FINISH
RL465	650L-DIMTR-120	27K 30K 40K	NS - 24° / Narrow MD - 38° / Medium FL - 60° / Flood	90+	BK-BK - Black BZ-BZ - Bronze SN-SN - Satin Nickel W-WH - White

FS-IC-JBOX-ADJ COMPATIBLE ELITE LIGHTING SURFACE MOUNT LUMINAIRES

EASY 3 COLORS
SELECCTOR

3000K • 4000K • 5000K

DAMP
LOCATION

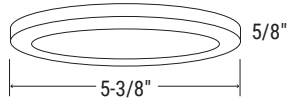

TYPE	LUMEN/DIM/VOLT.	CCT	CRI	FINISH
RL591	600L-DIMTR-120	30K/40K/50K	90+	BK - Black BZ - Bronze SN - Satin Nickel WH - White

EASY 3 COLORS
SELECCTOR

3000K • 4000K • 5000K

DAMP
LOCATION

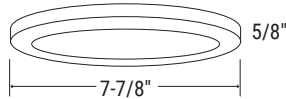

TYPE	LUMEN/DIM/VOLT.	CCT	CRI	FINISH
RL791	900L-DIMTR-120	30K/40K/50K	90+	BK - Black BZ - Bronze SN - Satin Nickel WH - White

EASY 5 COLORS
SELECCTOR

2700K • 3000K • 3500K • 4000K • 5000K

**MULTILUMEN
SELECTOR**

DAMP
LOCATION



TYPE	LUMEN/DIM/VOLT.	CCT	CRI	FINISH
RL595	600L/700L-DIMTR-120	27K/30K/35K/40K/50K	90+	BK - Black BZ - Bronze SN - Satin Nickel WH - White

EASY 3 COLORS
SELECCTOR

3000K • 4000K • 5000K

DAMP
LOCATION

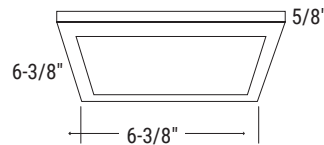

TYPE	LUMEN/DIM/VOLT.	CCT	CRI	FINISH
RL795	900L-DIMTR-120	30K/40K/50K	90+	BK - Black BZ - Bronze SN - Satin Nickel WH - White

EASY 3 COLORS
SELECCTOR

3000K • 4000K • 5000K

DAMP
LOCATION

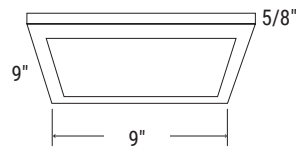

TYPE	LUMEN/DIM/VOLT.	CCT	CRI	FINISH
RL995	1200L-DIMTR-120	30K/40K/50K	90+	BK - Black BZ - Bronze SN - Satin Nickel WH - White

EASY 3 COLORS
SELECCTOR

3000K • 4000K • 5000K

DAMP
LOCATION



EMERGENCY

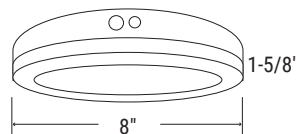

TYPE	LUMEN/DIM/VOLT.	CCT	CRI	FINISH
RL790	900L-DIMTR-120	30K/40K/50K	90+	BK - Black BZ - Bronze SN - Satin Nickel WH - White