

EASY 3 COLORS
SELECTOR
3000K • 3500K • 4000K

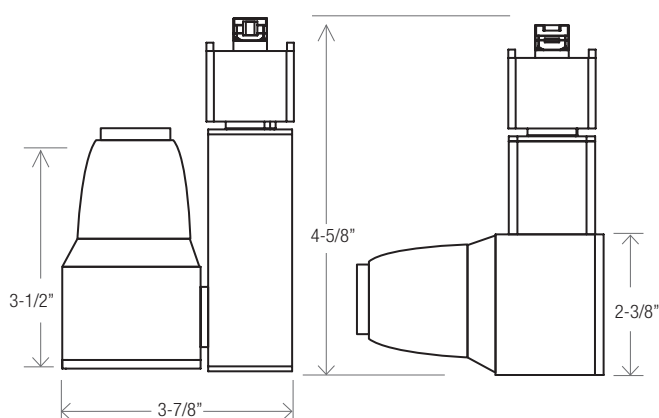

OPTICS

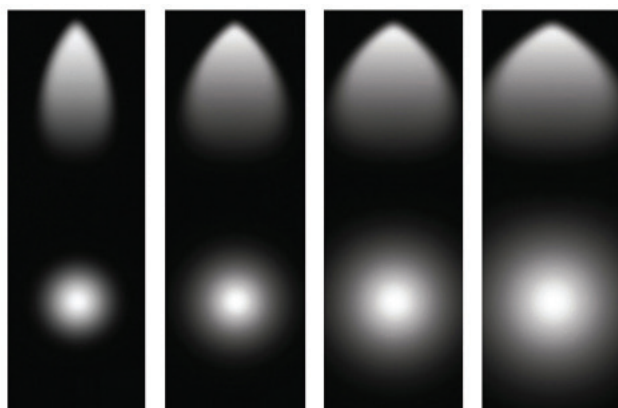

SP	NFL	FL	WFL
Spot 15°	Narrow Flood 24°, 25°	Flood 36°, 38°	Wide Flood 60°

NOMINAL LUMENS	DELIVERED LUMENS	WATTAGE
700	866	11W

Based on 3000K, 90+ CRI. Actual wattage may vary +/- 5%

FEATURES

A small profile LED track light that delivers optimal lumen output, with precise aiming for accent, task, or general illumination, integrating into any design. Track heads are adjustable up to 360 degrees horizontally, 180 degrees vertically, and are compatible with 1-circuit and 2-circuit track. With the use of a friction-based locking movement system, the head can be adjusted and re-adjusted to a precise position, delivering light where needed. Available in an array of color temperatures, it can accentuate the full spectrum of cool to warm tones, and is the perfect complement for retail merchandising, galleries, museums, supermarkets, hospitality, and commercial.

LUMENS	700
CCT	30K/35K/40K
CRI	90+
COLOR QUALITY	2 Step MacAdam Ellipse
DISTRIBUTION	SP (Spot), NFL (Narrow Flood), FL (Flood), WFL (Wide Flood)
AIMING	360 degrees horizontally, 180 degrees vertically
FINISH	AWH (Architectural White) ABK (Architectural Black) Custom RAL
DIMMING	Flicker Free 10% Dimming TRIAC forward-phase or leading-edge 120V.
LIFETIME	L70 at 50,000 Hours
PHOTOMETRIC TESTS	In Accordance with IES LM79-08, LM80 and TM-30, TM-21



OPTICS

A polycarbonate optical refractor allows for precise beam control and even distribution, with a variety of lumen options.

CONSTRUCTION

All track heads are designed using a proprietary coolLED Advanced Thermodynamic Design. The track head body is constructed of extruded aluminum, with a die-cast custom designed concealed heat sink, providing a thermal management system that is engineered for extremely long life and service period.

FINISH

Post-painted available in white, black and custom RAL colors.

ACCESSORIES

Track heads may accommodate 1 to 3 accessories. Please consult factory for standard or custom options.

TRACK COMPATIBILITY

Track heads are standard, with the compatibility for use with Mono-point, 1-Circuit, and 2-Circuit type H track. Please consult factory for 2-Circuit, 2-Neutral 120V Track, 2-Circuit, 2-Neutral 277V Track, 3-Circuit 1-Neutral, and Dali System Track.

DIMMING AND DRIVER INFORMATION

DIMTR – Electronic constant current LED driver compatible with TRIAC forward-phase or leading-edge dimming. Available in 120V. Dimmable down to 1%, standard. The LED driver is rated for 50 to 60Hz at 120V input, produces less than 20%THD, and has a power factor between 90% and 100%, and is thermally protected for additional safety.

WARRANTY

Five-year warranty for parts and components. (Labor not included)

Example: **ET-LED-346-700L-DIMTR-120-30K/35K/40K-90-FL-AWH**

SERIES	LUMENS	DIMMING	CCT/CRI	OPTICS	COLOR
ET-LED-346	<input checked="" type="checkbox"/> 700L - 866 lumens	<input checked="" type="checkbox"/> DIMTR-120	<input checked="" type="checkbox"/> 30K/35K/40K-90	<input checked="" type="checkbox"/> SP - Spot 15° <input type="checkbox"/> NFL - Narrow Flood 24°-25° <input type="checkbox"/> FL - Flood 36°-38° <input type="checkbox"/> WFL - Wide Flood 60°	<input checked="" type="checkbox"/> AWH - Architectural White <input type="checkbox"/> ABK - Architectural Black

ET-LED-346-700L-DIMTR-120-30K-35K-40K-90-FL-AWH

TEST NO.: **EL05082054**

INPUT WATTS: **11.7** LUMENS: **866** CRI: **90** EFFICACY: **74** CCT: **4000K** SPACING CRITERIA: **0.48**

Candle Power Distribution (Candelas)

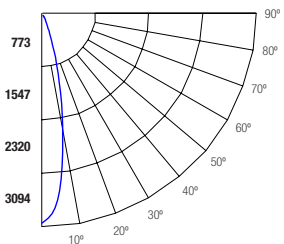

Zonal Lumens Summary

Zone	Lumens	%Lamp	%Fixt
0-20	611.9	70.6	70.6
0-30	772.33	89.1	89.1
0-40	835.79	96.5	96.5
0-60	862.52	99.5	99.5
0-80	865.61	99.9	99.9
0-90	865.63	99.9	99.9

Luminance (Average candela/M²)

Angle in Degrees	Average 0°	Average 45°	Average 90°
45	10374	10573	14523
55	3724	4739	5675
65	2009	2883	3159
75	26	119	516
85	79	79	79

Lumens Per Zone

Zone	Lumens
0-10	248.1
10-20	363.81
20-30	160.43
30-40	63.46
40-50	19.71
50-60	7.02
60-70	2.69
70-80	0.4
80-90	0.02

Candela Tabulation

0	
0	2960.73
5	2804.01
15	1302.05
25	311.59
35	77.16
45	21.43
55	6.24
65	2.48
75	0.02
85	0.02
90	0.02

Coefficients of Utilization - Zonal Cavity Method

Effective Floor Cavity Reflectance 0.20

ROOM CAVITY RATIO	80%					70%				50%			30%			10%			0%
	70%	50%	30%	10%		70%	50%	30%	10%	50%	30%	10%	50%	30%	10%	50%	30%	10%	0%
	RC	RW																	
0	119	119	119	119	116	116	116	116	111	111	111	106	106	106	102	102	102	100	
1	115	112	110	108	112	110	108	107	106	105	103	102	101	100	99	98	97	96	
2	110	106	103	100	108	105	102	99	102	99	97	99	97	95	96	94	93	92	
3	106	101	97	94	104	100	96	93	97	94	92	95	93	91	93	91	89	88	
4	103	97	92	89	101	96	92	88	94	90	87	92	89	86	90	87	85	84	
5	99	92	88	85	98	92	87	84	90	86	83	88	85	83	87	84	82	81	
6	96	89	84	81	94	88	84	81	87	83	80	85	82	80	84	81	79	78	
7	92	85	81	77	91	85	80	77	84	80	77	83	79	77	81	78	76	75	
8	90	82	78	74	89	82	77	74	81	77	74	80	76	74	79	76	73	72	
9	87	79	75	72	86	79	75	72	78	74	71	77	74	71	77	73	71	70	
10	84	77	72	69	83	76	72	69	76	72	69	75	71	69	74	71	69	68	

RC - Ceiling Cavity Reflectance