

# ELM-LED-822

## LED NEMA4X/NSF EMERGENCY UNIT

Catalog Number:

Project Name:

Note:

Type:

Unit



See **ELM-LED-865** for Remote Head options.

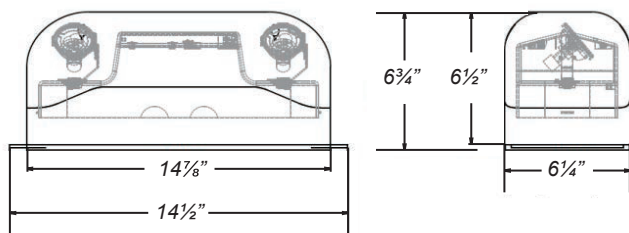

### HOUSING

- Housing is reinforced polycarbonate construction in white, gray or black finish.
- Corrosion-resistant enclosure with one piece, high-impact resistant, UV stabilized polycarbonate lens and molded gasket with stainless steel screws.
- Knockout's provided for conduit feed applications.

### WARRANTY / LISTING

- Five year warranty on all electronics and housing. Batteries prorated for two (lead acid) / five (NiCd) years.
- Meets UL924, NFPA101 Life Safety Code, NEC, OSHA, Local and State Codes.
- IP66 rated for Ingress protection.
- NEMA4X rated.
- UL certified for use in food service operations.
- UL listed for wet locations (0°C – 50°C on 15W and 10°C - 40°C on 36W / 54W models).

**ELM-LED-822 - ITEM SELECTOR:** (Please check the boxes below for the option desired)

HOUSING COLOR	BATTERY VOLTAGE	WATTAGE	OPTIONS
<b>W</b> - White	<b>6</b> - 6 volts	<b>15</b> - 15 watts	<b>SDT</b> - Self-Diagnostics
<b>B</b> - Black	<b>12</b> - 12 volts	<b>36</b> - 36 watts	<b>CW</b> - Cold Weather <sup>1</sup>
<b>G</b> - Gray		<b>54</b> - 54 watts	<b>TP</b> - Tamper-Proof

<sup>1</sup> Available only in 15W models.

### OPTIONS

- SDT:** Self-diagnostic feature performs monthly, biannual, and annual tests to ensure reliable operation and meets electrical and life safety codes.
- CW:** Optional internal heater and battery blanket for extreme cold temperature applications (-20°C – 50°C).
- TP:** Tamper-proof hardware helps discourage unauthorized access to the unit.

### ELECTRICAL

- Dual 120/277 voltage.
- Unique bi-color LED indicator light alerts occupant on battery condition (Green-normal, Red-check-battery).
- Charge rate/power "ON" LED indicator light and magnetic test switch for mandated code compliance testing.
- 6V/12V maintenance-free, rechargeable NiCd battery (15W models).
- 6V/12V maintenance-free, rechargeable sealed lead acid battery (36W & 54W models).
- Offers 7.8W, 28.8W, 46.8W of remote capacity (6V/12V DC output) standard on the 15W, 36W AND 54W models.
- Internal solid-state transfer switch automatically connects the internal battery to LED lamp heads for minimum 90-minute emergency illumination.
- Fully automatic solid-state, two-rate charger initiates battery charging to recharge a discharged battery in 24 hours (36 hours on the 54W model).

### MOUNTING

- Universal knockout pattern on back provided with gasket for watertight seal for back mount.
- Suitable for all mount.

### ILLUMINATION

- Two fully adjustable, ultra bright 3.3 watt high performance MR-16 base LED lamp heads for optimized center-to-center spacing.

SPECIFIED:  
**ELM-LED-822**

HOUSING COLOR

VOLTAGE

WATTAGE

OPTION

STANDARD



OPTIONAL

