

B36PLIC-E

6" Compact Fluorescent Slope IC Housing

LAMP WATTAGE: UP TO 26W

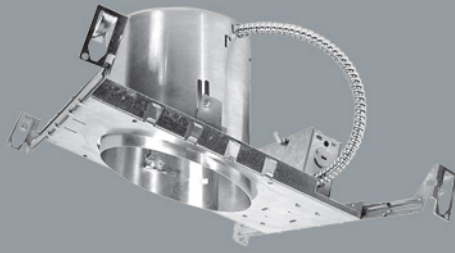

2/12 TO 6/12 PITCH (9° TO 27°)

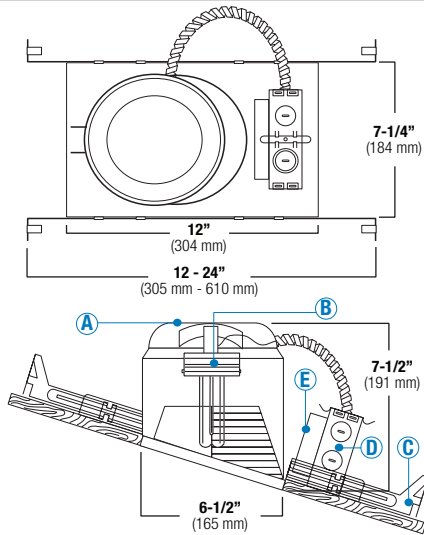

Catalog Number:

Project Name:

Type:

Note:



DESCRIPTION

Thermally protected, specification grade compact fluorescent IC housing. For new construction where housing will be in direct contact with insulation. Designed for sloped ceiling applications where the ceiling pitch ranges from 2/12 to 6/12. Accommodates (1) 13W, 18W or 26W compact fluorescent lamp. Furnished with preinstalled adjustable bar hangers. Junction box is provided with four 1/2" KOs, one 3/4" KO and four Romex knockouts with strain relief.

SPECIFICATION

A. HOUSING - Die-formed all aluminum construction for maximum heat dissipation and rust protection. Adjusts vertically in plaster frame to accommodate 1/2" to 1-3/8" ceilings.

B. SOCKET - One vertically mounted plug-in socket. Unitized optics guarantees proper trim to housing installation. Tool-less installation adjusts from inside the housing.

C. BAR HANGERS - Preinstalled bar hangers allow housing to be positioned and locked at any point within a 24" joist span and can be shortened for 12" joists. Integral bar hanger nailers are designed to be hammered directly into the joist without additional nails or screws and makes installation fast and accurate. Bar hangers can fit onto T-Bar spline with additional slots and holes for special mounting methods if necessary.

D. JUNCTION BOX - Listed for through-branch circuit wiring and has four 1/2" KOs, one 3/4" KO and four Romex knockouts with true pry-out slots and strain clamps.

E. BALLAST - Thermally protected, current controlled ballast, will produce full light output, increase lamp life with no noise and flicker. Ballast supplied is manufactured by Advance.

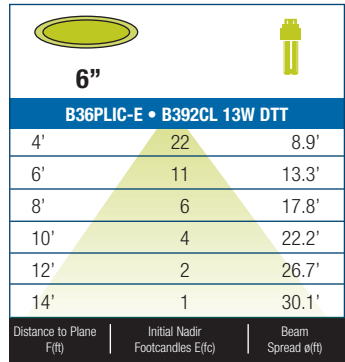

BEAM DIA. MEASURED AT 50% OF NADIR F.C.

FEATURES

- Thermally Protected compact fluorescent IC housing.
- Integral fluorescent ballast.
- Adjustable socket bracket with a slope indicator provides consistent lamp alignment and setup.
- Wire through junction box.
- Preinstalled adjustable bar hanger.
- Dependable, favorable design and effortless installation.
- 7-1/4" height allows use in 2" x 8" joist construction.
- Special screw on the frame locks bar hangers in place which prevents the housing from any movement once installed.

OPTIONS

AIR-SHUT

- Gasket to prevent air flow from heated or air conditioned spaces.
- Meets all national air flow requirements.



B36PLIC-E - ITEM SELECTOR: (Please check the boxes below for the option desired)

WATTAGE	BALLAST	VOLTAGE	EMERGENCY OPTIONS	TRIM TYPE	BAFFLE	REFLECTOR	TRIM/RING
<input type="checkbox"/> 13W	<input type="checkbox"/> (E) Electronic	<input type="checkbox"/> 120	<input type="checkbox"/> EMG 750 (750 Lumens) ⁶	<input type="checkbox"/> B391	<input type="checkbox"/> W	<input type="checkbox"/> CL	<input type="checkbox"/> WH
<input type="checkbox"/> 18W	<input type="checkbox"/> (E-AD) Electronic ¹	<input type="checkbox"/> 277	<input type="checkbox"/> EMG 1300 (1300 Lumens) ⁶	<input type="checkbox"/> B397	<input type="checkbox"/> P	<input type="checkbox"/> RG	<input type="checkbox"/> BK
<input type="checkbox"/> 26W	<input type="checkbox"/> (S) Energy Star ²		<input type="checkbox"/> EMG-D-750 (750 Lumens) ⁷	<input type="checkbox"/> B601	<input type="checkbox"/> SN	<input type="checkbox"/> W	<input type="checkbox"/> SN
			<input type="checkbox"/> ICE-1300 (1300 Lumens) ⁸	<input type="checkbox"/> B601L	<input type="checkbox"/> CP	<input type="checkbox"/> MB	<input type="checkbox"/> CP
				<input type="checkbox"/> B605	<input type="checkbox"/> BZ	<input type="checkbox"/> BZ	<input type="checkbox"/> CH
				<input type="checkbox"/> B605L		<input type="checkbox"/> CP	<input type="checkbox"/> PB
						<input type="checkbox"/> SN	<input type="checkbox"/> BZ
						<input type="checkbox"/> SHZ	
	DIMMING	AIR-SHUT	OTHER OPTIONS				
	<input type="checkbox"/> Mark 7 ³	<input type="checkbox"/> AT	<input type="checkbox"/> FUSE ⁹				
	<input type="checkbox"/> Mark 10 ⁴		<input type="checkbox"/> RIF ¹⁰				
	<input type="checkbox"/> Lut-E (EC3D) ⁵						
	<input type="checkbox"/> REB-DIM-120						

(Note: CA Title 24 approved only if ordered with electronic ballast and Air-Shut.) 1- (E-AD) Advance Electronic Ballast • 2- (S) Energy Star = Available on selected fixtures only, please see list above • 3- MARK 7 = Not available in 9W, 13W, 57W, 70W • 4- MARK 10 = Not available in 9W, 13W, 57W, 70W, must specify voltage • 5- LUT-E (EC3D) = Not available in 9W, 13W, 57W, 70W • 6- EMG = Emergency battery pack w/ remote test switch • 7- EMG-D = Emergency battery pack w/ remote test switch for damp location • 8- ICE = Emergency battery pack w/ remote test switch operating between -18°C and 55°C • 9- FUSE = Single slow-blow fuse • 10- RIF = Radio interference filter

Specifications:

B36PLIC-E

WATT	BALLAST	VOLTAGE	AIR-SHUT	EMERGENCY	OPTIONS	TRIM TYPE	REFLECTOR	BAFFLE	RING
------	---------	---------	----------	-----------	---------	-----------	-----------	--------	------

BAFFLE	REFLECTOR	TRIM/RING
W White	CL Chrome	WH White
P Black	RG Gold	BK Black
SN Satin Nickel	W White	SN Satin Nickel
CP Copper	MB Black	CP Copper
BZ Bronze	BZ Bronze	CH Chrome
	CP Copper	PB Polish Brass
	SN Satin Nickel	BZ Bronze
	SHZ Satin Haze	

Sample of Catalog Number: B36PLIC-26W-E-MVOLT-EMG750-B391W-WH

*For custom baffle, reflector, trim ring, glass color and lens options, please consult factory.



Submittal form is available @ www.iuseelite.com
Tel: 323-888-1973 • Fax: 323-888-1977

Specifications and Dimensions subject to change without notice.

REV: ELITE LIGHTING-SPEC-06-29-2011

6" Slope Ceiling CFL Trims

(LAMP WATTAGE: UP TO 26W)

Catalog Number:

Project Name:

Type:

Note:



**B391CP-CP
STEPPED BAFFLE**



BAFFLE FINISH:
W, P, SN, CP, BZ

TRIM/RING FINISH:
WH, BK, SN, CP, CH,
PB, BZ

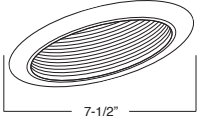

**B397RG-WH
REFLECTOR**



REFLECTOR FINISH:
CL, RG, W, MB, CP, SN,
BZ, SHZ

TRIM/RING FINISH:
WH, BK, SN, CP, CH,
PB, BZ

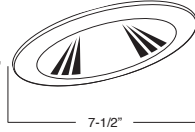

**B601CP
METAL ALBALITE LENS**



FOR
WET
LOCATION

LENS:
ALBALITE

TRIM/RING FINISH:
WH, BK, SN, CP, CH,
PB, BZ

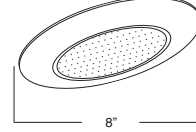

**B601L
PLASTIC ALBALITE LENS**



FOR
WET
LOCATION

LENS:
ALBALITE

TRIM/RING FINISH:
WHITE PLASTIC

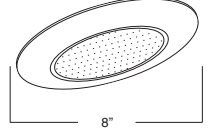

**B605PB
METAL FRESNEL LENS**

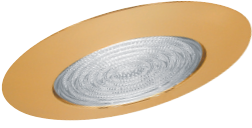

FOR
WET
LOCATION

LENS:
FRESNEL

TRIM/RING FINISH:
WH, BK, SN, CP, CH,
PB, BZ

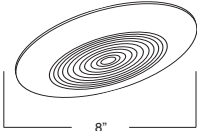

**B605L
PLASTIC FRESNEL LENS**



FOR
WET
LOCATION

LENS:
FRESNEL

TRIM/RING FINISH:
WHITE PLASTIC

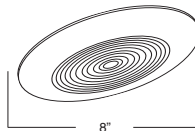

BAFFLE		REFLECTOR		TRIM RING	
W	White	CL	Chrome	WH	White
P	Black	RG	Gold	BK	Black
SN	Satin Nickel	W	White	SN	Satin Nickel
CP	Copper	MB	Black	CP	Copper
BZ	Bronze	CP	Copper	CH	Chrome
		SN	Satin Nickel	PB	Polish Brass
				BZ	Bronze

*For custom baffle, reflector, trim ring, glass color and lens options, please consult factory.