

T8 FLUORESCENT INDUSTRIAL STRIP
(1, 2 OR 4 LAMP)

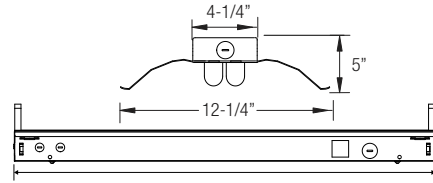

LENGTH
4' = 48"
8' = 96"

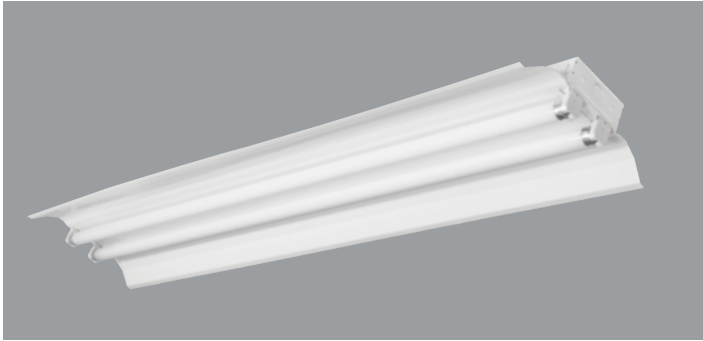

PRODUCT FEATURES:

- Heavy-duty 20-gauge steel utilized throughout for durability and code compliance
- Powder-coated painted for maximum operating life
- Pretreated with five-stage iron phosphate process to ensure superior paint adhesion
- Painted high-gloss baked white enamel
- Suitable for dry and damp environments
- Thermally protected, self-resetting, Class P, NPF, non-PCB and UL listed ballast
- Suitable for surface and/or suspended mounting
- Individual or continuous row mounting
- Standard reflector is manufactured in aluminum with high reflectance white finish
- Reflector is secured to housing with 1/4 turn fasteners (ships separately)
- NEC required ballast disconnect is standard
- CEE qualified ballast comes standard on most fixture options (Consult factory for details)

LISTING

UL/C-UL listed to US and Canadian standard

WARRANTY

Guaranteed for one year against mechanical defects

T8
OIC

Ordering Information > Example: 8-OIC-2-32-T8-MVOLT-EMG-T8-BX-700

8	OIC								
----------	------------	--	--	--	--	--	--	--	--

FIXTURE SIZE	SERIES	WATTAGE	VOLTAGE ¹	# OF BALLAST	BALLAST FACTOR
8- 8'	OIC Oracle Industrial Series	8' FIXTURE 1-59-T8 (1 lamp/59W/T8) 2-59-T8 (2 lamps/59W/T8) 8' TANDEM FIXTURE 2-32-T8 (2 lamps/32W/T8) 4-32-T8 (4-lamps/32W/T8)	(Blank) - MVOLT (120/277) 120 277 347	(Blank) - 1 Ballast 2- 2 Ballasts	(Blank) - Normal BF HBF - High BF LBF - Low BF

BALLAST CONFIGURATION & CODE		
32W/T8	59W/T8	DESCRIPTION
(Blank)	(Blank)	Electronic Instant Start
EPS	-	Electronic Program Start
ADV-7	-	Advance Mark-7 ²
ADV-10 ¹	-	Advance Mark-10 ²
-	-	Advance Optanium ²
ADV-ESS ¹	-	Advance Essential ²
ADV-ROVR	-	Advance Rover ²
LUT-EHD ¹	-	Lutron Ecosystem H-Series ²
LUT-2W ¹	-	Lutron Tu-Wire ²
LUT-EC5 ¹	-	Lutron Ecosystem ²
LUT-EC3 ¹	-	Lutron Eco-10 ²
LUT-TVE ¹	-	Lutron Tve ²
LUT-H3D ¹	-	Lutron Hi-Lume 3D ²
-	-	Lutron Ecosystem (347V Only) ²

1- Requires 2 Ballasts.
2- Voltage must be specified for dimming ballast.

REMOTE EMERGENCY BATTERY PACK OPTIONS (L. = LUMENS)	
ORDER CODE	DESCRIPTION
EMG-T8-BX-450	Up to 450 L. for T8 or BX
EMG-T8-BX-600	Up to 600 L. for T8 or BX
EMG-T8-BX-700	Up to 700 L. for T8 or BX
EMG-T8-BX-1400	Up to 1400 L. for T8 or BX
EMG-T8-BX-T5-T5HO-3200	Up to 3200 L. for T8, BX, T5 or T5HO
EMG-SD-T8-BX-T5-T5HO-1400	Self-Diagnostic 1400 L. for T8, BX, T5 or T5HO
EMG-ICE-T8-BX-T5-T5HO-1400	ICE Pack 1400 L. for T8, BX, T5 or T5HO
GTD	Generator Transfer Device

WIRING OPTIONS		OTHER OPTIONS	
C3	- 6' 3-wire Flex Cable (Single Circuit)	OICWG2	- Wireguard
C4	- 6' 4-wire Flex Cable (Double Circuit)	OCMS	- Motion Sensor
FBF	- Internal Fast Blow Fuse	OCVH	- V Hook and Chain Kit
SBF	- Internal Slow-Blow Fuse	OCGSS	- Cable Gripper Suspension Kit
RIS	- Radio Interference Suppressor	USA	- Made in America Compliance

8' Fluorescent Industrial Strip