

T8 FLUORESCENT INDUSTRIAL STRIP W/ REFLECTOR (1 OR 2 LAMP)

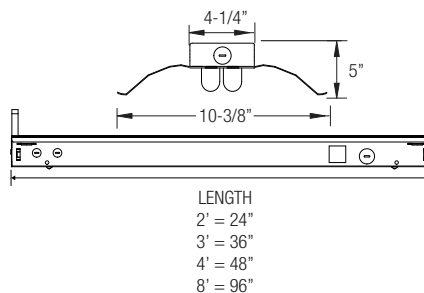

PRODUCT FEATURES:

- Heavy-duty 20-gauge steel utilized throughout for durability and code compliance
- Powder-coated painted for maximum operating life
- Pretreated with five-stage iron phosphate process to ensure superior paint adhesion
- Painted high-gloss baked white enamel
- Suitable for dry and damp environments
- Thermally protected, self-resetting, Class P, NPF, non-PCB and UL listed ballast
- Suitable for surface and/or suspended mounting
- Individual or continuous row mounting
- Standard reflector is manufactured in high reflectance white
- Reflector is secured to housing with 1/4 turn fasteners (ships separately)
- Reflector options:
 - Aluminium high reflectance white paint/slotted (20% uplight)
 - Aluminium specular silver/slotted (20% uplight)
 - Aluminium white asymmetrical reflector
 - Aluminium specular silver/asymmetrical reflector

- NEC required ballast disconnect is standard
- CEE qualified ballast comes standard on most fixture options (Consult factory for details)

LISTING

UL/C-UL listed to US and Canadian standard

WARRANTY

Guaranteed for one year against mechanical defects

NOTE: All Aluminium Reflectors are special order (check with factory)

Ordering Information > Example: 3-OCR-2-25-T8-MVOLT-EMG-T8-BX-700

3	OCR								
FIXTURE SIZE	SERIES	WATTAGE	VOLTAGE ²	# OF BALLAST	BALLAST FACTOR	REFLECTOR OPTIONS			
3'-3'	OCR Oracle Industrial Series with Reflector	3' FIXTURE 1-25-T8 (1 lamp/25W/T8) 2-25-T8 (2 lamps/25W/T8)	(Blank)- MVOLT (120/277) 120 277 347	(Blank)- 1 Ballast 2- 2 Ballasts	(Blank)- Normal BF HBF- High BF LBF- Low BF	Refer to page 291			

BALLAST CONFIGURATION & CODE	
25W/T8	DESCRIPTION
-	Electronic Instant Start
(Blank)	Electronic Program Start
-	Advance Mark-7 ¹
-	Advance Mark-10 ¹
-	Advance Optanium ¹
-	Advance Essential ¹
-	Advance Rover ¹
-	Lutron Ecosystem H-Series ¹
-	Lutron Tu-Wire ¹
LUT-EC5	Lutron Ecosystem ¹
LUT-EC3	Lutron Eco-10 ¹
-	Lutron Tve ¹
LUT-H3D	Lutron Hi-Lume 3D ¹
-	Lutron Ecosystem (347V Only) ¹

¹ - Voltage must be specified for dimming ballast.

² - Voltage must be specified for dimming ballast.

REMOTE EMERGENCY BATTERY PACK OPTIONS (L. = LUMENS)	
ORDER CODE	DESCRIPTION
EMG-T8-BX-450	Up to 450 L. for T8 or BX
EMG-T8-BX-600	Up to 600 L. for T8 or BX
EMG-T8-BX-700	Up to 700 L. for T8 or BX
EMG-T8-BX-1400	Up to 1400 L. for T8 or BX
EMG-T8-BX-T5-T5H0-3200	Up to 3200 L. for T8, BX, T5 or T5H0
EMG-SD-T8-BX-T5-T5H0-1400	Self-Diagnostic 1400 L. for T8, BX, T5 or T5H0
EMG-ICE-T8-BX-T5-T5H0-1400	ICE Pack 1400 L. for T8, BX, T5 or T5H0
GTD	Generator Transfer Device

WIRING OPTIONS	
C3	- 6' 3-wire Flex Cable (Single Circuit)
C4	- 6' 4-wire Flex Cable (Double Circuit)
FBF	- Internal Fast Blow Fuse
SBF	- Internal Slow-Blow Fuse
RIS	- Radio Interference Suppressor

OTHER OPTIONS	
OCRWG1	- Wireguard (Only available with SYM reflectors)
OCNRMS	- Motion Sensor
OCNRVH	- V Hook and Chain Kit
OCNRGSS	- Cable Gripper Suspension Kit
USA	- Made in America Compliance