

### T5 FLUORESCENT INDUSTRIAL STRIP W/ REFLECTOR (1 LAMP)

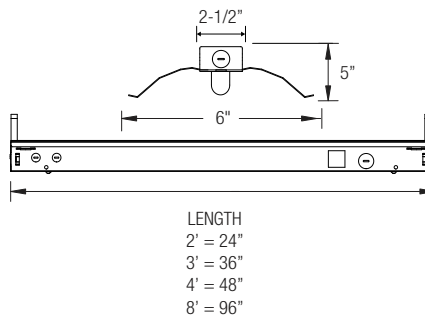
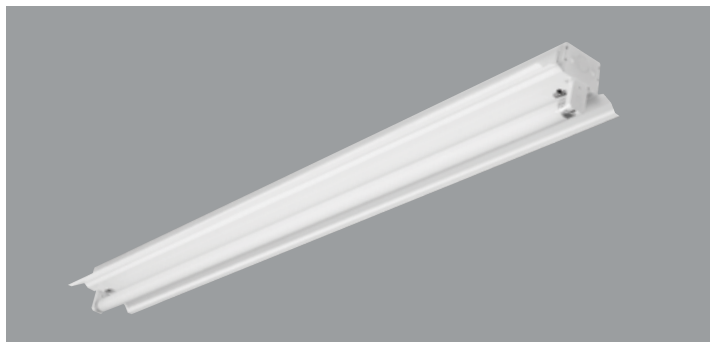

#### PRODUCT FEATURES:

- Heavy-duty 20-gauge steel utilized throughout for durability and code compliance
- Powder-coated painted for maximum operating life
- Pretreated with five-stage iron phosphate process to ensure superior paint adhesion
- Painted high-gloss baked white enamel
- Suitable for dry and damp environments
- Thermally protected, self-resetting, Class P, NPF, non-PCB and UL listed ballast
- Suitable for surface and/or suspended mounting
- Individual or continuous row mounting
- Standard reflector is manufactured in high reflectance white
- Reflector is secured to housing with 1/4 turn fasteners (ships separately)
- Reflector options:
  - Aluminium high reflectance white paint/slotted (20% uplight)
  - Aluminium specular silver/slotted (20% uplight)
  - Aluminium white asymmetrical reflector
  - Aluminium specular silver/asymmetrical reflector

**NOTE: All Aluminium Reflectors are special order (check with factory)**

- NEC required ballast disconnect is standard
- CEE qualified ballast comes standard on most fixture options (Consult factory for details)

#### LISTING

UL/C-UL listed to US and Canadian standard

#### WARRANTY

Guaranteed for one year against mechanical defects

T5  
OCNR

#### Ordering Information > Example: 3-OCNR-1-21-T5-MVOLT-EMG-T5-T5HO-700

3	OCNR								
FIXTURE SIZE	SERIES	WATTAGE	VOLTAGE <sup>1</sup>	# OF BALLAST	BALLAST FACTOR	REFLECTOR OPTIONS			
3- 3'	OCNR Oracle Industrial Series with Reflector	3' FIXTURE 1-21-T5 (1 lamp/21W/T5) 1-39-T5HO (1 lamp/39W/T5HO)	(Blank)- MVOLT (120/277) 120 277 347	(Blank)- 1 Ballast 2- 2 Ballasts	(Blank)- Normal BF HBF- High BF LBF- Low BF	Refer to page 291			
BALLAST CONFIGURATION & CODE									
21W/T5	39W/T5HO	DESCRIPTION							
-	-	Electronic Instant Start							
(Blank)	(Blank)	Electronic Program Start							
-	-	Advance Mark-7 <sup>1</sup>							
-	-	Advance Mark-10 <sup>1</sup>							
-	-	Advance Optanium <sup>1</sup>							
-	-	Advance Essential <sup>1</sup>							
-	-	Advance Rover <sup>1</sup>							
-	-	Lutron Ecosystem H-Series <sup>1</sup>							
-	-	Lutron Tu-Wire <sup>1</sup>							
LUT-EC5	LUT-EC5	Lutron Ecosystem <sup>1</sup>							
LUT-EC3	-	Lutron Eco-10 <sup>1</sup>							
-	-	Lutron Tve <sup>1</sup>							
LUT-H3D	LUT-H3D	Lutron Hi-Lume 3D <sup>1</sup>							
-	-	Lutron Ecosystem (347V Only) <sup>1</sup>							
REMOTE EMERGENCY BATTERY PACK OPTIONS (L. = LUMENS)									
ORDER CODE		DESCRIPTION							
EMG-T5-T5HO-700		Up to 700 L. for T5 or T5HO							
EMG-T5-T5HO-1300		Up to 1300 L. for T5 or T5HO							
EMG-T8-BX-T5-T5HO-3200		Up to 3200 L. for T8, BX, T5 or T5HO							
EMG-SD-T8-BX-T5-T5HO-1400		Self-Diagnostic 1400 L. for T8, BX, T5 or T5HO							
EMG-ICE-T8-BX-T5-T5HO-1400		ICE Pack 1400 L. for T8, BX, T5 or T5HO							
GTD		Generator Transfer Device							
WIRING OPTIONS									
C3		- 6' 3-wire Flex Cable (Single Circuit)							
C4		- 6' 4-wire Flex Cable (Double Circuit)							
FBF		- Internal Fast Blow Fuse							
SBF		- Internal Slow-Blow Fuse							
RIS		- Radio Interference Suppressor							
OTHER OPTIONS									
OCNRMS		- Motion Sensor							
OCNRVH		- V Hook and Chain Kit							
OCNRGSS		- Cable Gripper Suspension Kit							
USA		- Made in America Compliance							

1- Voltage must be specified for dimming ballast.

BALLAST CONFIGURATION & CODE		
21W/T5	39W/T5HO	DESCRIPTION
-	-	Electronic Instant Start
(Blank)	(Blank)	Electronic Program Start
-	-	Advance Mark-7 <sup>1</sup>
-	-	Advance Mark-10 <sup>1</sup>
-	-	Advance Optanium <sup>1</sup>
-	-	Advance Essential <sup>1</sup>
-	-	Advance Rover <sup>1</sup>
-	-	Lutron Ecosystem H-Series <sup>1</sup>
-	-	Lutron Tu-Wire <sup>1</sup>
LUT-EC5	LUT-EC5	Lutron Ecosystem <sup>1</sup>
LUT-EC3	-	Lutron Eco-10 <sup>1</sup>
-	-	Lutron Tve <sup>1</sup>
LUT-H3D	LUT-H3D	Lutron Hi-Lume 3D <sup>1</sup>
-	-	Lutron Ecosystem (347V Only) <sup>1</sup>

<sup>1</sup> - Voltage must be specified for dimming ballast.