



# 8" SCH8-LED



## Architectural LED Downlight

### RGB+Tunable White



#### SMART HUE - RGB + TUNABLE WHITE ARCHITECTURAL DOWNLIGHT

**SMART HUE** - Smart Hue by Maxilume is a Color Tuning Downlight across a tuning range of either 8000-1650 (RGBW-LTX-80K-16K) using Luminetix components or 6000-1650 (RGBW-LENGN-60K-16K) using LEDENGIN components. Light can be dimmed from 100-1% while maintaining constant CCT. Gradients of saturated colors from 1-100% can be added to color points within the tuning range. Smart Hue can change a spaces' atmosphere by manipulating the color temperature of the room. For instance, the temperature is warm at sunrise, cool at noon high, and warm again by sunset. With Smart Hue, you can mimic the daylight patterns in indoor space with electric light or gradients of saturated colors from 1-100% that can be added to color points within the tuning range. This creates a more contrasting environment, which is perceived to be more exciting to the brain and helps people to adjust their moods accordingly.

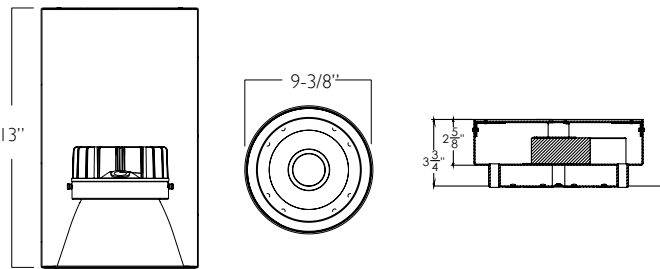

**DESCRIPTION:** 4" Round Tunable White LED New Construction Architectural Downlight. Available with Downlight, Wall Wash and Wet Location Trims.

**PERFORMANCE:** Operating system delivers 900, 1200, and 1500 lumens. All MAXILUME LED Tunable White Architectural Downlights maintain a CRI of 90+ across the tunable range of 6000K to 1650K and are binned to within 2 MacAdam ellipse. Elite's highly selective LED diodes produce zero ultraviolet and virtually no infrared light.

**OPTICS:** MAXILUME LED Optilux technology combines unmatched performance with visual comfort. Spun 0.05" thick 1-step self flanged white paper reflector. Reflector offers a 45-55 degree cutoff and comes standard with smooth frost Solite diffuser distributes that light even throughout the workplace in 3 different distribution; Wide (WD), Medium (MD) and Narrow (ND).

**THERMAL MANAGEMENT SYSTEM:** Proprietary coolLED Advanced Thermodynamic Design, Die-cast aluminum heat sink is attached to top of reflector. The LED light engine is attached to the die-cast heat sink and is easily replaceable and upgradeable.

**INSTALLATION TYPE: NEW CONSTRUCTION: MOUNTING BRACKET AND FRAME** - Constructed from 16 gauge steel and is supplied with C-channel that are adjustable up to 28". Mounting bracket maybe adjusted up to 2-3/4" vertically from inside the housing. Mounting frame is made from Die-formed construction for maximum heat dissipation and rust protection.

**LED DRIVER/JUNCTION BOX:** MAXILUME's LED driver is may be serviced from below the ceiling. UL Listed for through-branch circuit wiring, provided with four 1/2" KOs, one 3/4" KO and four Romex KOs with true pryout slots and strain clamps. Designed for straight through conduit runs. Available with Integral Emergency (INTG-LED-EMG) or remote mount (EMG-LED) push button.

#### DIMMING INFORMATION FOR MAXILUME SMART HUE DOWNLIGHT:

**ELDDALI-.1** (EldoLed DALI .1% Dimming driver options)

**ELDDMX-.1** (EldoLed DMX .1% Dimming driver options/ Consult Factory for Details)

**BLUETOOTH** On-board Bluetooth Low Energy (BLE)

# 8" SCH8-LED

## Trims



	TYPE	FINISH	CCT	LUMENS	DRIVER	VOLTAGE	OPTICS	EMERGENCY	TRIM TYPE	REFLECTOR/RING FINISH
SMART WHITE	SCH8-LED	<input type="checkbox"/> WH-WHITE <input type="checkbox"/> BK-BLACK <input type="checkbox"/> BZ- BRONZE <input type="checkbox"/> SI-SILVER	<input type="checkbox"/> RGBW-LTX-80K-16K	<input type="checkbox"/> 900L <input type="checkbox"/> 1200L <input type="checkbox"/> 1500L	<input type="checkbox"/> ELDODMX.1 <input type="checkbox"/> ELDODALI.1 <input type="checkbox"/> BLUETOOTH	<input type="checkbox"/> 120 <input type="checkbox"/> 277	<input type="checkbox"/> ND (Narrow) <input type="checkbox"/> MD (Medium) <input type="checkbox"/> WD (Wide)	<input type="checkbox"/> EMG-LED Typical lumen output of the fixture is up to 1000L in emergency mode. Contact the factory for details.	<input type="checkbox"/> HH8-8501 <input type="checkbox"/> HH8-8507 <input type="checkbox"/> HH8-8509 <input type="checkbox"/> HH8-8511 <input type="checkbox"/> HH8-8525 <input type="checkbox"/> HH8-8528 <input type="checkbox"/> HH8-8577	<input type="checkbox"/> CL-WH <input type="checkbox"/> CL-SCH <input type="checkbox"/> SHZ-SHZ <input type="checkbox"/> SHZ-WH <input type="checkbox"/> W-WH <input type="checkbox"/> MB-WH <input type="checkbox"/> WT-WH
			<input type="checkbox"/> RGBW-LENGN-60K-16K							



**EC-WC-RGBW-HW**  
RGB+WHITE RF Hard Wired Wall-Mount Controller and mobile app.



**EC-WC-RGBW-WL**  
ELITE-CONNECT RGB+WHITE RF Wireless Wall-Mount Controller

### Control Options for RGB + Tunable White with Smart Hue Technology

#### Control Options Provided by Others

DMX Driver- Controls provided by others.

#### Control Options Provided by Elite Lighting

ELITE-CONNECT RGB+WHITE RF Hard Wired Wall-Mount Controller and mobile app.  
 ELITE-CONNECT RGB+WHITE RF Wireless Wall-Mount Controller

1. 0-10V driver you must dedicate two control inputs, one for the Dimming Control and another for CCT Tunning.