



SAFETY INSTRUCTIONS

1. Do not use outdoors. 2. Equipment should be mounted securely in locations and at heights where it will not be readily subjected to tampering by unauthorized personnel. 3. Do not mount near gas or electric heaters. 4. Cap unused wires with enclosed wire nuts or other approved method. 5. Do not use this equipment for anything other than its intended use. 6. The use of accessory equipment not recommended by the manufacturer will void product listing and warranty and may cause an unsafe condition. 7. Use caution when servicing batteries. 8. Any service on this equipment should be performed by qualified personnel only. 9. Make sure wire terminations are secure and leads are properly tucked in appropriate wire channels. **CONSULT A QUALIFIED ELECTRICIAN BEFORE INSTALLING**



Caution:

Disconnect AC power before servicing and installation. All electrical connections must be in accordance with NEC/CEC or your local code.

INSTRUCTIONS STEPS

1.

Hold the adapter and insert it into the track bus. Rotate it 90 degrees. Make sure the 2 grooves in the adaptor align with the Polarity Groove.

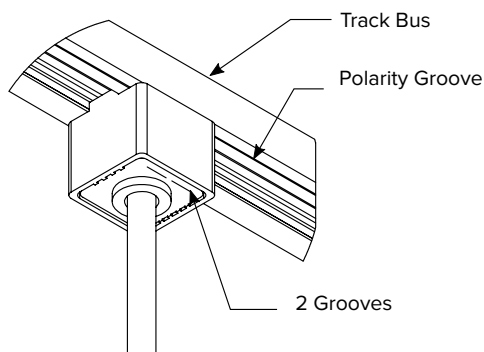

2.

Hold the adaptor of the track fixture and insert contact head into the bottom adapter of Extension Wand.

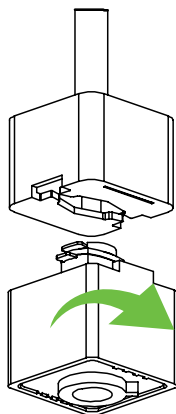

Caution:

Before twisting, make sure the Hot contact tab of adapter of track fixture is in the lower position.

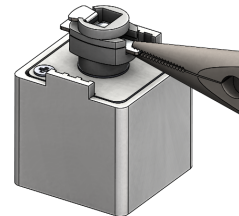

3.

Make sure Grounding contact of adapter will be on the same side of Polarity Line after installation of adapter of track fixture.

Caution:

Turning the adapter of track fixture in wrong direction will damage bottom of Extension Wand.

